

MAS 403 BT (IOS40)

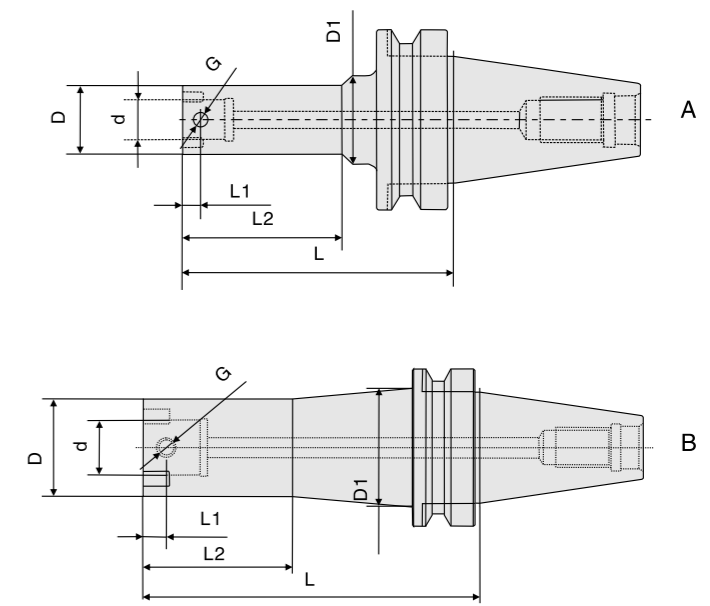

型號 Specification	圖 Figure	L	L1	L2	D	d	D1	G	重量 (kg) Weight
BT30-CKB1-80	A	80	5.05	46	19	11	31	M4×0.5	0.75
BT30-CKB2-80		80	6.65	46	24	14	31	M5×0.5	0.83
BT30-CKB3-80		80	8.05	58	31	18	31	M6×0.75	0.91
BT30-CKB4-80		80	10.05	58	39	22	39	M8×0.75	1.02
BT40-CKB1-75		75	5.05	36	19	11	31	M4×0.5	1.12
BT40-CKB1-105		105	5.05	66	19	11	31	M4×0.5	1.15
BT40-CKB2-80		80	6.65	49	24	14	31	M5×0.5	1.21
BT40-CKB2-115		115	6.65	79	24	14	31	M5×0.5	1.27
BT40-CKB3-95		95	8.05	68	31	18	31	M6×0.75	1.32
BT40-CKB3-125		B	125	8.05	80	31	18	37	M6×0.75
BT40-CKB3-155	155		8.05	85	31	18	37	M6×0.75	1.62
BT40-CKB4-95	A	95	10.05	68	39	22	39	M8×0.75	1.54
BT40-CKB4-125		125	10.05	98	39	22	39	M8×0.75	1.86
BT40-CKB4-155	B	155	10.05	90	39	22	46	M8×0.75	2.15
BT40-CKB5-95		A	95	13.05	68	49	28	49	M10×1
BT40-CKB5-125	125		13.05	98	49	28	49	M10×1	2.35
BT40-CKB5-155	155		13.05	128	49	28	49	M10×1	2.75
BT40-CKB6-65	A	65	16.05	38	63	36	63	M12×1	2.20
BT40-CKB6-95		95	16.05	68	63	36	63	M12×1	2.75
BT40-CKB6-125		125	16.05	98	63	36	63	M12×1	3.20

型號說明

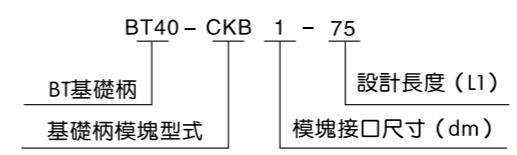

- U 鑽系列 High speed drills Indexable inserts
- 鏢刀系列 Boring Head
- 刀柄系列 Chuck
- 銑刀系列 Milling System
- 頂尖系列 Centre
- 車刀系列 Turning Tools
- 合金系列 Carbide insert
- 非標定做 Customized Products

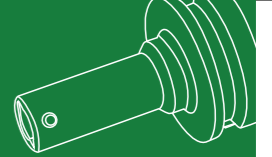

U 鑽系列 high speed drills
鏢刀系列 Boring Head
刀柄系列 Chuck
銑刀系列 Milling System
頂尖系列 Centre
車刀系列 Turning Tools
合金系列 Carbide insert
非標定做 Customized Products

U 鑽系列 high speed drills
鏢刀系列 Boring Head
刀柄系列 Chuck
銑刀系列 Milling System
頂尖系列 Centre
車刀系列 Turning Tools
合金系列 Carbide insert
非標定做 Customized Products

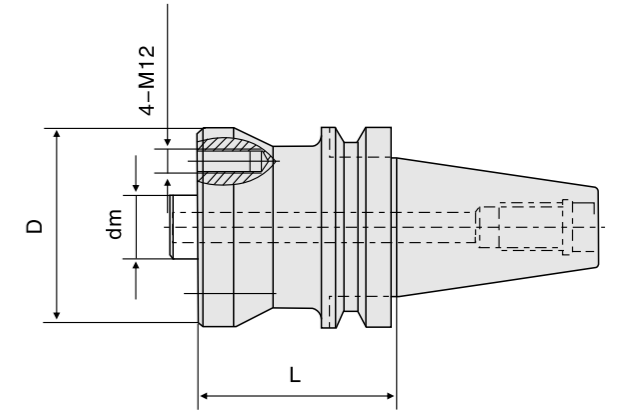
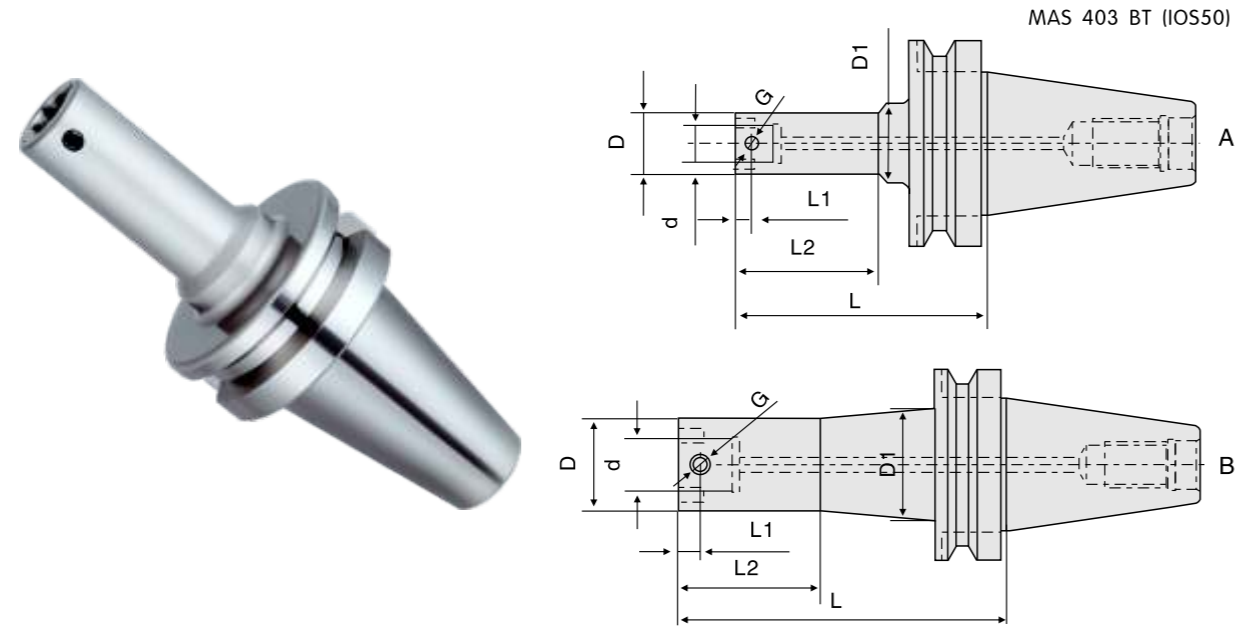

型號 Specification	圖 Figure	L	L1	L2	D	d	D1	G	重量 (kg) Weight
BT50-CKB1-100	A	100	5.05	62	19	11	31	M4×0.5	3.93
BT50-CKB1-140	B	140	5.05	62	19	11	27	M4×0.5	4.16
BT50-CKB2-110	A	110	6.65	72	24	14	31	M5×0.5	4.08
BT50-CKB2-140	B	140	6.65	75	24	14	35	M5×0.5	4.32
BT50-CKB3-125	A	125	8.05	87	31	18	31	M6×0.75	4.26
BT50-CKB3-155	B	155	8.05	80	31	18	37	M6×0.75	4.39
BT50-CKB3-175		175	8.05	90	31	18	37	M6×0.75	4.61
BT50-CKB4-125	A	125	10.05	87	39	22	39	M8×0.75	4.63
BT50-CKB4-155	B	155	10.05	85	39	22	45	M8×0.75	4.83
BT50-CKB4-185		185	10.05	95	39	22	48	M8×0.75	5.02
BT50-CKB5-125	A	125	13.05	87	49	28	49	M10×1	4.75
BT50-CKB5-165	B	165	13.05	95	49	28	58	M10×1	5.20
BT50-CKB5-205		205	13.05	110	49	28	58	M10×1	5.53
BT50-CKB6-95	A	95	16.05	57	63	36	63	M12×1	4.95
BT50-CKB6-165		165	16.05	127	63	36	63	M12×1	6.10
BT50-CKB6-235		235	16.05	130	63	36	73	M12×1	6.83

型號說明



型號 Specification	L	D	d	G	重量 (kg) Weight
BT40-DM32-60	60	100	32	4-M12	2.42
BT50-DM32-100	100	100	32	4-M12	6.3
BT50-DM32-150	150	100	32	4-M12	9.2
BT50-DM32-200	200	100	32	4-M12	11.1
BT50-DM32-250	250	100	32	4-M12	12.9
BT50-DM32-300	300	100	32	4-M12	14.8



TRP Round Dowel End Mill

TRP圓鼻立銑刀

YOUNISO



- ◎適配多種經濟型刀片，性價比高
- ◎Fit a variety of economic-type blade, cost-effective

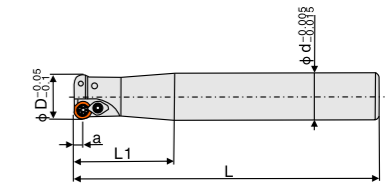

型號 Specification	刃數 No. of flutes	尺寸 Size					刀片 Insert	壓板 Clamp piece	螺釘 Clamp screw	扳手 wrench
		D	d	L	L1	a				
TRP-C12-4R12-120	1	12	12	120	40	4	RPMW/T08T2MO	Y-4R	M3×7	T10
TRP-C12-4R13-120	1	13	12	120	40	4				
TRP-C16-4R16-120	2	16	16	120	40	4				
TRP-C16-4R16-160	2	16	16	160	40	4				
TRP-C15.6-4R16-160	2	16	15.6	160	40	4				
TRP-C16-4R16-200	2	16	16	200	40	4				
TRP-C15.6-4R16-200	2	16	15.6	200	50	4				
TRP-C16-4R17-160	2	17	16	160	40	4				
TRP-C16-4R17-200	2	17	16	200	50	4				
TRP-C20-4R20-160	2	20	20	160	50	4				
TRP-C19-4R20-160	2	20	19	160	50	4				
TRP-C20-4R20-200	2	20	20	200	50	4				
TRP-C19-4R20-200	2	20	19	200	50	4				
TRP-C20-4R21-160	2	21	20	160	50	4				
TRP-C20-4R21-200	2	21	20	200	50	4				
TRP-C20-5R20-160	2	20	20	160	50	5				
TRP-C20-5R20-200	2	20	20	200	50	5				
TRP-C20-5R21-160	2	21	20	160	50	5				
TRP-C20-5R21-200	2	21	20	200	50	5				
TRP-C25-5R25-160	2	25	25	160	50	5	RPMW/T08T2MO	Y-4R	M3×7	T10
TRP-C20-5R25-160	2	25	20	160	50	5				
TRP-C24-5R25-160	2	25	24	160	50	5				
TRP-C25-5R25-200	2	25	25	200	75	5				
TRP-C25-5R25-250	2	25	25	250	60	5				
TRP-C20-5R25-200	2	25	20	200	50	5				
TRP-C24-5R25-200	2	25	24	200	50	5				
TRP-C24-5R25-250	2	25	24	250	50	5				
TRP-C25-5R26-160	2	26	25	160	50	5				
TRP-C25-5R26-200	2	26	25	200	50	5				
TRP-C25-5R26-250	2	26	25	250	50	5	RPMT/W10T3MOE	Y-5R	M4×10	T15
TRP-C20-5R30-120	2	30	20	120	40	5				
TRP-C25-5R30-160	2	30	25	160	50	5				
TRP-C25-5R30-200	2	30	25	200	50	5				
TRP-C25-5R30-250	2	30	25	250	60	5				
TRP-C25-5R30-300	2	30	25	300	60	5				
TRP-C32-5R30-300	2	30	32	300	60	5				
TRP-C32-5R35-160	2/3	35	32	160	50	5				
TRP-C32-5R35-200	2/3	35	32	200	50	5				
TRP-C32-5R35-250	2/3	35	32	250	60	5				
TRP-C32-5R35-300	3	35	32	300	60	5				
TRP-C32-5R35-350	3	35	32	350	60	5				
TRP-C32-5R35-400	3	35	32	400	60	5				
TRP-C32-5R40-160	4	40	32	160	50	5				
TRP-C32-5R40-200	4	40	32	200	50	5				
TRP-C32-5R40-250	4	40	32	250	60	5				
TRP-C32-5R40-300	4	40	32	300	60	5				
TRP-C32-5R40-350	4	40	32	350	60	5				

U 鑽系列
High speed drills
Indexable inserts

鏜刀系列
Boring Head

刀柄系列
Chuck

銑刀系列
Milling System

頂尖系列
Centre

車刀系列
Turning Tools

合金系列
Carbide insert

非標定做
Customized Products

EMR Round dowel end mill EMR圓鼻立銑刀



EMR Round dowel end mill EMR圓鼻立銑刀



U 鑽系列
High speed drills
Indexable inserts

鏜刀系列
Boring Head

刀柄系列
Chuck

銑刀系列
Milling System

頂尖系列
Centre

車刀系列
Turning Tools

合金系列
Carbide insert

非標定做
Customized Products



- ◎刀片經濟，適用性好
- ◎容屑空間大，排屑好
- ◎Blade economy, the high applicability.
- ◎Capacity chip a large space, good chip removal.

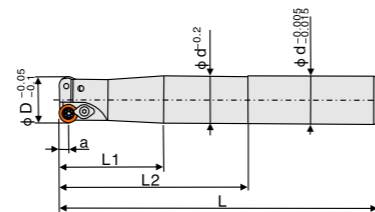

型號 Specification	刃數 No. of flutes	尺寸 Size					刀片 Insert	壓板 Clamp piece	螺釘 Clamp screw	扳手 wrench
		D	d	L	L1	a				
EMR-C25-6R32-160	2	32	25	160	50	6	RPMW/T1204	Y-6R	M4 × 10	T15
EMR-C32-6R32-160	2	32	32	160	50	6				
EMR-C25-6R32-200	2	32	25	200	50	6				
EMR-C32-6R32-200	2	32	32	200	80	6				
EMR-C25-6R32-250	2	32	25	250	60	6				
EMR-C32-6R32-250	2	32	32	250	100	6				
EMR-C32-6R35-160	3	35	32	160	50	6				
EMR-C32-6R35-200	3	35	32	200	50	6				
EMR-C32-6R35-250	3	35	32	250	60	6				
EMR-C32-6R35-300	3	35	32	300	60	6				
EMR-C32-6R35-350	3	35	32	350	60	6				
EMR-C32-6R35-400	3	35	32	400	60	6				
EMR-C32-6R40-160	3	40	32	160	50	6				
EMR-C32-6R40-200	3	40	32	200	50	6				
EMR-C32-6R40-250	3	40	32	250	60	6				
EMR-C32-6R40-300	3	40	32	300	60	6				
EMR-C32-6R40-350	3	40	32	350	60	6				
EMR-C32-6R50-200	4	50	32	200	60	6				
EMR-C32-6R50-250	4	50	32	250	60	6				

R200 Round dowel end mill R200圓鼻立銑刀

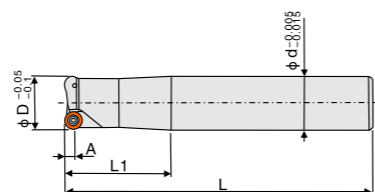

型號 Cat.No	刃數 No. of flutes	尺寸 Size					刀片 Insert	螺釘 Clamp screw	扳手 wrench
		D	d	L	L1	a			
R200-C20-5R25-160	2	25	20	160	-	5	RC□T 10T3 MO	M3.5 × 8.5	T15
R200-C24-5R25-160	2	25	24	160	-	5			
R200-C25-5R25-200	2	25	25	200	75	5			
R200-C24-5R25-200	2	25	24	200	-	5			
R200-C25-6R32-160	2	32	25	160	-	6			
R200-C25-6R32-200	2	32	25	200	-	6	RC□T 1204 MO	M3.5 × 10	T15
R200-C25-6R32-250	2	32	25	250	-	6			

U 鑽系列
High speed drills
Indexable inserts

鏜刀系列
Boring Head

刀柄系列
Chuck

銑刀系列
Milling System

頂尖系列
Centre

車刀系列
Turning Tools

合金系列
Carbide insert

非標定做
Customized Products



- ◎適配多種經濟型刀片，性價比高
- ◎Fit a variety of economic-type blade, cost-effective

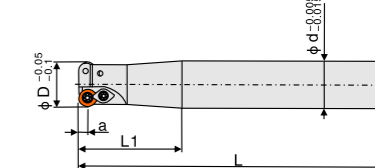

型號 Specification	刃數 No. of flutes	尺寸 Size					刀片 Insert	壓板 Clamp piece	螺釘 Clamp screw	扳手 wrench				
		D	d	L	L1	a								
EMR-C12-4R12-120	1	12	12	120	40	4	RPMW/T0802MO	Y-4R	M3×7	T10				
EMR-C12-4R13-120	1	13	12	120	40	4								
EMR-C16-4R16-120	2	16	16	120	40	4								
EMR-C16-4R16-160	2	16	16	160	40	4	RPMW/T0802MO	Y-4R	M3×7	T10				
EMR-C15.6-4R16-160	2	16	15.6	160	40	4								
EMR-C16-4R16-200	2	16	16	200	40	4								
EMR-C15.6-4R16-200	2	16	15.6	200	50	4								
EMR-C16-4R17-160	2	17	16	160	40	4								
EMR-C16-4R17-200	2	17	16	200	50	4								
EMR-C20-4R20-160	2	20	20	160	50	4								
EMR-C19-4R20-160	2	20	19	160	50	4								
EMR-C20-4R20-200	2	20	20	200	50	4								
EMR-C19-4R20-200	2	20	19	200	50	4								
EMR-C20-4R21-160	2	21	20	160	50	4								
EMR-C20-4R21-200	2	21	20	200	50	4								
EMR-C20-5R20-160	2	20	20	160	50	5	RPMW/T0802MO	Y-4R	M3×7	T10				
EMR-C20-5R20-200	2	20	20	200	50	5								
EMR-C20-5R21-160	2	21	20	160	50	5								
EMR-C20-5R21-200	2	21	20	200	50	5								
EMR-C25-5R25-160	2	25	25	160	50	5								
EMR-C20-5R25-160	2	25	20	160	50	5								
EMR-C24-5R25-160	2	25	24	160	50	5								
EMR-C25-5R25-200	2	25	25	200	75	5								
EMR-C25-5R25-250	2	25	25	250	60	5								
EMR-C20-5R25-200	2	25	20	200	50	5								
EMR-C24-5R25-200	2	25	24	200	50	5								
EMR-C24-5R25-250	2	25	24	250	50	5								
EMR-C25-5R26-160	2	26	25	160	50	5								
EMR-C25-5R26-200	2	26	25	200	50	5								
EMR-C25-5R26-250	2	26	25	250	50	5								
EMR-C20-5R30-120	2	30	20	120	40	5					RPMW/W1003MOE	Y-5R	M4 × 10	T15
EMR-C25-5R30-160	2	30	25	160	50	5								
EMR-C25-5R30-200	2	30	25	200	50	5								
EMR-C25-5R30-250	2	30	25	250	60	5								
EMR-C25-5R30-300	2	30	25	300	60	5								
EMR-C32-5R30-300	2	30	32	300	60	5								
EMR-C32-5R35-160	2	35	32	160	50	5								
EMR-C32-5R35-200	2	35	32	200	50	5								
EMR-C32-5R35-250	2	35	32	250	60	5								
EMR-C32-5R35-300	2/3	35	32	300	60	5								
EMR-C32-5R35-350	2/3	35	32	350	60	5								
EMR-C32-5R35-400	2/3	35	32	400	60	5								
EMR-C32-5R40-160	4	40	32	160	50	5								
EMR-C32-5R40-200	4	40	32	200	50	5								
EMR-C32-5R40-250	4	40	32	250	60	5								
EMR-C32-5R40-300	4	40	32	300	60	5								
EMR-C32-5R40-350	4	40	32	350	60	5								

TAP right angle shoulder end mill TAP直角臺肩銑刀



TSE-45° face mill TSE-45° 面銑刀盤



U 鑽系列
high speed drills
Indexable inserts

鏜刀系列
Boring Head

刀柄系列
Chuck

銑刀系列
Milling System

頂尖系列
Centre

車刀系列
Turning Tools

合金系列
Carbide insert

非標定做
Customized Products



- 適合強力切削，回轉及進刀量是一般銑刀的3倍。
- 適合刀片經濟，性價比高
- Suitable for heavy cutting, rotary and feed volumes 3 times the normal cutter.
- Adapter blade economy, cost-effective.

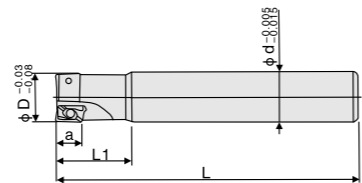

型號 Specification	刃數 No. of flutes	尺寸 Size					刀片 Insert	螺釘 Clamp screw	扳手 wrench
		D	d	L	L1	a			
TAP300R-C10-10-100	1	10	10	100	30	9	APMT 1135 PDER	M2.5 × 6	T8
TAP300R-C10-11-100	1	11	10	100	30	9			
TAP300R-C12-12-120	1	12	12	120	30	9			
TAP300R-C12-13-120	1	13	12	120	30	9			
TAP300R-C16-16-120	2	16	16	120	40	9			
TAP300R-C16-16-160	2	16	16	160	40	9			
TAP300R-C16-16-200	2	16	16	200	40	9			
TAP300R-C15.6-16-160	2	16	15.6	160	40	9			
TAP300R-C16-17-160	2	17	16	160	40	9			
TAP300R-C16-17-200	2	17	16	200	40	9			
TAP300R-C20-20-120	2	20	20	120	40	9	APMT 1135 PDER	M2.5 × 6	T8
TAP300R-C20-20-160	2	20	20	160	50	9			
TAP300R-C19-20-160	2	20	19	160	50	9			
TAP300R-C20-20-200	2	20	20	200	50	9			
TAP300R-C19-20-200	2	20	19	200	50	9			
TAP300R-C20-21-160	2	21	20	160	50	9			
TAP300R-C20-21-200	2	21	20	200	50	9			
TAP300R-C25-25-120	3	25	25	120	50	9			
TAP300R-C25-25-160	3	25	25	160	50	9			
TAP300R-C25-25-200	3	25	25	200	50	9			
TAP400R-C25-25-160	2	25	25	160	50	14	APMT 1604 PDER	M4 × 10	T15
TAP400R-C24-25-160	2	25	24	160	40	14			
TAP400R-C25-25-200	2	25	25	200	75	14			
TAP400R-C24-25-200	2	25	24	200	50	14			
TAP400R-C25-25-250	2	25	25	250	50	14			
TAP400R-C25-26-160	2	26	25	160	40	14			
TAP400R-C25-26-200	2	26	25	200	50	14			
TAP400R-C25-26-250	2	26	25	250	50	14			
TAP400R-C32-32-160	2	32	32	160	50	14			
TAP400R-C32-32-200	2	32	32	200	80	14			
TAP400R-C32-32-250	2	32	32	250	60	14			
TAP400R-C32-32-300	2	32	32	300	60	14			
TAP400R-C32-35-160	3	35	32	160	60	14			
TAP400R-C32-35-200	3	35	32	200	60	14			
TAP400R-C32-35-250	3	35	32	250	60	14			
TAP400R-C32-35-300	3	35	32	300	60	14			
TAP400R-C32-35-350	3	35	32	350	60	14			
TAP400R-C32-35-400	3	35	32	400	60	14			
TAP400R-C32-40-200	3	40	32	200	60	14			
TAP400R-C32-40-250	3	40	32	250	60	14			
TAP400R-C32-40-300	3	40	32	300	60	14			
TAP400R-C32-40-350	3	40	32	350	60	14			
TAP400R-C32-40-400	3	40	32	400	60	14			

U 鑽系列
high speed drills
Indexable inserts

鏜刀系列
Boring Head

刀柄系列
Chuck

銑刀系列
Milling System

頂尖系列
Centre

車刀系列
Turning Tools

合金系列
Carbide insert

非標定做
Customized Products

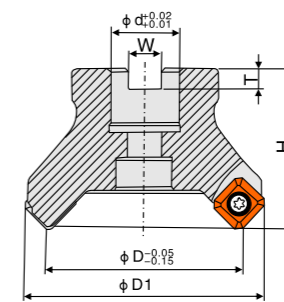

- 適合鋼件、鑄件、鋁件多種材質刀片，適切範圍廣
- 容屑空間大，排屑好
- 可適用平面銑削的粗加工
- 大前角，切削負荷小
- Fit steel, castings, aluminum pieces of various materials blade, the relevance of a wide range of
- Capacity chip a large space, good chip disposal
- Planar milling finishing applicable
- Large rake angle, cutting a small load

型號 Specification	尺寸 Size						刀片 Insert	螺釘 Clamp screw	扳手 wrench
	D	D1	d	H	W	T			
TSE12-50-22-4T	50	64	22	50	10.4	6.3	SE□T 1204	M5 × 12	T20
TSE12-63-22-4T	63	77	22	50	10.4	6.3			
TSE12-80-27-5T	80	94	27	50	12.4	7			
TSE12-100-32-5T	100	114	32	50	14.4	8			
TSE12-125-40-6T	125	139	40	63	16.4	9			
TSE12-160-40-6T	160	174	40	63	16.4	9			
TSE12-200-60-8T	200	210	60	63	25.7	14			
TSE12-250-60-10T	250	260	60	63	25.7	14			
TSE12-63-25.4-4T	63	77	25.4	50	10	6			
TSE12-80-25.4-5T	80	94	25.4	50	10	6			
TSE12-100-31.75-5T	100	114	31.75	50	13	8			

TRS Round dowel face mill TRS圓鼻面銑刀盤

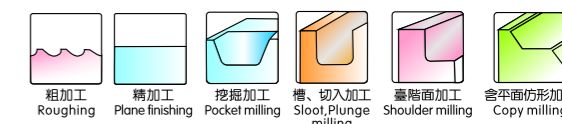
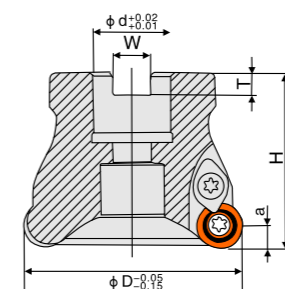

- 使用15° 正角刀片
- 刀片經濟，適用性高
- 容屑空間大，排屑好
- 錐形設計，鋼性高
- Using the 15° positive angle blade
- Blade economy, the applicability of high
- Capacity chip a large space, good chip disposal
- Cone design, steel high

型號 Specification	尺寸 Size						刀片 Insert	壓板 Clamp piece	螺釘 Clamp screw	扳手 wrench
	D	d	H	W	T	a				
TRS-5R-50-22-4T	50	22	50	10.4	6.3	5	RD□□ 10T3 MO	Y-5R	M4 × 10/M3.5 × 10	T15
TRS-5R-63-22-4T	63	22	50	10.4	6.3	5				
TRS-5R-80-27-6T	80	27	50	12.4	7	5				
TRS-5R-100-32-6T	100	32	50	14.4	8	5	RD□□ 1204 MO	Y-6R	M4 × 10	T15
TRS-6R-50-22-4T	50	22	50	10.4	6.3	6				
TRS-6R-63-22-4T	63	22	50	10.4	6.3	6				
TRS-6R-80-27-6T	80	27	50	12.4	7	6				
TRS-6R-100-32-6T	100	32	50	14.4	8	6				
TRS-8R-63-22-4T	63	22	50	10.4	6.3	8				
TRS-8R-80-27-5T	80	27	50	12.4	7	8	RD□□ 1604MO	Y-8R	M5 × 12	T20
TRS-8R-100-32-6T	100	32	50	14.4	8	8				

R200 Round dowel face mill R200圓鼻面銑刀盤



TAP Right angle shoulder face mill TAP直角臺肩面銑刀盤



U 鑽系列
high speed drills
Indexable inserts

鏜刀系列
Boring Head

刀柄系列
Chuck

銑刀系列
Milling System

頂尖系列
Centre

車刀系列
Turning Tools

合金系列
Carbide insert

非標定做
Customized Products

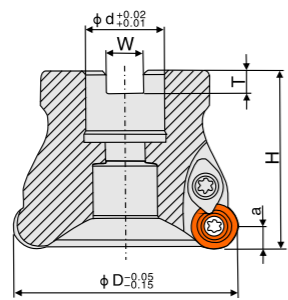

- ◎適配山特維克精磨刀片
- ◎精度高，適于精加工
- ◎錐形設計，鋼性高
- ◎Adapter grinding blade Sandvik
- ◎High precision, suitable for finishing
- ◎Cone design, steel high

型號 Specification	尺寸 Size						刀片 Insert	壓板 Clamp piece	螺釘 Clamp screw	扳手 wrench
	D	d	H	W	T	a				
R200-5R-50-22-4T	50	22	50	10.4	6.3	5	RC□T 10T3 MO	Y-6R	M4 × 10 M3.5 × 10	T15
R200-5R-63-22-4T	63	22	50	10.4	6.3	5				
R200-5R-80-27-6T	80	27	50	12.4	7	5				
R200-5R-100-32-6T	100	32	50	14.4	8	5	RC□T 1204 MO	Y-6R	M4 × 10 M3.5 × 10	T15
R200-6R-50-22-4T	50	22	50	10.4	6.3	6				
R200-6R-63-22-4T	63	22	50	10.4	6.3	6				
R200-6R-80-27-6T	80	27	50	12.4	7	6	RC□T 1606 MO	Y-8R	M5 × 12	T20
R200-6R-100-32-6T	100	32	50	14.4	8	6				
R200-8R-63-22-4T	63	22	50	10.4	6.3	8				
R200-8R-80-27-5T	80	27	50	12.4	7	8	RC□T 1606 MO	Y-8R	M5 × 12	T20
R200-8R-100-32-6T	100	32	50	14.4	8	8				
R200-8R-125-40-6T	125	40	63	16.4	9	8				
R200-8R-160-40-8T	160	40	63	16.4	9	8	RC□T 1606 MO	Y-8R	M5 × 12	T20
R200-8R-200-60-9T	200	60	63	25.7	14	8				
R200-10R-100-32-5T	100	32	63	14.4	8	10				
R200-10R-125-40-6T	125	40	63	16.4	9	10	RC□T 1606 MO	Y-8R	M5 × 12	T20

SE90° Face mill SE90° 面銑刀盤

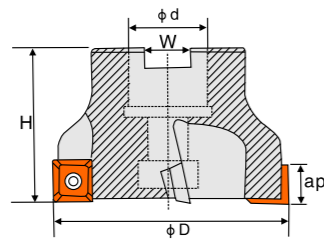

- ◎使用20° 正角刀片
- ◎低切削力，大前角，切削輕快
- ◎高生產率，高精度
- ◎Using the 20° positive angle blade
- ◎Low cutting force, large rake angle, cutting light
- ◎High productivity, high-precision

型號 Specification	尺寸 Size				刀片 Insert	壓板 Clamp piece	螺釘 Clamp screw	扳手 wrench
	D	d	H	W				
SE-50-22-4T	50	22	50	10.4	SE□T09T308	--	M3 × 8	T8
SE-63-22-5T	63	22	50	10.4				
SE-80-27-6T	80	27	50	12.4	SE□T09T308	--	M3 × 8	T8
SE-100-32-8T	100	32	50	14.4				

U 鑽系列
high speed drills
Indexable inserts

鏜刀系列
Boring Head

刀柄系列
Chuck

銑刀系列
Milling System

頂尖系列
Centre

車刀系列
Turning Tools

合金系列
Carbide insert

非標定做
Customized Products

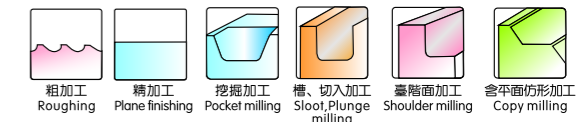
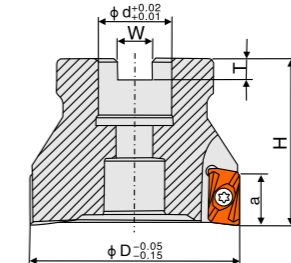

- ◎11° 正角刀片
- ◎適配多種材質刀片，可適用鋁、鋼銑削
- ◎螺絲鎖緊，容屑空間大，排屑好
- ◎切削輕快，阻力小
- ◎11° Positive angle blade
- ◎Adaptive multi-material blade, applicable to aluminum steel milling
- ◎Screw locking, allow a large space debris, a good chip disposal
- ◎Cutting light, the resistance of small

型號 Specification	尺寸 Size						刀片 Insert	螺釘 Clamp screw	扳手 wrench
	D	d	H	W	T	a			
TAP300R-40-16-5T	40	16	40	8.4	6.3	9	APMT 1135 PDER	M2.5 × 6.5	T8
TAP300R-50-22-6T	50	22	50	10.4	6.3	9			
TAP400R-50-22-4T	50	22	50	10.4	6.3	14			
TAP400R-63-22-4T	63	22	50	10.4	6.3	14	APMT 1604 PDER	M4 × 10	T15
TAP400R-80-27-6T	80	27	50	12.4	7	14			
TAP400R-100-32-6T	100	32	50	14.4	8	14			
TAP400R-125-40-7T/8T	125	40	63	16.4	9	14			
TAP400R-160-40-8T	160	40	63	16.4	9	14			
TAP400R-200-60-9T	200	60	63	25.7	14	14			
TAP400R-63-25.4-4T	63	25.4	50	10	6	14			
TAP400R-80-25.4-6T	80	25.4	50	10	6	14			
TAP400R-100-31.75-6T	100	31.75	50	13	8	14			
TAP400R-125-38.1-8T	125	38.1	63	16.4	10	14			

RAP-75° Face mill RAP-75° 面銑刀盤

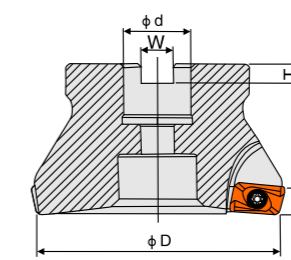
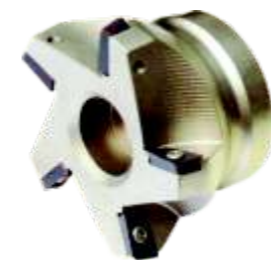

- ◎使用APMT1604/APMT1135廢棄刀片，節約成本
- ◎Abandoned the use of APMT1604/APMT1135 blade, cost savings

型號 Specification	尺寸 Size						刀片 Insert	螺釘 Clamp screw	扳手 wrench
	D	d	H	W	T	a			
RAP300R-50-22-4T	50	22	50	10.4	6.3	6	APMT 1135PDER	M2.5 × 6.5	T8
RAP400R-63-22-4T	63	22	50	10.4	6.3	8			
RAP400R-80-27-5T	80	27	50	12.4	7	8	APMT1604 PDER	M4 × 10	T15
RAP400R-100-32-6T	100	32	50	14.4	8	8			

EMR Round dowel face mill EMR圓鼻面銑刀盤

YOUN/O

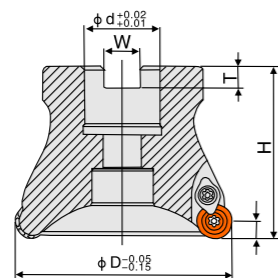

- 使用11° 正角刀片
- 刀片經濟，適用性高
- 容屑空間大，排屑好
- 錐形設計，鋼性高
- Using the 11° Positive angle blade
- Blade economy, the applicability of high
- Capacity chip a large space, good chip disposal
- Cone design, steel high

型號 Specification	尺寸 Size						刀片 Insert	壓板 Clamp piece	螺釘 Clamp screw	扳手 wrench
	D	d	H	W	T	a				
EMR-5R-50-22-4T	50	22	50	10.4	6.3	5	RPMW/T 1003 MO	Y-5R	M4 x 10/M3.5 x 10	T15
EMR-5R-63-22-4T	63	22	50	10.4	6.3	5				
EMR-5R-80-27-6T	80	27	50	12.4	7	5				
EMR-5R-100-32-6T	100	32	50	14.4	7	5				
EMR-5R-125-40-7T	125	40	63	16.4	9	5				
EMR-6R-50-22-4T	50	22	50	10.4	6.3	6				
EMR-6R-63-22-4T	63	22	50	10.4	6.3	6	RPMW/T 1204 MO	Y-6R	M4 x 10	T15
EMR-6R-80-27-6T	80	27	50	12.4	7	6				
EMR-6R-100-32-6T	100	32	50	14.4	8	6				
EMR-6R-125-40-7T	125	40	63	16.4	9	6				
EMR-6R-160-40-8T	160	40	63	16.4	9	6				
EMR-6R-200-60-9T	200	60	63	25.7	14	6				

TRP Round dowel face mill TRP圓鼻面銑刀盤

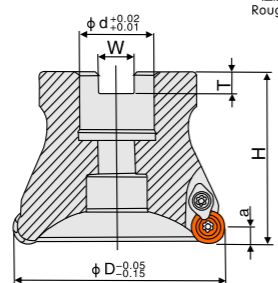

- 使用11° 正角刀片
- 刀片經濟，適用性高
- 容屑空間大，排屑好
- 錐形設計，鋼性高
- Using the 11° Positive angle blade
- Blade economy, the applicability of high
- Capacity chip a large space, good chip disposal
- Cone design, steel high

型號 Specification	尺寸 Size						刀片 Insert	壓板 Clamp piece	螺釘 Clamp screw	扳手 wrench
	D	d	H	W	T	a				
TRP-5R-50-22-4T	50	22	50	10.4	6.3	5	RPMW/T 10T3 MOE	Y-5R	M3.5 x 10	T15
TRP-5R-63-22-4T	63	22	50	10.4	6.3	5				
TRP-5R-80-27-6T	80	27	50	12.4	7	5				
TRP-5R-100-32-6T	100	32	50	12.4	7	5	RPMW/T 10T3 MOE	Y-5R	M3.5 x 10	T15
TRP-5R-125-40-7T	125	40	63	12.4	9	5				

Asc milling chuck 強力銑刀柄

YOUN/O

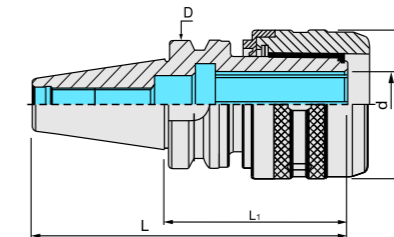

特點Features

- 此款刀杆內孔分割6槽以防止滑動并加大夾持力。
- 此採用兩綫裝置為使當滑動至針錐面時滾動摩擦及脫落減至最小。
- In that case end mill shank or collet have oil or chips, divide the slitting into six in order to prevent slipping and to grip exactly.
- It adopts two line arrangement in order to minimize orlling friction and to slip during slide by taper side.

型號/規格 Model	D	D1	L	L1	d	筒夾名稱 Collet name
BT30-C32-95	46	68	143.4	95	32	C32
BT40-C32-105	63	68	170.4	105	32	
BT40-C32-165	63	68	230.4	165	32	
BT50-C32-110	100	68	211.8	110	32	
BT50-C42-135	100	82	236.8	135	42	C42

ER collet chuck-BT30/BT40/50 BT銑刀柄

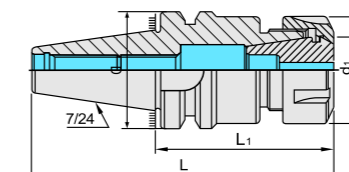

特點Features

- 筒夾樣式有彈性、止水、剛性攻牙、伸縮攻牙、極小內孔、燒結式熱膨脹可供選擇。
- 彈性筒夾偏擺精度有標準級(0.02mm以內)，A級(0.01mm以內)，UP (0.005mm以內)。
- 螺帽預設動平衡設計，可在RPM10,000下使用。
- 整支通孔，利於出水及抗震。
- 如需擋刀螺絲可加外指定。
- 裝置時筒夾必須先置入螺帽，再裝入刀具，接着鎖固入本體。
- 刀具置入筒夾內孔，必需超出夾內孔有效夾持長度，避免不當鎖固，造成損壞。
- 務必使用正確扳手來裝置不可任意改變，避免不當鎖固，造成損壞。
- The ER collet has three kinds of classes for precision : general class 0.02mm, A class 0.01mm, and UP class 0.005mm.
- When using, please put the collet into the nut and then put them into the body together.
- The tool holder is through-hole, which is better for water to get through and anti-vibrant.

型號/規格 Model	攻牙範圍 Gripl range	D	d	d1	L	L1	筒夾名稱 Collet name
BT30-ER11-60/100	0.5-7	46	19	11	108.4/148.4	60/100	ER11
BT30-ER16-60/100	1-10	46	28	16	108.4/148.4	60/100	ER16
BT30-ER20-60/100	1-13	46	34	20	108.4/148.4	60/100	ER20
BT30-ER25-60/100	1-16	46	42	25	108.4/148.4	60/100	ER25
BT30-ER32-60/100	1-20	46	50	32	108.4/148.4	60/100	ER32
BT40-ER11-70/100/150	0.5-7	63	19	11	135.4/165.4	70/100/150	ER11
BT40-ER16-70/100/150	1-10	63	28	16	135.4/165.4	70/100/150	ER16
BT40-ER20-70/100/150	1-13	63	34	20	135.4/165.4	70/100/150	ER20
BT40-ER25-70/100/150	1-16	63	42	25	135.4/165.4	70/100/150	ER25
BT40-ER32-70/100/150	1-20	63	50	32	135.4/165.4	70/100/150	ER32
BT40-ER40-80/100/150	1-25	63	63	40	201.8/251.8	80/100/150	ER40
BT50-ER16-100/150/200	1-10	100	28	16	201.8/251.8	100/150/200	ER16
BT50-ER20-100/150/200	1-13	100	34	20	201.8/251.8	100/150/200	ER20
BT50-ER25-100/150/200	1-16	100	42	25	201.8/251.8	100/150/200	ER25
BT50-ER32-100/150/200	1-20	100	50	32	201.8/251.8	100/150/200	ER32
BT50-ER40-100/150/200	1-25	100	63	40	201.8/251.8	100/150/200	ER40

Face mill chuck bt30/bt40/bt50 BT平面銑刀柄



End mill holder/sla (bt30/bt40/bt50) BT側固式銑刀柄



U 鑽系列
high speed drills
Indexable inserts

鏜刀系列
Boring Head

刀柄系列
Chuck

銑刀系列
Milling System

頂尖系列
Centre

車刀系列
Turning Tools

合金系列
Carbide insert

非標定做
Customized Products

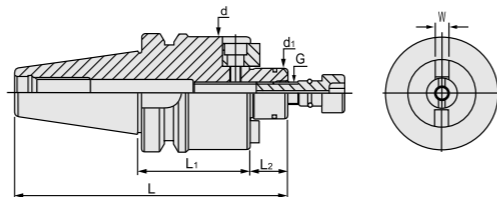

特點Features

- ◎本體錐柄規格：JIS MAS 403 BT
- ◎通孔做法有利于出水及抗震性強
- ◎平面銑刀配合部位(d1)軸系公軸W
- ◎適用於平面銑削加工
- ◎可定制非常規長度(250L/300L/350L/400L/450L)

- ◎Spindle conicity reference: JIS MAS 403 BT.
- ◎With water through design that reduces vibration and steady for cutting.
- ◎Connecting part(d1) designed for metric size.
- ◎Tool holders with BT shank for face mill chuck, Face mill holders equipped with screws and drive keys to assemble the mill cutter to holder.
- ◎Can be made upon requested dimensions (250L, 300L, 350L, 400L, 450L).

型號 Model No.	d1	d	G	W	L1	L2	規格Model
BT30-FMB22-45/60	22	48	M10	10	45/60	18	公制
BT30-FMB27-45/60	27	60	M12	12	45/60	20	
BT30-FMB32-60	32	68	M16	14	60	22	
BT30-FMA25.4-60	25.4	50	M12	9.5	60	24	英制
BT40-FMB22-60/90	22	48	M10	10	60/90	18	公制
BT40-FMB22-100/120	22	48	M10	10	100/120	18	
BT40-FMB22-150/200	22	48	M10	10	150/200	18	
BT40-FMB27-60/90	27	60	M12	12	60/90	20	
BT40-FMB27-100/120	27	60	M12	12	100/120	20	
BT40-FMB27-120/200	27	60	M12	12	150/200	20	
BT40-FMB32-60/90	32	68	M16	14	60/90	22	
BT40-FMB32-100/120	32	68	M16	14	100/120	22	
BT40-FMB32-150/200	32	68	M16	14	150/200	22	
BT40-FMB40-60/90	40	68	M16	16	60/90	25	
BT40-FMB40-100/120	40	68	M16	16	100/120	25	
BT40-FMB40-150/200	40	68	M16	16	150/200	25	
BT50-FMB22-60/90	22	48	M10	10	60/90	18	公制
BT50-FMB22-100/120	22	48	M10	10	100/120	18	
BT50-FMB22-150/200	22	48	M10	10	150/200	18	
BT50-FMB27-60/90	27	60	M12	12	60/90	20	
BT50-FMB27-100/120	27	60	M12	12	100/120	20	
BT50-FMB27-150/200	27	60	M12	12	150/200	20	
BT50-FMB32-60/90	32	78	M16	14	60/90	22	
BT50-FMB32-100/120	32	78	M16	14	100/120	22	
BT50-FMB32-150/200	32	78	M16	14	150/200	22	
BT50-FMB40-60/90	40	80	M16	16	60/90	25	
BT50-FMB40-100/120	40	80	M16	16	100/120	25	
BT50-FMB40-150/200	40	80	M16	16	150/200	25	
BT50-FMB60-60/100	60	128.5	-	25.4	60/100	32	

U 鑽系列
high speed drills
Indexable inserts

鏜刀系列
Boring Head

刀柄系列
Chuck

銑刀系列
Milling System

頂尖系列
Centre

車刀系列
Turning Tools

合金系列
Carbide insert

非標定做
Customized Products

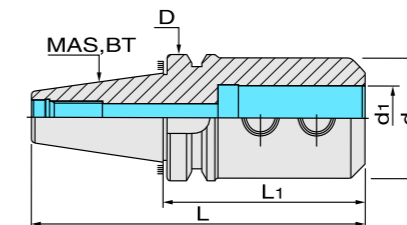

特點Features

- ◎孔徑公差H5
- ◎不分孔徑都為兩個螺釘固定
- ◎剛性夾持，用于重切削
- ◎側固式刀柄被用作刀具的工具刀柄
- ◎裝入刀具時，刀具的槽口平面部分與刀柄的側面螺釘對齊，強力鎖定
- ◎Aperture tolerance: H5.
- ◎End Mill are held by one or two set screws.
- ◎Used for remachining with rigidly grip.
- ◎Face mill chuck uses to be the holder of cutting tools.
- ◎When attaching, cutting tools, with strong side aligned lock between the plane of the part and notch solid screws.

型號/規格 Model	d1	D	d	L	L1
BT40-SLA16-100	16	63	48	165.4	100
BT40-SLA20-100	20	63	50	165.4	100
BT40-SLA25-100	25	63	52	165.4	100
BT40-SLA32-100	32	63	60	165.4	100
BT40-SLA40-100	40	63	70	165.4	100
BT50-SLA16-100	16	100	48	206.8	100
BT50-SLA20-100	20	100	50	206.8	100
BT50-SLA25-100	25	100	52	206.8	100
BT50-SLA32-100	32	100	60	206.8	100
BT50-SLA40-100	40	100	70	206.8	100

BT有扁尾莫氏刀柄 Morse tap holder/bt(MTA)

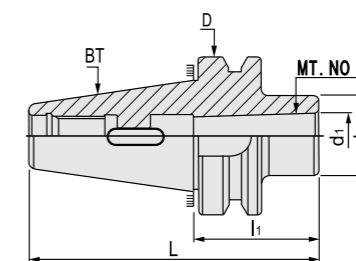

特點Features

- ◎本體錐柄規格：JIS MAS 403 BT
- ◎刀柄用于莫氏錐柄刀具、鑽頭、絞刀等
- ◎Spindle conicity standard: JIS, MAS 403 BT.
- ◎Used in Morse conicity tools, drill chuck, reamer and so on.

型號/規格 Model	d1	D	d	L	L1	MT.NO
BT30-MTA2-60	17.78	46	32	108.4	60	2
BT30-MTA3-80	23.83	46	40	128.4	80	3
BT40-MTA2-50	17.78	63	32	115.4	50	2
BT40-MTA3-75	23.83	63	40	140.4	75	3
BT40-MTA4-90	31.27	63	48	155.4	90	4
BT50-MTA2-60	17.78	100	32	161.8	60	2
BT50-MTA3-75	23.83	100	40	176.8	75	3
BT50-MTA4-90	31.27	100	48	191.8	90	4
BT50-MTA5-105	44.40	100	65	206.8	105	5

Morse tap holder/bt(MTB)

BT無扁尾莫氏刀柄



Tension and compression taper chuck / bt30/bt40/bt50

BT柔性伸縮攻牙刀柄



U 鑽系列
高速度鑽
Indexable inserts
鏜刀系列
Boring Head
刀柄系列
Chuck
銑刀系列
Milling System
頂尖系列
Centre
車刀系列
Turning Tools
合金系列
Carbide insert
非標定做
Customized Products

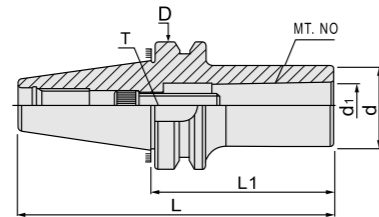

特點Features

- ◎本體錐柄規格: JIS MAS 403 BT
- ◎刀柄用于莫氏錐柄銑刀
- ◎Spindle conicity standard: JIS, MAS 403 BT.
- ◎Dimensions.

型號/規格 Model	d1	T	接釘形成 Pull stud	d	L	L1	MT.NO
BT30-MTB1-45	12.065	M6	螺釘吊拉	25	93.4	45	1
BT30-MTB2-60	17.78	M10	螺釘吊拉	32	108.4	60	2
BT40-MTB2-50	17.78	M10	螺釘吊拉	32	115.4	50	2
BT40-MTB3-75	23.83	M12	螺釘吊拉	40	140.4	75	3
BT40-MTB4-90	31.27	M16	直接加長拉丁	48	155.4	90	4
BT50-MTB2-45	17.78	M10	螺釘吊拉	32	146.8	45	2
BT50-MTB3-75	23.83	M12	螺釘吊拉	40	161.8	60	3
BT50-MTB4-90	31.27	M16	螺釘吊拉	48	176.8	75	4
BT50-MTB5-105	44.4	M20	直接加長拉丁	68	206.8	105	5

BT螺栓拉頭

BT pull studs



特點Features

- ◎采用特殊鋼材和熱處理工藝, 使產品不但具有硬度, 而且具有韌性和抗拉性
- ◎特殊規格亦可訂做
- ◎Made by special steel, heart treated with high hardness, aseismicity.
- ◎The special specification may make to order.

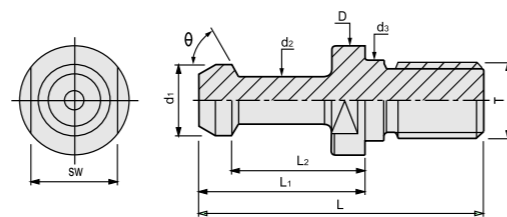

規格TYPE	D	d1	d2	d3	L	L1	L2	SW	T
BT30-45°	16.5	11	7	12.5	43	23	18	13	M12
BT40-45°	23	15	10	17	60	35	28	19	M16
BT50-45°	38	23	17	25	85	45	35	30	M24
BT30-60°	16.5	11	7	12.5	43	23	18	13	M12
BT40-60°	23	15	10	17	60	35	28	19	M16
BT50-60°	38	23	17	25	85	45	35	30	M24
BT30-90°	16.5	11	7	12.5	43	23	18	13	M12
BT40-90°	23	15	10	17	60	35	28	19	M16
BT50-90°	38	23	17	25	85	45	35	30	M24

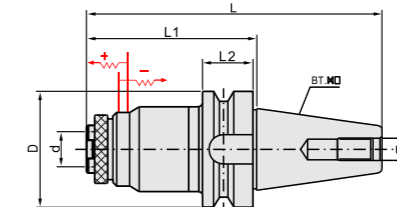

特點Features

- ◎本體規格JIS MAS 430 BT
- ◎具有扭矩過載保護可防止絲錐斷裂。
- ◎具有浮動、伸縮、快換等功能。
- ◎適合在CNC加工中心、數控銑床等機床設備。
- ◎攻絲範圍: M3-M42.
- ◎Spindle conicity Standard: JIS MAS 403 BT.
- ◎Torque overload protection protects screw blank from fracture.
- ◎Have floating, quick change and torque protection functions.
- ◎Used on lathes, borers and private plane machines and so on.
- ◎Tapping range: M3-M42.

型號/規格 Model	攻牙範圍 Gripl range	D	d	L	L1	L2	T	筒夾名稱 Collet name
BT30-GT0312	M3-M12	46	19	141	87.6	20	M12	G3
BT40-GT0312	M3-M12	63	19	153	92.6	25	M16	
BT50-GT0312	M3-M12	100	19	199	97.2	35	M16	
BT40-GT1224	M12-M24	63	30	200	134.6	25	M24	G12
BT50-GT1224	M12-M24	100	30	246	142.2	35	M24	
BT50-GT2442	M24-M42	100	45	276	174.2	35	M42	G24

BT剛性伸縮攻牙刀柄

Rigid tension and compression taper chuck

bt30/bt40/bt50

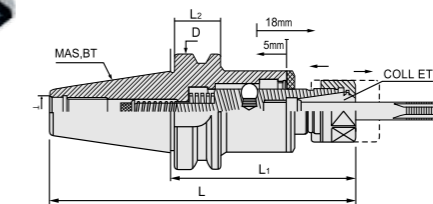

特點Features

- ◎本體規格: JIS MAS 403 BT
- ◎剛性功能確保加工中心主軸轉動同進給精確同步, 使用專用基礎刀柄。
- ◎剛性攻牙刀柄可使用ER筒夾代替, 作為夾持鑽頭、銑刀和銑刀工具刀柄。
- ◎采用剛性攻牙本體, 使用時, 螺帽請勿過度鎖緊, 以免造成損壞, ER扳手為另購品。
- ◎Spindle Conicity Standard: JIS MAS 403 BT.
- ◎Rigid function ensures machining center spindle rotate in synchronized precise, While MTB holder in use.
- ◎Can be replaced by ER collet for gripping cutting tool, Drill bit, and draw bolt and so on.
- ◎Don't lock excessively of the clamping nut in case of damage. Wrench ont included.m

型號/規格 Model	攻牙範圍 Gripl range	D	L	L1	L2	T	筒夾名稱 Collet name
BT30-TER16	M2-M12	46	149	100.6	20	M12	ER16
BT30-TER20	M2-M16	46	151	102.6	20	M12	ER20
BT30-TER25	M2-M22	46	153	104.6	20	M12	ER25
BT30-TER32	M2-M30	46	156	107.6	20	M12	ER32
BT40-TER16	M2-M12	63	161	95.6	25	M16	ER16
BT40-TER20	M2-M16	63	163	97.6	25	M16	ER20
BT40-TER25	M2-M22	63	165	99.6	25	M16	ER25
BT40-TER32	M2-M30	63	168	102.6	25	M16	ER32
BT50-TER16	M2-M12	100	270	105.2	35	M24	ER16
BT50-TER20	M2-M16	100	209	107.2	35	M24	ER20
BT50-TER25	M2-M22	100	211	109.2	35	M24	ER25
BT50-TER32	M2-M30	100	214	112.2	35	M24	ER32

Tapping collet CT3(ISO) CT3攻絲套夾(公制)



Drill chuck holder/apu 一體鑽夾頭刀柄



特點

- ◎本品具有扭矩過載保護功能、高精度、高感度和使用壽命長。
- ◎扭矩的變動反應靈敏，可根據各種不同材質而設定相應的扭矩。
- ◎適用於各種攻牙機器和電動攻牙機、氣動攻牙機。

Features

- ◎High precision, long tool-life with torque protection function.
- ◎Torsion reflect sensitive and changes according to various material to set up corresponding torque.
- ◎Used for kinds of tapping machine including electric tapping machine and pneumatic tapping machine

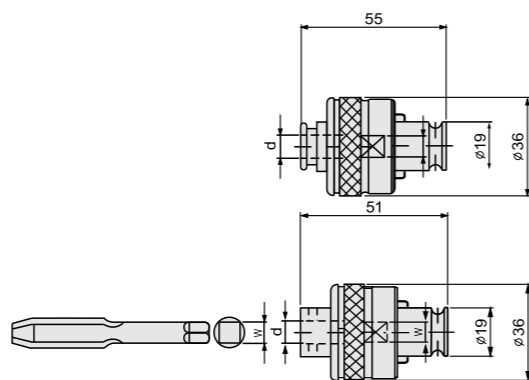

型號 Model	規格(公制)Specification	d +0.08	W +0.15
CT3	M3	3.15	2.5
	M4	4	3.15
	M5	5	4
	M6-8	6.3	5
	M10	8	6.3
	M12	9	7.1
	M14	11.2	9
	M16	12.5	10

CT3攻絲套夾（英制） Tapping collet CT3(JIS)

型號 Model	規格(英制)Specification	d	W +0.15
CT3	1/8	4	3.2
	5/32	5	4
	3/16	5.5	4.5
	1/4	6	4.5
	5/16	6.1	5
	3/8	7	5.5
	7/16	8	6
		8.5	6.5
		9	7

特點Features

- ◎本產品為增加了多層安全性設計，能提供給綜合切削中心機使用，在電腦操控的全自動作業中，以及無人化的管理的整個流程，都能夠安全及順利地進行。
- ◎SPU偏擺精度為0.04mm，如需更高精度要求請使用ER或SKS系列。
- ◎This product is added with multi safety design and suitable for Machine Center. In totally automatic operation controlled by computer and unmanned management process. Can be processed safely and smoothly.
- ◎The SPU leaning precision is 0.04mm. like the need high accuracy request. please use ER or the SKS series.

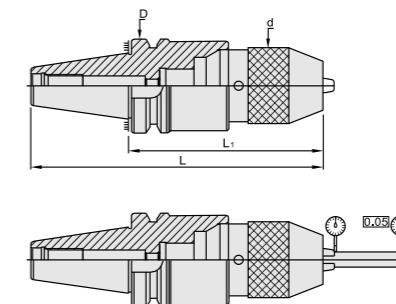

型號/規格 Model	夾持範圍Range	D	d	L1	L
BT30-APU08-85	0.5-8	46	37	85	142.4
BT30-APU13-110	1-13	46	50	110	158.4
BT40-APU13-110	1-13	63	50	110	175.4
BT40-APU16-120	1-16	63	57	130	195.4
BT50-APU13-110	1-13	100	50	120	221.8
BT50-APU16-120	1-16	100	57	135	236.8
NT30-APU08-85	0.5-8	46	37	73	150.4
NT40-APU13-110	1-13	63	50	95	185.4
NT40-APU16-120	1-16	63	57	95	205.4
NT50-APU13-110	1-13	100	50	97	223.8
NT50-APU16-120	1-16	100	57	97	238.8

直柄ER延長杆 Stragight chuck type ER

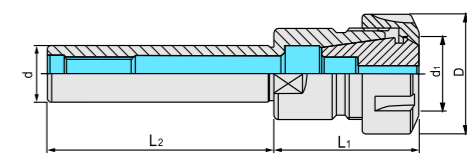

特點Features

- ◎採用優質材料制成，抗震性極佳。
- ◎適用高精度銑削、鉸孔加工、鑽孔加工
- ◎Made of high quality material with low vibration.
- ◎Suitable for high precision drilling, milling, reaming processing and so on.

型號/規格 Model	夾持範圍 Range	D	d	d1	L1	L2	筒夾名稱 Collet name
C16-ER11-100/150	0.5-7	19	16	11	21.6	100/150	ER11
C16-ER11M-100/150	0.5-7	16	16	11	21.6	100/150	ER11
C16-ER16M-100/150	1-10	22	16	16	35.1	100/150	ER16
C16-ER16-100/150	1-10	28	16	16	35.1	100/150	ER16
C16-ER20-100/150	1-13	34	16	20	40.5	100/150	ER20
C20-ER16-100/150	1-10	28	20	16	35.1	100/150	ER16
C20-ER16M-100/150	1-10	22	20	16	35.1	100/150	ER16
C20-ER20M-100/150	1-13	28	20	20	40.5	100/150	ER20
C20-ER20-100/150	1-13	34	20	20	40.5	100/150	ER20
C25-ER16-100/150	1-10	28	25	16	35.1	100/150	ER16
C25-ER20-100/150	1-13	34	25	20	40.5	100/150	ER20
C32-ER25-60/100	1-16	42	32	25	48.5	60/150	ER25

U 鑽系列
high speed drills
Indexable inserts

鏜刀系列
Boring Head

刀柄系列
Chuck

銑刀系列
Milling System

頂尖系列
Centre

車刀系列
Turning Tools

合金系列
Carbide insert

非標定做
Customized Products

U 鑽系列
high speed drills
Indexable inserts

鏜刀系列
Boring Head

刀柄系列
Chuck

銑刀系列
Milling System

頂尖系列
Centre

車刀系列
Turning Tools

合金系列
Carbide insert

非標定做
Customized Products

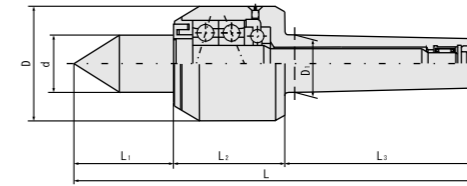
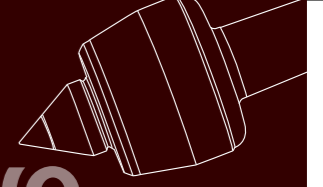

特點Features

- ◎防水防塵採用迷宮式結構;
- ◎注油孔可定期注油; 延長使用壽命;
- ◎剛性強、穩定性佳, 適用於高精密工件切削加工。
- ◎The labyrinth design resistant to solvents, oils greases and other chemical agents.
- ◎The design of oil hole to extended service life
- ◎For finishing operation with good rigidity and stability

莫氏柄號 Morse shank Number	L	L1	L2	L3	D	D1	d	精度 Precision	徑向載荷 Radial load	極限轉速 Limiting speed
3	170	32.5	52.5	86	53	23.825	22	0.003	1500	4500
4	206	37.5	60.5	109	62	31.267	27	0.003	1800	4000
5	241.5	41	64.5	136	68	44.399	30	0.003	2200	3800

交替式高精密數控回轉頂尖(套裝)
Alternate high-precision alternation live centre(set)

特點Features

- ◎防水防塵採用迷宮式結構;
- ◎採用螺帽推出頂尖頭, 更換簡宜方便不影響精度;
- ◎交替式頂尖頭適用於不同的加工工件。
- ◎The labyrinth design resistant to solvents, oils greases and other chemical agents.
- ◎The design of nut remove.
- ◎For different kinds of work parts.

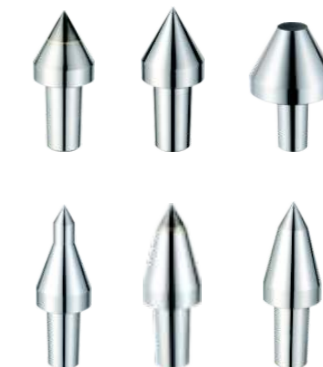
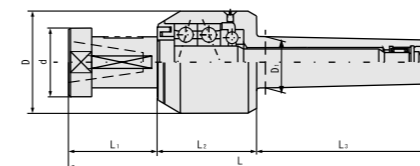

莫氏柄號 Morse shank Number	L	L1	L2	L3	D	D1	d	精度 Precision	徑向載荷 Radial load	極限轉速 Limiting speed
4	213	43	61	109	62	31.267	36	0.003	1800	4000
5	243.5	43	64.5	136	68	44.399	36	0.003	2200	3800

U 鑽系列
high speed drills
Indexable inserts

鏜刀系列
Boring Head

刀柄系列
Chuck

銑刀系列
Milling System

頂尖系列
Centre

車刀系列
Turning Tools

合金系列
Carbide insert

非標定做
Customized Products

High accuracy live center 高精度回轉頂尖

YOUN/O

Alloy high speed live center 合金高速回轉頂尖

YOUN/O

U 鑽系列
high speed drills
Indexable inserts

鏜刀系列
Boring Head

刀柄系列
Chuck

銑刀系列
Milling System

頂尖系列
Centre

車刀系列
Turning Tools

合金系列
Carbide insert

非標定做
Customized Products



- ◎特點：采用防止切削油及水滲入，構造獨特。適用於幹式切削及數控機床的濕式切削。
- ◎工藝：頂尖軸采用65Mn工具鋼，高硬度(HRC60° ± 2°)頂尖振幅 0.005mm。
- ◎Features: The special designing for dry cutting and numerical control machine of resistant to solvents, oils greases and other chemical agents.
- ◎Processing technic: The amplitude at the center end is less than 0.005mm with high hardness material-65Mn(HRC60° ± 2°).

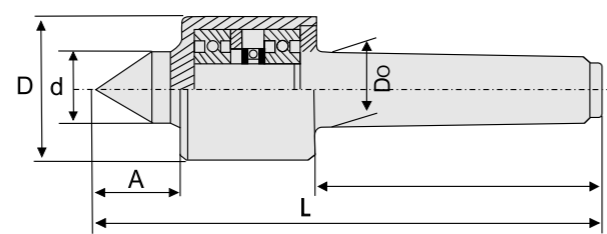
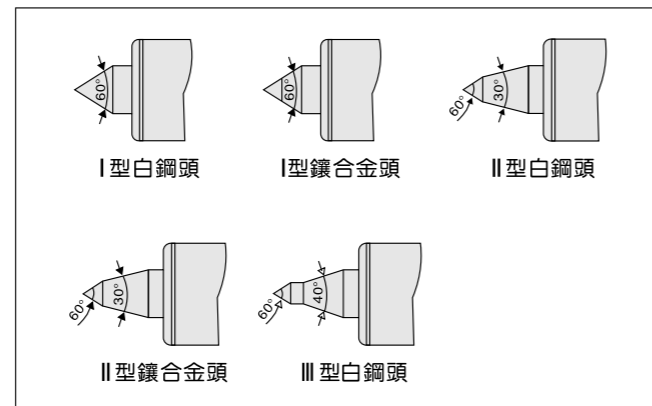

莫氏柄號 Morse shank Number	L	A	B	D	Do	d	精度 Precision	徑向載荷 Radial load	極限轉速 Limiting speed
2	130	25	69	32	17.780	16	0.003	100	3500
3	134	35	86	42	23.825	22	0.003	300	3500
4	165	40	109	50	31.267	27	0.003	600	3000
5	200	50	136	56	44.399	38	0.003	1600	2500

U 鑽系列
high speed drills
Indexable inserts

鏜刀系列
Boring Head

刀柄系列
Chuck

銑刀系列
Milling System

頂尖系列
Centre

車刀系列
Turning Tools

合金系列
Carbide insert

非標定做
Customized Products



- ◎特點：高轉速輕負載，并有防水防塵設計，適用於高轉速數控機床。
- ◎工藝：頂尖部鑲嵌硬質合金，更具有耐磨性從而延長使用壽命。
- ◎Features: The special designing for numerical control machine with higher speeds and waterproof, anti-oil.
- ◎Processing technic: The center end with carbide for wearing resistant, extended service life.

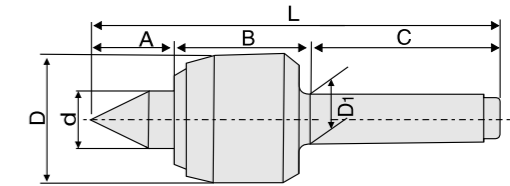
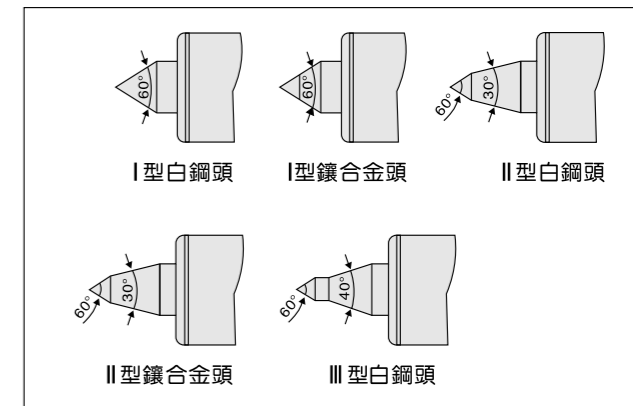
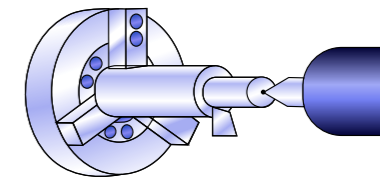

莫氏柄號 Morse shank Number	L	A	B	C	D	Di	d	精度 Precision	徑向載荷 Radial load	極限轉速 Limiting speed
3	180	39	58	86	53	23.825	27	0.005	1200	4200
4	208	55	45	109	63	31.267	32	0.005	1600	4000
5	256	49	71	136	83	44.399	40	0.005	1800	3500

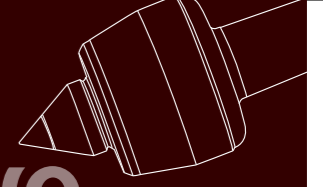

- ◎特點：設計防水、防塵功能，具有較強的負載能力，適用於普通機床幹式及濕式切削。
- ◎工藝：頂尖部鑲嵌硬質合金，更具有耐磨性從而延長使用壽命。
- ◎Features: The special designing for dry cutting and numerical control machine of resistant to solvents, oils greases and other chemical agents.
- ◎Processing technic: The center end with carbide for wearing resistant, extended service life.

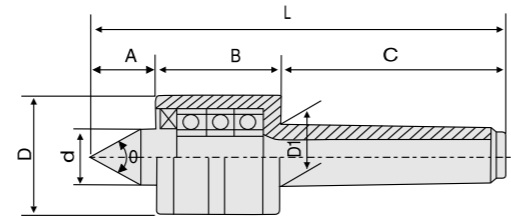
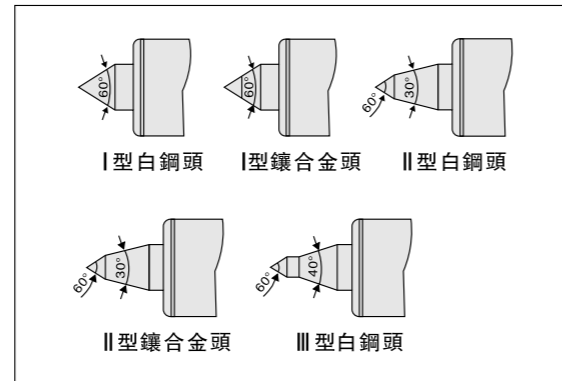

- ◎特點：適用於較大內徑工件加工使用。
- ◎工藝：內部使用滾珠軸承組合，具有較大負載能力。
- ◎Features: High-precision for heavy work pace.
- ◎Processing technic: The special designing with ball bearing for better carrying capacity.

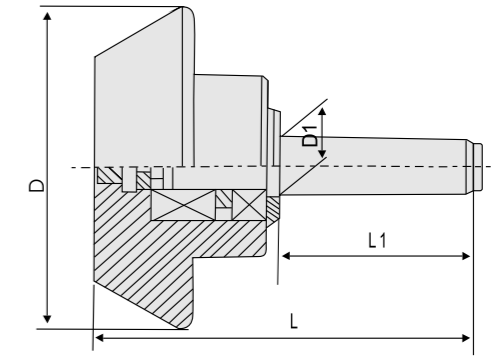

莫氏柄號 Morse shank Number	L	A	B	C	D	D1	d	精度 Precision	徑向載荷 Radial load	極限轉速 Limiting speed
1	123	20	46	57	32	12.065	17	0.005	800	3000
2	153	32	52	69	48	17.780	21	0.005	1000	2800
3	186	39	59	86	55	23.825	27	0.005	1800	2800
4	213	40	64	109	62	31.267	29	0.005	2800	2400
5	278	53	88	136	85	44.399	38	0.005	4500	1800

莫氏柄號 Morse shank Number	L	D	D1	L1	精度 Precision	徑向載荷 Radial load	極限轉速 Limiting speed
2	140	80	17.780	69	0.01	1000	1000
3	157	80-120	23.825	86	0.01	1500	1000
4	236	210	31.267	109	0.01	3000	1000
5	354	252	44.399	136	0.01	4500	800
6	393	350	63.348	190	0.01	6000	600
80	464	350-400	80	204	0.02	12000	380

U 鑽系列
high speed drills
Indexable inserts

鏜刀系列
Boring Head

刀柄系列
Chuck

銑刀系列
Milling System

頂尖系列
Centre

車刀系列
Turning Tools

合金系列
Carbide insert

非標定做
Customized Products

U 鑽系列
high speed drills
Indexable inserts

鏜刀系列
Boring Head

刀柄系列
Chuck

銑刀系列
Milling System

頂尖系列
Centre

車刀系列
Turning Tools

合金系列
Carbide insert

非標定做
Customized Products

Alloy dead center 合金固定頂尖

YOUN/O

U 鑽系列
high speed drills
Indexable inserts

鏜刀系列
Boring Head

刀柄系列
Chuck

銑刀系列
Milling System

頂尖系列
Centre

車刀系列
Turning Tools

合金系列
Carbide insert

非標定做
Customized Products

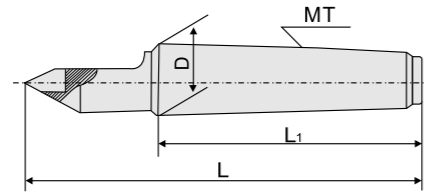

- ◎特點：以頂尖中心定位，從而提高加工精度。
- ◎工藝：鑲嵌硬質合金，硬度HRC75° ± 2°。
- ◎Features: Fixed position with the centre end.
- ◎Processing technic: The center end with carbide of high hardness HRC75 ± 2°

莫氏柄號 Morse shank Number	D	L	L1	合金直徑 ΦDiameter of alloy	精 度 Precision
0	9.045	70	53	6	0.002
1	12.065	80	57	8	0.002
2	17.780	100	69	10	0.002
3	23.825	125	86	12	0.002
4	31.267	160	109	15	0.002
5	44.399	200	136	18	0.005
6	63.348	280	190	24	0.005
80	80	338	204	40	0.005
100	100	375	242	60	0.005
120	120	430	280	70	0.005

合金半缺固定頂尖 Alloy half dead center

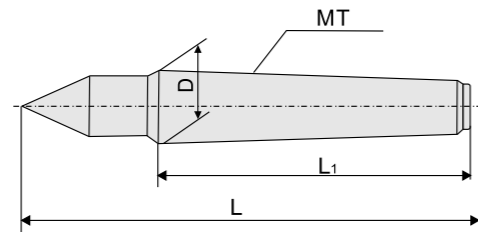

- ◎特點：增加切削角度，從而提高機床效能，一般適用於磨床。
- ◎工藝：鑲嵌硬質合金，硬度HRC75° ± 2°。
- ◎Features: Enlarge the cutting angle for grinding machine.
- ◎Processing technic: The center end with carbide of high hardness HRC75 ± 2° .

莫氏柄號 Morse shank Number	D	L	L1	合金直徑 ΦDiameter of alloy	精 度 Precision
1	12.065	80	57	8	0.002
2	17.780	100	69	10	0.002
3	23.825	125	86	12	0.002
4	31.267	160	109	15	0.002
5	44.399	200	136	18	0.002
6	63.348	280	190	24	0.002

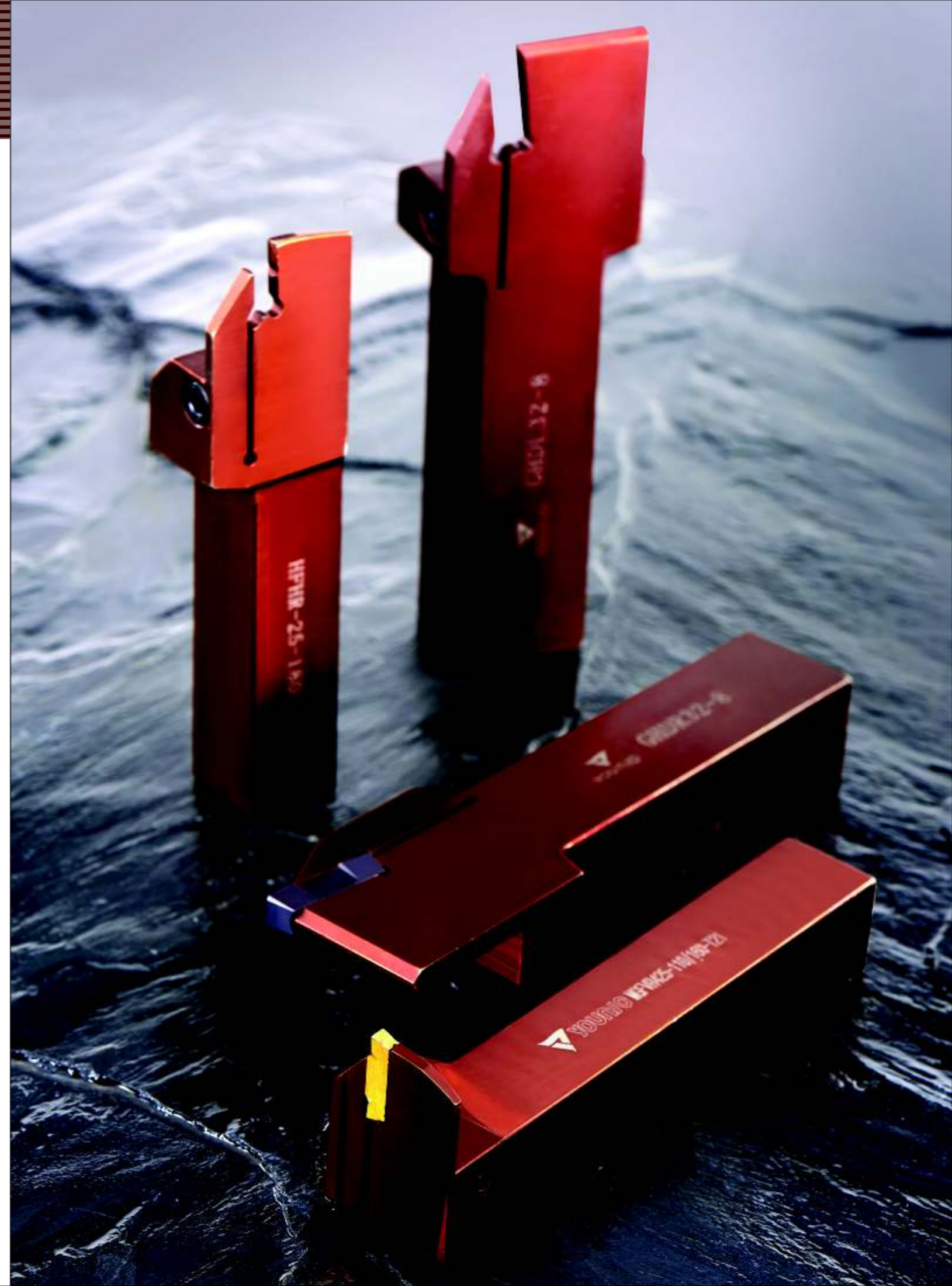

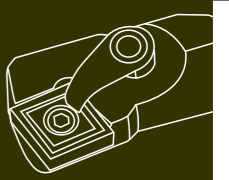

MCKN

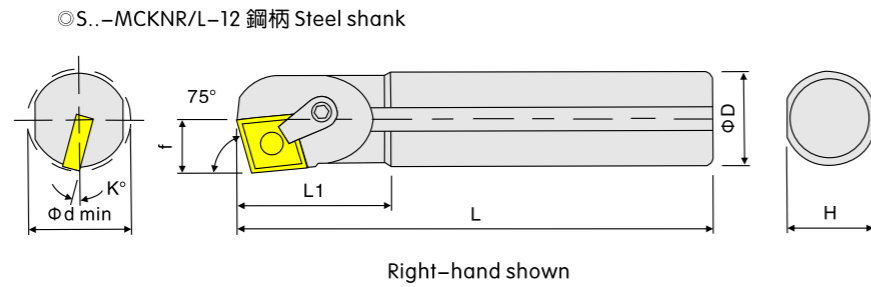
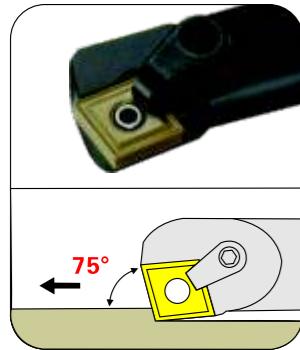

Item code	Dimensions,mm							Insert	Shim	Pin	Wrench	Clamp	Screw	Wrench
	D	L	L1	f	H	K	dmin							
S20R-MCKNR/L-12	20	200	36	13	18	15	25	CN..1204..	--	MLP44	PL25	MC620	MS620	PL30
S25R-MCKNR/L-12	25	200	40	15	23	13	30	CN..1204..	--	MLP44	PL25	MC620	MS620	PL30
S32S-MCKNR/L-12	32	250	48	20	30	13	40	CN..1204..	CMS432	MIP46	PL25	MC620	MS625	PL30

MCLN

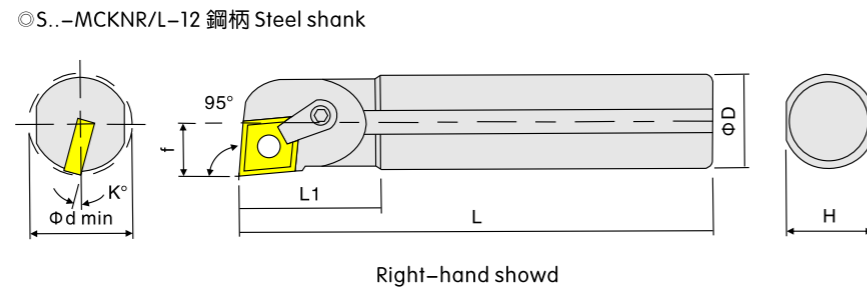
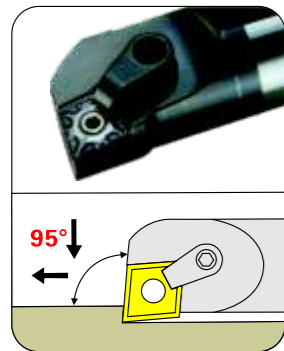

Item code	Dimensions,mm							Insert	Shim	Pin	Wrench	Clamp	Screw	Wrench
	D	L	L1	f	H	K	dmin							
S20R-MCLNR/L-12	20	200	36	13	18	15	25	CN..1204..	--	MLP44	PL25	MC620	MS620	PL30
S25R-MCLNR/L-12	25	200	40	15	23	13	30							
S32S-MCLNR/L-12	32	250	48	20	30	13	40	CN..1204..	CMS432	MLP46	PL25	MC620	MS625	PL30
S40T-MCLNR/L-12	40	300	55	25	37	12	50							
S50U-MCLNR/L-12	50	350	60	30	47	10	60							

MTUN

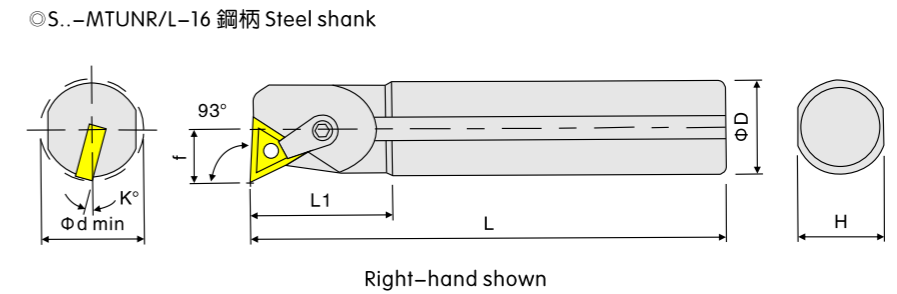
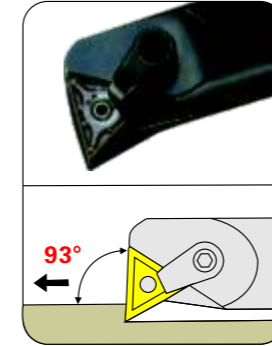

Item code	Dimensions,mm							Insert	Shim	Pin	Wrench	Clamp	Screw	Wrench
	D	L	L1	f	H	K	dmin							
S20R-MTUNR/L-16	20	200	36	13	18	15	25	TN..1604..	--	MLP33L	PL20	MC515	MS520	PL25
S25R-MTUNR/L-16	25	200	40	15	23	13	30	TN..1604..	TMS322	MLP34L	PL20	MC620	MS625	PL30
S32S-MTUNR/L-16	32	250	48	20	30	13	40							
S40T-MTUNR/L-16	40	300	55	26	37	10	50							
S50U-MTUNR/L-16	50	350	60	31	47	9	60							
S60V-MTUNR/L-16	60	400	60	36	57	8	70							

WTUN

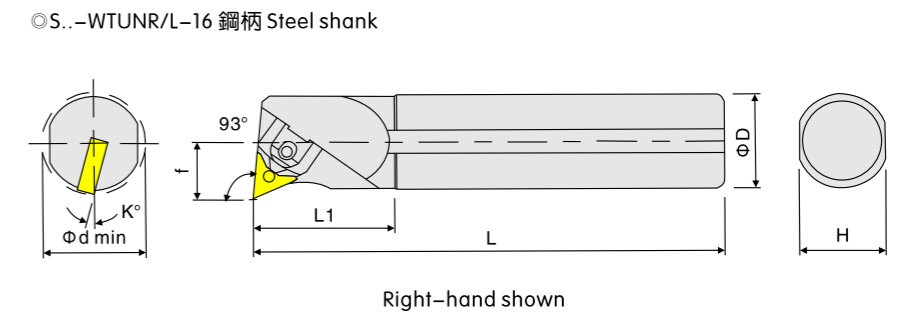
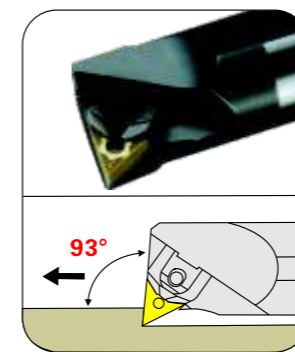

Item code	Dimensions,mm							Insert	Shim	Pin	Clamp	Wrench
	D	L	L1	f	H	K	dmin					
S32S-WTUNR/L-16	32	250	48	20	30	13	40	TN..1604..	TMS322	SCP315	MCW3-P25	PL25
S40T-WTUNR/L-16	40	300	55	26	37	10	50					
S40U-WTUNR/L-16	40	350	55	26	37	10	50					
S50U-WTUNR/L-16	50	350	60	31	47	9	60	TN..1604..	TMS322	SCP318	MCW3-P25	PL25
S50V-WTUNR/L-16	50	400	60	31	47	9	60					
S60V-WTUNR/L-16	60	400	60	36	57	8	70					

U 鑽系列
high speed drills
Indexable inserts

鏜刀系列
Boring Head

刀柄系列
Chuck

銑刀系列
Milling System

頂尖系列
Centre

車刀系列
Turning Tools

合金系列
Carbide insert

非標定做
Customized Products

U 鑽系列
high speed drills
Indexable inserts

鏜刀系列
Boring Head

刀柄系列
Chuck

銑刀系列
Milling System

頂尖系列
Centre

車刀系列
Turning Tools

合金系列
Carbide insert

非標定做
Customized Products

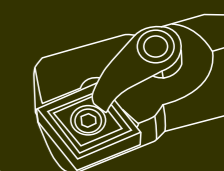

MVUN

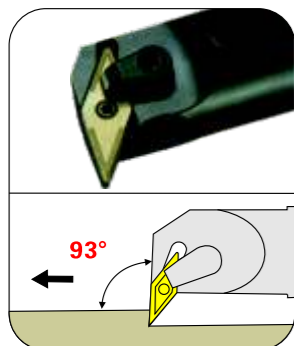

◎S..-MVUNR/L-16 鋼柄 Steel shank

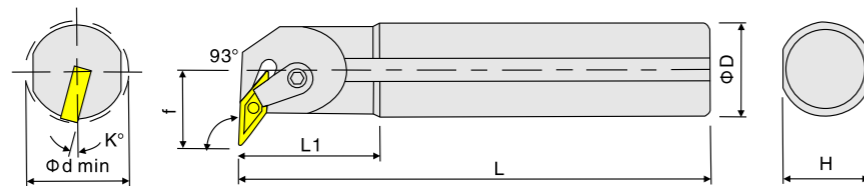

Right-hand shown

Item code	Dimensions,mm							Insert	Shim	Pin	Wrench	Clamp	Screw	Wrench
	D	L	L1	f	H	K	dmin							
S25R-MVUNR/L-16	25	200	40	18	23	13	32	VN..1604..	--	MLP33L	PL20	MC515	MS520	PL25
S32S-MVUNR/L-16	32	250	50	22	30	15	40	VN..1604..	VMS322	MLP34L	PL20	MC620	MS625	PL30

MWLN

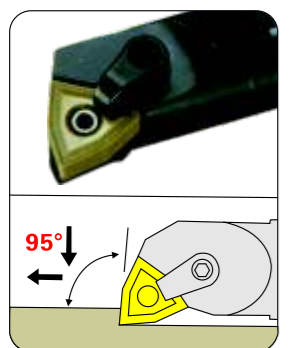

◎S..-MWLNR/L-08 鋼柄 Steel shank

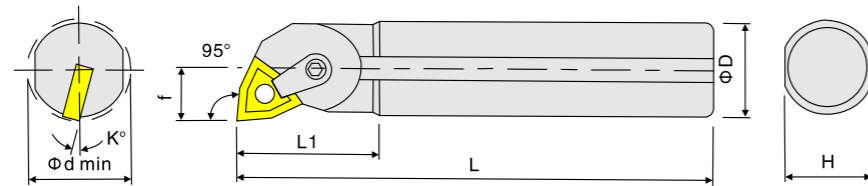

Right-hand shown

Item code	Dimensions,mm							Insert	Shim	Pin	Wrench	Clamp	Screw	Wrench
	D	L	L1	f	H	K	dmin							
S20R-MWLNR/L-08	20	200	36	13	18	15	25	WN..0804..	--	MLP44	PL25	MC515	MS520	PL25
S25R-MWLNR/L-08	25	200	40	15	23	13	30							
S32S-MWLNR/L-08	32	250	48	20	30	13	40							
S40T-MWLNR/L-08	40	300	55	26	37	10	50	WN..0804..	WMS432	MLP46	PL25	MC620	MS625	PL30
S50U-MWLNR/L-08	50	350	60	31	47	9	60							
S60V-MWLNR/L-08	60	400	60	36	57	8	70							

SCLC

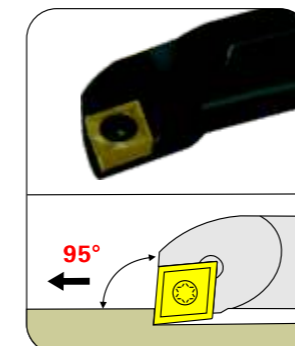

◎S..-SCLCR/L-.. 鋼柄 Steel shank

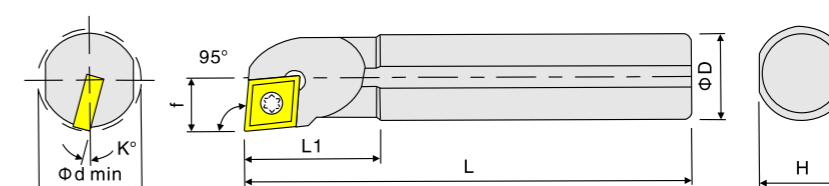

Right-hand shown

Item code	Dimensions,mm							Insert	Screw	Wrench
	D	L	L1	f	H	K	dmin			
S08K-SCLCR/L-06	8	125	18	5	7	15	10	CC.0602..	MS2506A	TF9
S10K-SCLCR/L-06	10	125	22	6	9	13	12			
S12M-SCLCR/L-06	12	150	26	8	11	10	16			
S16Q-SCLCR/L-06	16	180	32	10	15	7	20			
S12M-SCLCR/L-09	12	150	26	8	11	10	16	CC.09T3..	MS4009A	TF15
S16Q-SCLCR/L-09	16	180	32	10	15	7	20			
S20R-SCLCR/L-09	20	200	36	13	18	5	25			
S25R-SCLCR/L-09	25	200	40	15	23	5	30	CC..09T3..	MS4011A	TF15

SDJC

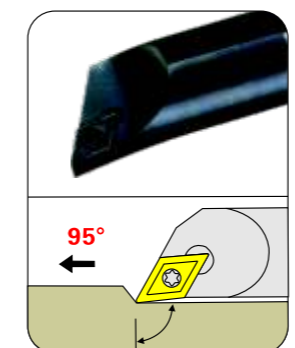

◎S..-SDJCR/L-.. 鋼柄 Steel shank

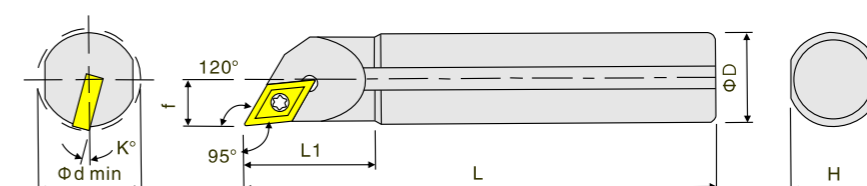

Right-hand shown

Item code	Dimensions,mm							Insert	Screw	Wrench
	D	L	L1	f	H	K	dmin			
S08K-SDJCR/L-07	8	125	22	5	7	15	10	DC..0702..	MS2506A	TF9
S10K-SDJCR/L-07	10	125	25	6	9	13	12			
S12M-SDJCR/L-07	12	150	30	7	11	10	14			
S16Q-SDJCR/L-07	16	180	38	9.5	15	7	19			
S16Q-SDJCR/L-11	16	180	38	9.5	15	7	19	DC..11T3..	MS4009A	TF15
S20R-SDJCR/L-11	20	200	42	11.5	18	7	23			
S25R-SDJCR/L-11	25	200	45	14	23	5	28			
S32S-SDJCR/L-11	32	250	48	17.5	30	5	35	DC..11T3..	MS4009A	TF15

U 鑽系列
high speed drills
Indexable inserts

鏜刀系列
Boring Head

刀柄系列
Chuck

銑刀系列
Milling System

頂尖系列
Centre

車刀系列
Turning Tools

合金系列
Carbide insert

非標定做
Customized Products

U 鑽系列
high speed drills
Indexable inserts

鏜刀系列
Boring Head

刀柄系列
Chuck

銑刀系列
Milling System

頂尖系列
Centre

車刀系列
Turning Tools

合金系列
Carbide insert

非標定做
Customized Products

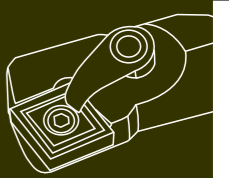

SDQC

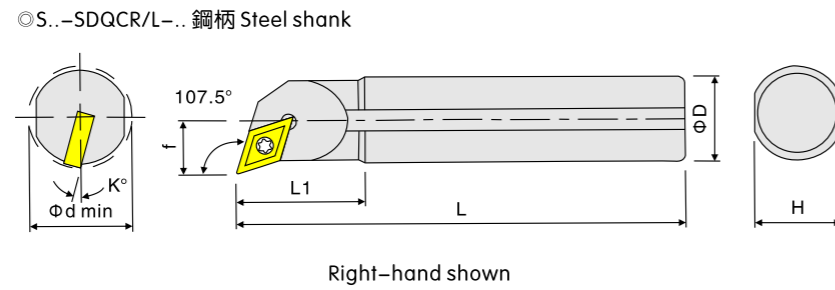
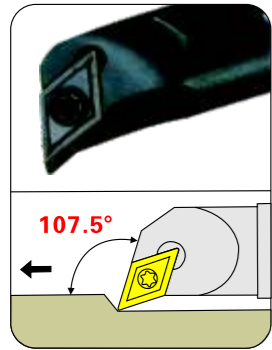

Item code	Dimensions,mm							Insert	Screw	Wrench
	D	L	L1	f	H	K	dmin			
S10K-SDQCR/L-07	10	125	22	6	9	13	13	DC..0702..	MS2506A	TF9
S16Q-SDQCR/L-07	16	180	35	10	15	7	20			
S16Q-SDQCR/L-11	16	180	35	10	15	7	20	DC..11T3..	MS4009A	TF15
S20R-SDQCR/L-11	20	200	40	13	18	7	25			
S25R-SDQCR/L-11	25	200	45	15	23	5	32			

STFC

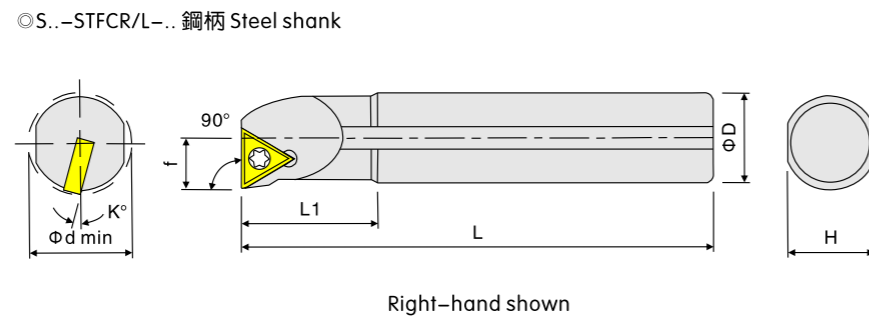
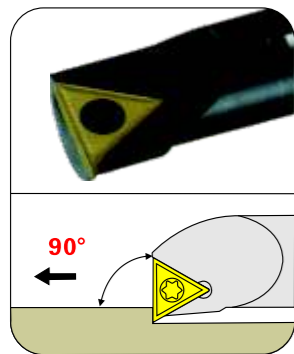

Item code	Dimensions,mm							Insert	Screw	Wrench
	D	L	L1	f	H	K	dmin			
S08K-STFCR/L-09	8	125	18	5.5	7	15	10	TC..0902..	MS2206A	TF7
S10K-STFCR/L-09	10	125	22	6	9	13	12			
S10K-STFCR/L-11	10	125	22	6	9	13	12	TC..1102..	MS2506A	TF9
S12M-STFCR/L-11	12	150	26	8	11	10	16			
S16Q-STFCR/L-11	16	180	32	10	15	7	20			
S25R-STFCR/L-16	25	200	40	15	23	5	30	TC..16T3..	MS4011A	TF15

SDUC

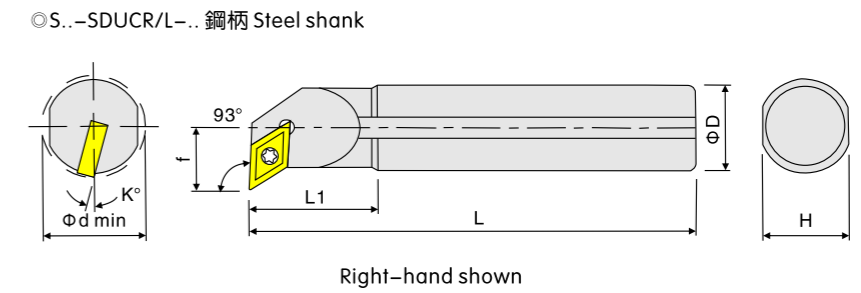

Item code	Dimensions,mm							Insert	Screw	Wrench
	D	L	L1	f	H	K	dmin			
S10K-SUDCR/L-07	10	125	25	7	9	13	13	DC..0702..	MS2506A	TF9
S12M-SUDCR/L-07	12	150	30	9	11	10	16			
S16Q-SUDCR/L-07	16	180	30	11	15	7	20			
S20R-SUDCR/L-07	20	200	40	13	18	7	25	DC..11T3..	MS4009A	TF15
S16Q-SUDCR/L-11	16	180	30	11	15	7	20			
S20R-SUDCR/L-11	20	200	40	13	18	7	25			
S25R-SUDCR/L-11	25	200	45	17	23	5	32			
S32S-SUDCR/L-11	32	250	48	20	30	5	40			
S40T-SUDCR/L-11	40	300	55	25	37	3	50			

SVUB/C

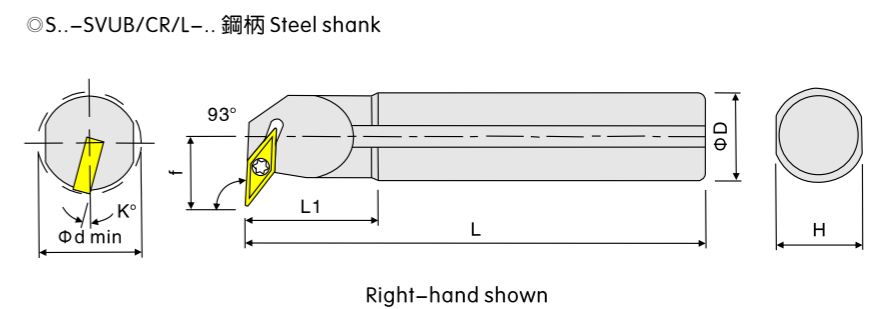
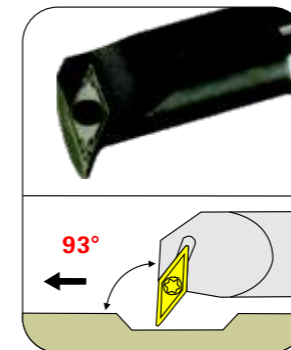

Item code	Dimensions,mm							Insert	Shim	Screw	Wrench	Screw	Wrench
	D	L	L1	f	H	K	dmin						
S16Q-SVUBR/L-11	16	180	30	13	15	7	22	VB..1103..	--	--	--	MS2506B	TF9
S20R-SVUBR/L-11	20	200	40	15	18	7	27					MS3509B	TF15
S25R-SVUBR/L-16	25	200	45	18	23	5	32	VB..1604..	VSS322	MDS5035	PI35	MS3512B	TF15
S32S-SVUBR/L-16	32	250	50	22	30	5	40						
S40T-SVUBR/L-16	40	300	55	27	37	5	50	VC..0802..	--	--	--	MS2005A	TF6
S12M-SVUCRR/L-08	12	150	26	9.5	11	10	16						
S1612M-SVUCRR/L-08	16	150	31	9.5	15	10	16	VC..1103..	--	--	--	MS2506B	TF9
S16Q-SVUCR/L-11	16	180	30	13	15	7	22						
S20R-SVUCR/L-11	20	200	40	15	18	7	27	VC..1604..	--	--	--	MS3509B	TF15
S25R-SVUCR/L-16	25	200	45	18	23	5	32						
S32S-SVUCR/L-16	32	150	50	22	30	5	40	VC..1604..	VSS322	MDS5035	PL35	MS3512B	TF15
S32U-SVUCR/L-16	32	350	50	22	30	5	40						
S40T-SVUCR/L-16	40	300	55	27	37	5	50	VC..1604..	VSS322	MDS5035	PL35	MS3512B	TF15
S40U-SVUCR/L-16	40	350	55	27	37	5	50						
S40V-SVUCR/L-16	40	400	55	27	37	5	50						

U 鑽系列
高速度鑽
可換鑽頭
鑽刀系列
刀柄系列
銑刀系列
頂尖系列
車刀系列
合金系列
非標定做

U 鑽系列
高速度鑽
可換鑽頭
鑽刀系列
刀柄系列
銑刀系列
頂尖系列
車刀系列
合金系列
非標定做

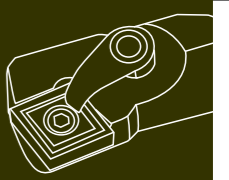

NC

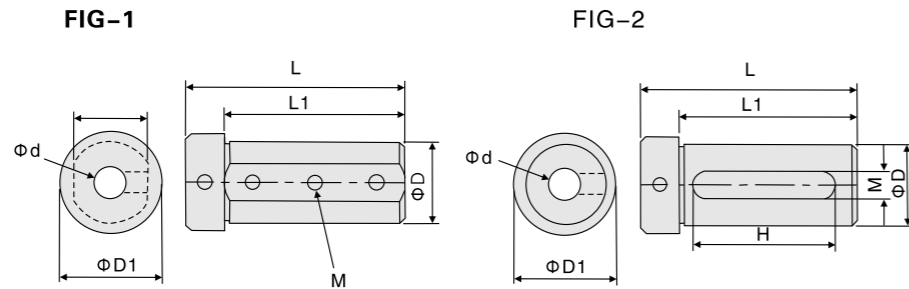

Item code	Dimensions,mm							SHAPE
	d	D	L	L1	D1	H	M	
NC16-06	6	16	62	55	19	14.5	M5	FIG-1
NC16-08	8						M6	
NC16-10	10						M4	
NC16-12	12	16	62	55	19	50	9	FIG-2
NC20-06	6	20	67	60	27	17.5	M6	FIG-1
NC20-08	8							
NC20-10	10							
NC20-12	12	20	67	60	27	55	13	FIG-2
NC20-16	16	20	51	45	27	17.5	M6	FIG-1
NC20S-06	6							
NC20S-08	8							
NC20S-10	10	20	51	45	27	40	13	FIG-2
NC20S-12	12	25	64	58	35	23.5	M6	FIG-1
NC25-06	6							
NC25-08	8							
NC25-10	10	25	64	58	35	51	12	FIG-2
NC25-12	12							
NC25-14	14							
NC25-16	16	32	85	70	38	29.5	M6	FIG-1
NC25-18	18							
NC25-20	20							
NC25-22	22	32	100	85	38	29.5	M8	FIG-1
NC32-06	6							
NC32-08	8							
NC32-10	10	32	100	85	38	77	14	FIG-2
NC32-12	12							
NC32-14	14							
NC32-16	16	32	100	85	38	77	-	FIG-1
NC32-18	18							
NC32-20	20							
NC32-22	22	32	100	85	38	77	14	FIG-2
NC32-25	25							
NC32-MTA1	MTA1							
NC32-MTA2	MTA2	32	100	85	38	77	-	FIG-1
NC32-MTA3	MTA3							

NC

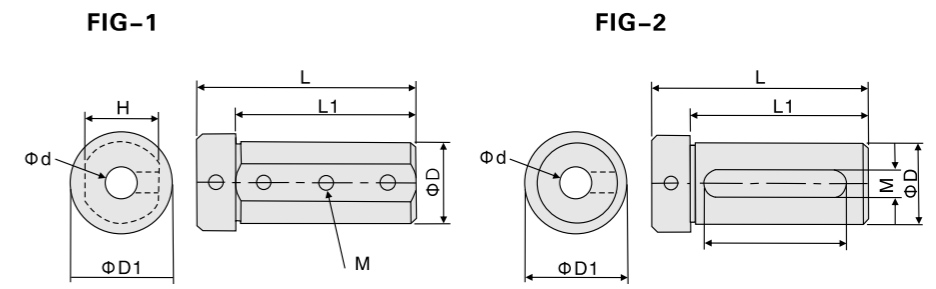

Item code	Dimensions,mm							SHAPE
	d	D	L	L1	D1	H	M	
NC40-06	6	40	100	85	46	38	M8	FIG-1
NC40-08	8							
NC40-10	10							
NC40-12	12	40	100	85	46	77	14	FIG-2
NC40-14	14							
NC40-16	16							
NC40-18	18	40	100	85	46	38	-	FIG-1
NC40-20	20							
NC40-22	22							
NC40-25	25	40	100	85	46	77	14	FIG-2
NC40-32	32							
NC40-MTA1	MTA1							
NC40-MTA2	MTA2	40	100	85	46	38	-	FIG-1
NC40-MTA3	MTA3							
NC40-MTA4	MTA4	50	100	85	58	48	M8	FIG-1
NC50-08	8							
NC50-10	10							
NC50-12	12	50	100	85	58	77	14	FIG-2
NC50-16	16							
NC50-20	20							
NC50-25	25	50	100	85	58	77	14	FIG-2
NC50-32	32							
NC50-40	40							
NC50-MTA3	MTA3	50	100	85	58	48	-	FIG-1
NC50-MTA4	MTA4							
NC50-MTA5	MTA5							

U 鑽系列
high speed drills
Indexable inserts
鏜刀系列
Boring Head
刀柄系列
Chuck
銑刀系列
Milling System
頂尖系列
Centre
車刀系列
Turning Tools
合金系列
Carbide insert
非標定做
Customized Products

U 鑽系列
high speed drills
Indexable inserts
鏜刀系列
Boring Head
刀柄系列
Chuck
銑刀系列
Milling System
頂尖系列
Centre
車刀系列
Turning Tools
合金系列
Carbide insert
非標定做
Customized Products

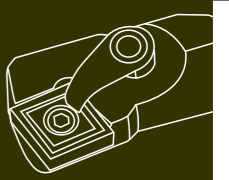

MCKN

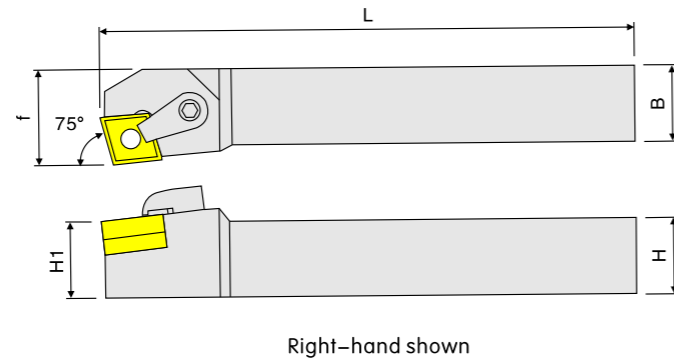
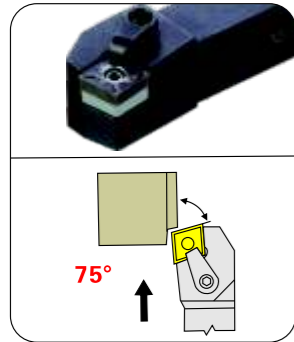

Item code	Dimensions,mm					Insert	Pin	Shim	Wrench	Screw	Clamp	Wrench
	H	B	L	H1	f							
MCKNR/L-1616K-12	16	16	125	16	10	CN..1204..	MLP46	CMS432	PL25	MS625	MC620	PL30
MCKNR/L-2020K-12	20	20	125	20	25					MS630		
MCKNR/L-2525M-12	25	25	150	25	32					MS630		
MCKNR/L-3232P-12	32	32	170	32	40					MS630		

MCLN

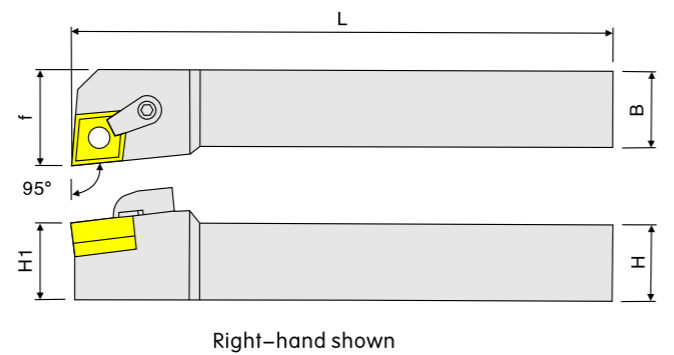
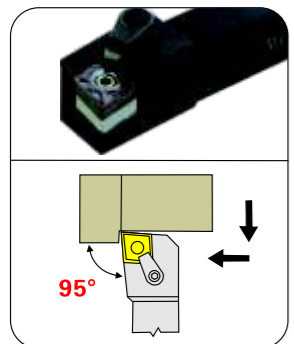

Item code	Dimensions,mm					Insert	Pin	Shim	Wrench	Screw	Clamp	Wrench
	H	B	L	H1	f							
MCLNR/L-1616K-12	16	16	125	16	20	CN..1204..	MLP46	CMS432	PL25	MS625	MC620	PL30
MCLNR/L-2020K-12	20	20	125	20	25					MS630		
MCKNR/L-2525M-12	25	25	150	25	32					MS630		
MCKNR/L-3232P-12	32	32	170	32	40					MS630		

MDJN

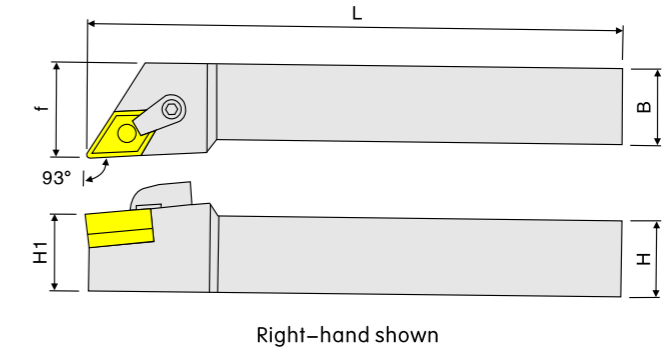
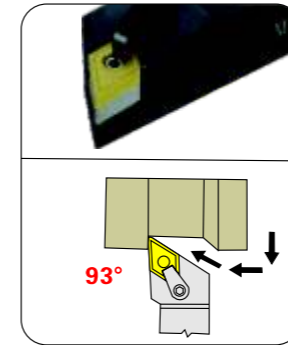

Item code	Dimensions,mm					Insert	Pin	Shim	Wrench	Screw	Clamp	Wrench
	H	B	L	H1	f							
MDJNR/L-2020K-15	20	20	125	20	25	DN..1504..	MLP46L	DMS442	PI25	MS625	MC622	PL30
MDJNR/L-2525M-15	25	25	150	25	32					MS630		
MDJNR/L-2020K-1506	20	20	125	20	25	DN..1506..	MLP46L	DMS432	PI25	MS625	MC622	PL30
MDJNR/L-2525M-1506	25	25	150	25	32					MS630		

MTQN

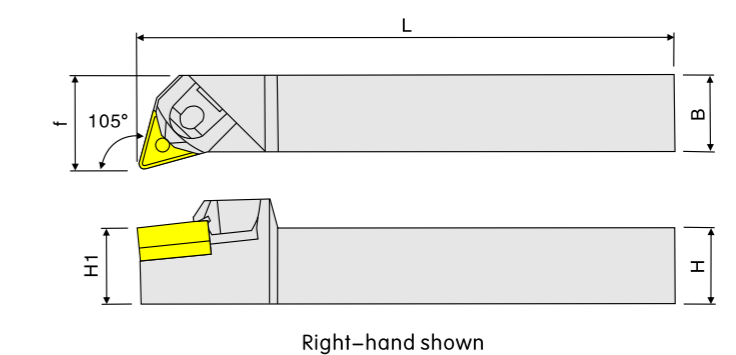
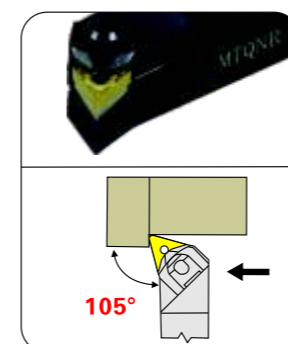

Item code	Dimensions,mm					Insert	Pin	Screw	Wrench	Shim	Clamp	Wrench
	H	B	L	H1	f							
MTQNR/L-2020K-16	20	20	125	20	25	TN..1604..	MCP3	MCS3S-11	PL30	TWS322	MCW3-P40	PL40
MTQNR/L-2525M-16	25	25	150	25	32							

U 鑽系列
high speed drills
Indexable inserts

鏜刀系列
Boring Head

刀柄系列
Chuck

銑刀系列
Milling System

頂尖系列
Centre

車刀系列
Turning Tools

合金系列
Carbide insert

非標定做
Customized Products

U 鑽系列
high speed drills
Indexable inserts

鏜刀系列
Boring Head

刀柄系列
Chuck

銑刀系列
Milling System

頂尖系列
Centre

車刀系列
Turning Tools

合金系列
Carbide insert

非標定做
Customized Products

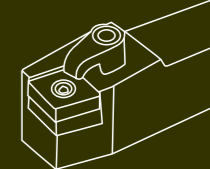

MTJN

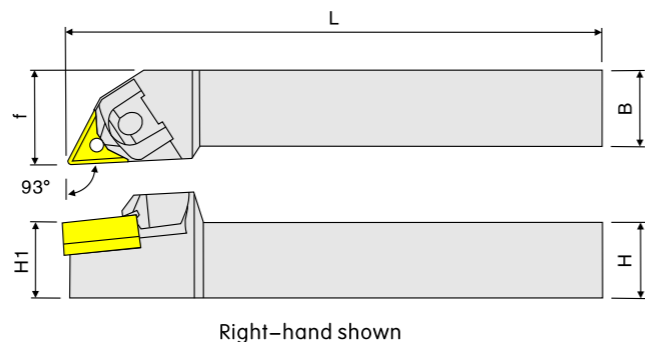
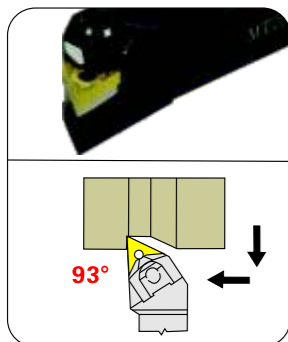

Item code	Dimensions,mm					Insert	Pin	Screw	Wrench	Shim	Clamp	Wrench
	H	B	L	H1	f							
MTJNR/L-1216K-16	12	16	125	16	21	TN..1604..	MCP3	MCS3S-11	PL30	TWS322	MCW3-P40	PL40
MTJNR/L-1616K-16	16	16	125	16	21							
MTJNR/L-2020K-16	20	20	125	20	25							
MTJNR/L-2525M-16	25	25	150	25	32							
MTJNR/L-3232P-16	32	32	170	32	40							

MTFN

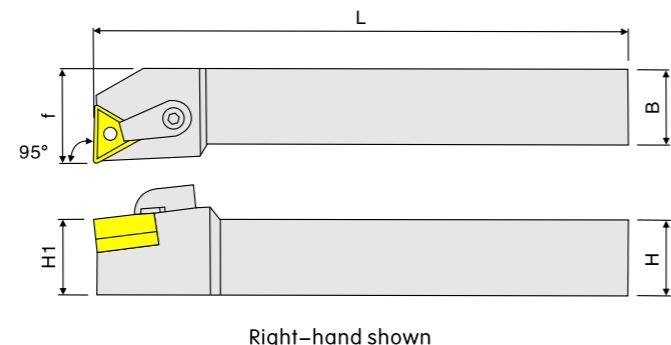
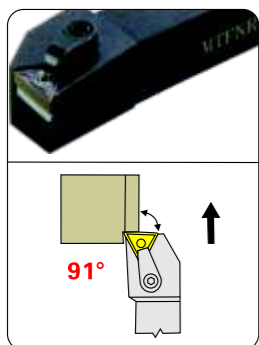

Item code	Dimensions,mm					Insert	Pin	Shim	Wrench	Screw	Clamp	Wrench
	H	B	L	H1	f							
MTFNR-1616K-16	16	16	125	16	20	TN..1604..	MLP34L	TMS322	PL20	MS625	MC620	PL40
MTFNR-2020K-16	20	20	125	20	25					MS630		
MTFNR-2525M-16	25	25	150	25	32							

MVJN

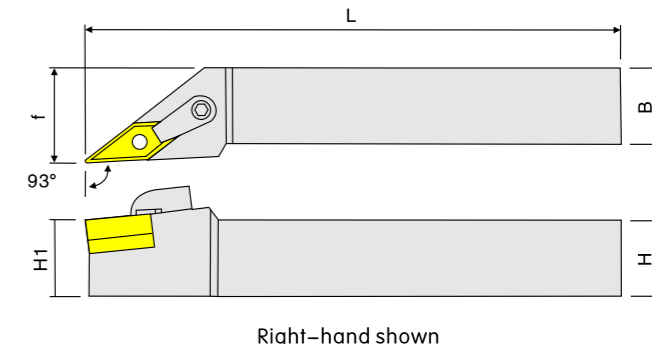
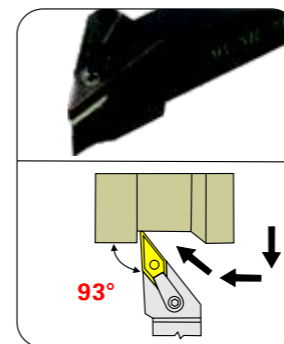

Item code	Dimensions,mm					Insert	Pin	Shim	Wrench	Screw	Clamp	Wrench
	H	B	L	H1	f							
MVJNR/L-1616K-16	16	16	125	16	21	VN..1604..	MLP34L	VMS322	PL20	MS625	MC622	PL30
MVJNR/L-2020K-16	20	20	125	20	25					MS630		
MVJNR/L-2525M-16	25	25	150	25	32							

MVQN

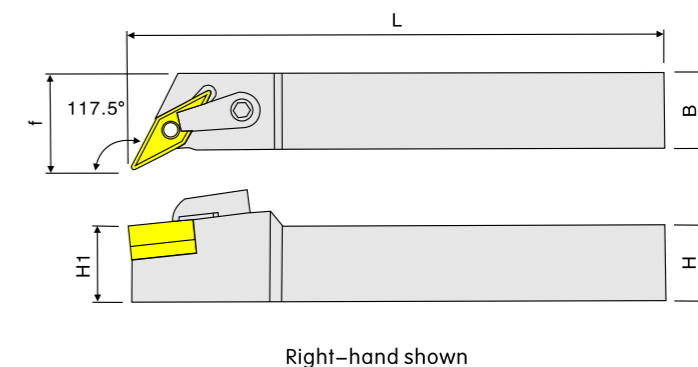
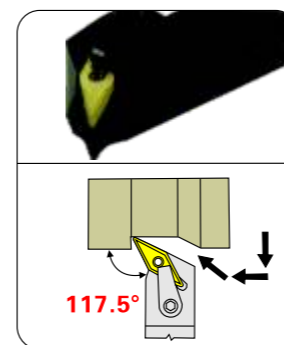

Item code	Dimensions,mm					Insert	Pin	Shim	Wrench	Screw	Clamp	Wrench
	H	B	L	H1	f							
MVQNR/L-2020K-16	20	20	125	20	25	VN..1604..	MLP34L	VMS322	PL20	MS625	MC622	PL30
MVQNR/L-2525M-16	25	25	150	25	32					MS630		

U 鑽系列
high speed drills
Indexable inserts

鏜刀系列
Boring Head

刀柄系列
Chuck

銑刀系列
Milling System

頂尖系列
Centre

車刀系列
Turning Tools

合金系列
Carbide insert

非標定做
Customized Products

U 鑽系列
high speed drills
Indexable inserts

鏜刀系列
Boring Head

刀柄系列
Chuck

銑刀系列
Milling System

頂尖系列
Centre

車刀系列
Turning Tools

合金系列
Carbide insert

非標定做
Customized Products

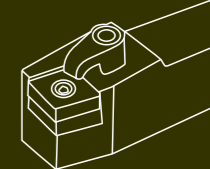

MVVN

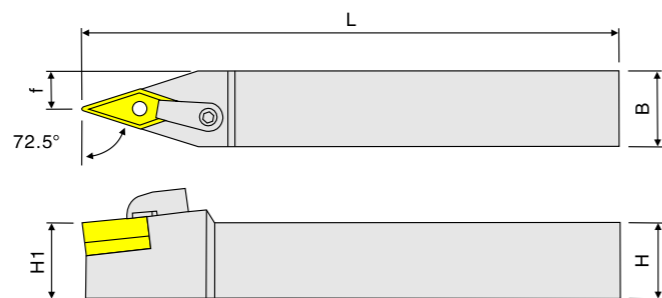
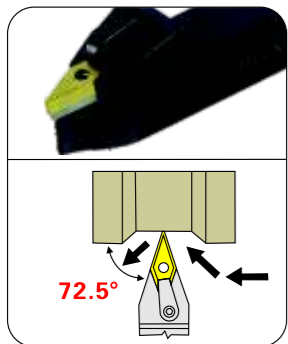

Item code	Dimensions,mm					Insert	Pin	Shim	Wrench	Screw	Clamp	Wrench
	H	B	L	H1	f							
MVVNN-2020K-16	20	20	125	20	10	VN..1604..	MLP34L	VMS322	PL20	MS625	MC622	PL30
MVVNN-2525M-16	25	25	150	25	12.5					MS630		

WWLN

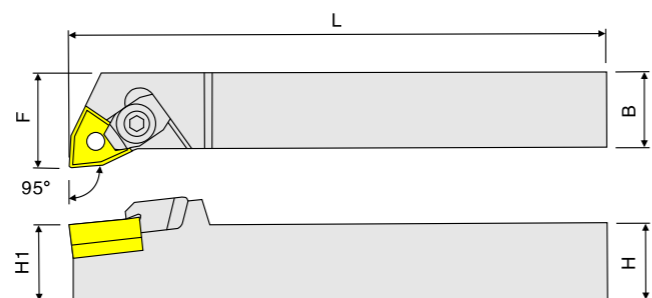
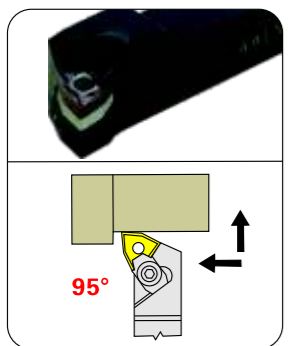

Right-hand showd

Item code	Dimensions,mm					Insert	Pin	Shim	Wrench	Clamp	Wrench
	H	B	L	H1	f						
WWLNL-2020K-08	20	20	125	20	25	WN..0804..	SCP418	WMS432	PL30	WCW6-P4	PL40
WWLNL-2525M-08	25	25	150	25	32						

Item code	Dimensions,mm					Insert	Pin	Screw	Wrench	Shim	Clamp	Wrench
	H	B	L	H1	f							
WWLNR-2020K-08	20	20	125	20	25	WN..0804..	MCP4	MCS3S-08	PL30	WMS432	WCW6-P4	PL40
WWLNR-2525M-08	25	25	150	25	32							

MWLN

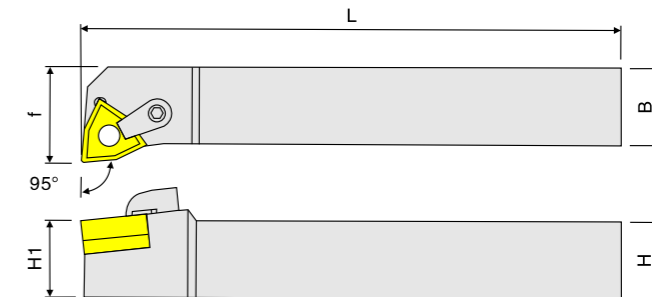
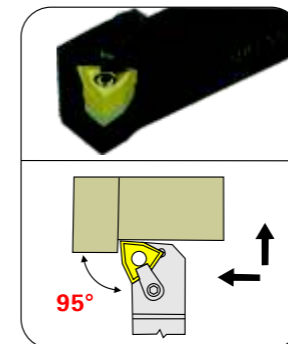

Right-hand shown

Item code	Dimensions,mm					Insert	Pin	Shim	Wrench	Screw	Clamp	Wrench
	H	B	L	H1	f							
MWLN/L-2020K-08	20	20	125	20	25	WN..0804..	MLP46	WMS432	PL25	MS625	MC620	PL30
MWLN/L-2525M-08	25	25	150	25	32					MS630		

SCLC

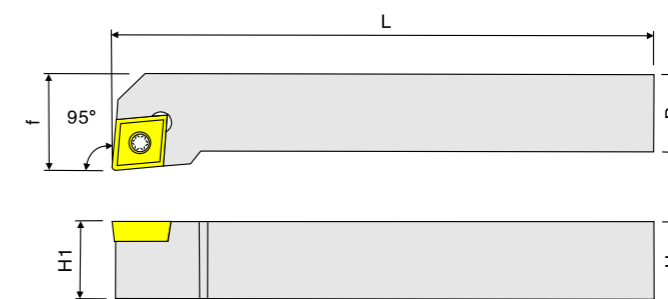
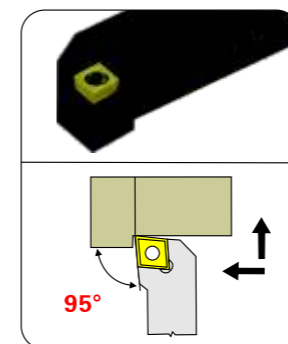

Right-hand shown

Item code	Dimensions,mm					Insert	Screw	Wrench
	H	B	L	H1	f			
SCLCR/L-1212H-09	12	12	100	12	16	CC..09T3..	MS4011A	TF15
SCLCR/L-1212K-09	12	12	125	12	16			
SCLCR/L-1616K-09	16	16	125	16	20			
SCLCR/L-2020K-09	20	20	125	20	25			
SCLCR/L-2525M-09	25	25	150	25	32			
SCLCR/L-2020K-12	20	20	125	20	25	CC..1204..	MS5011A	TF20
SCLCR/L-2525M-12	25	25	150	25	32			

U 鑽系列
high speed drills
Indexable inserts

鏜刀系列
Boring Head

刀柄系列
Chuck

銑刀系列
Milling System

頂尖系列
Centre

車刀系列
Turning Tools

合金系列
Carbide insert

非標定做
Customized Products

U 鑽系列
high speed drills
Indexable inserts

鏜刀系列
Boring Head

刀柄系列
Chuck

銑刀系列
Milling System

頂尖系列
Centre

車刀系列
Turning Tools

合金系列
Carbide insert

非標定做
Customized Products

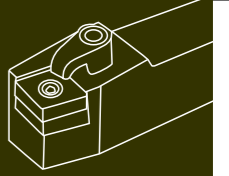

SDJC

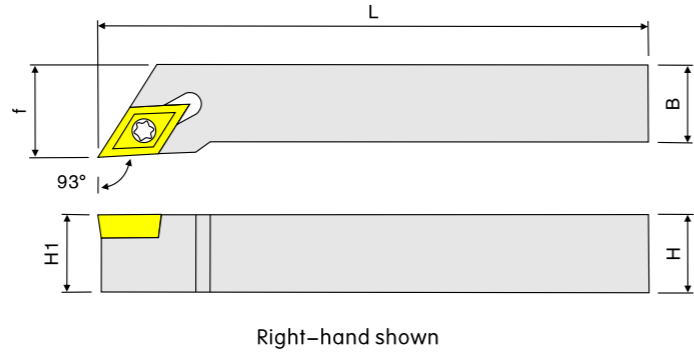
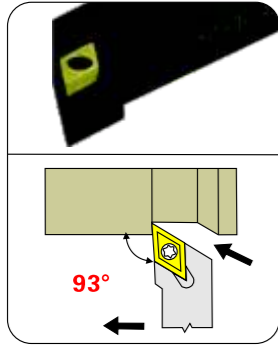

Item code	Dimensions,mm					Insert	Screw	Wrench
	H	B	L	H1	f			
SDJCR/L-1616K-H07	16	16	125	16	20	DC..0702..	MS2506A	TF9
SDJCR/L-2020K-H07	20	20	125	20	25			
SDJCR/L-1616K-H11	16	16	125	16	20	DC..11T3..	MS4009A	TF15
SDJCR/L-2020K-H11	20	20	125	20	25			

SVQB/C

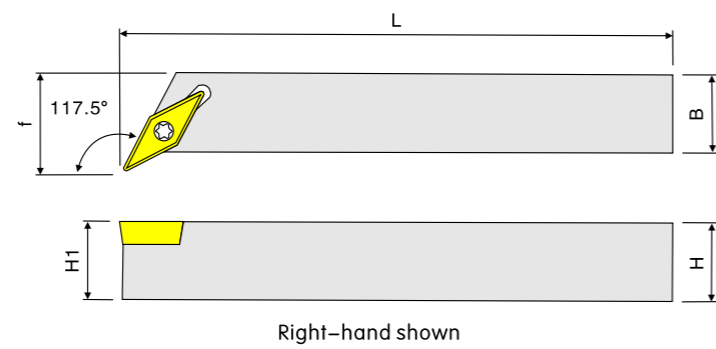
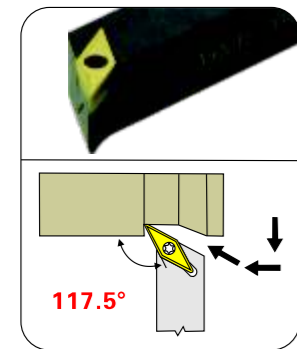

Item code	Dimensions,mm					Insert	Shim	Screw	Wrench	Screw	Wrench
	H	B	L	H1	f						
SVQBR/L-1212H-11	12	12	100	12	16	VB..1103..	--	--	--	MS2506B	TF9
SVQBR/L-1616K-11	16	16	125	16	20						
SVQBR/L-2020K-11	20	20	125	20	25	VB..1604..	VSS322	MDS5035	PL35	MS3512B	TF15
SVQBR/L-2020K-16	20	20	125	20	25						
SVQBR/L-2525M-16	25	25	150	25	32	VC..1103..	--	--	--	MS2506B	TF9
SVQCR/L-1212H-11	12	12	100	12	16						
SVQCR/L-1616K-11	16	16	125	16	20	VC..1103..	--	--	--	MS2506B	TF9
SVQCR/L-2020K-11	20	20	125	20	25						
SVQCR/L-2020K-16	20	20	125	20	25	VC..1604..	VSS322	MDS5035	PL35	MS3512B	TF15
SVQCR/L-2525M-16	25	25	150	25	32						

SDQC

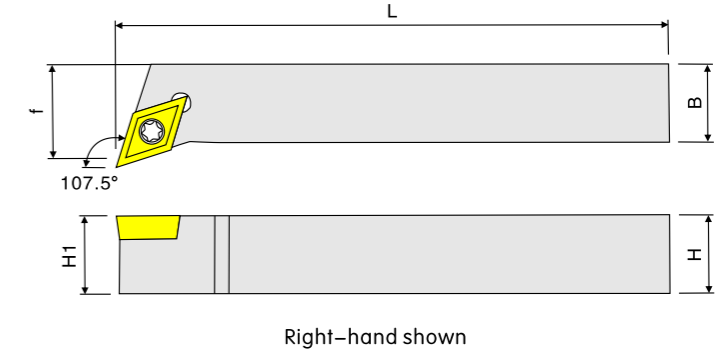
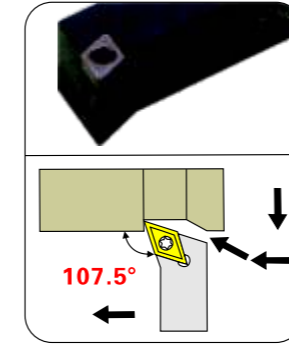

Item code	Dimensions,mm					Insert	Screw	Wrench
	H	B	L	H1	f			
SDQCR/L-1212H-11	12	12	100	12	16	DC..11T3..	MS4009A	TF15
SDQCR/L-1616K-11	16	16	125	16	20			
SDQCR/L-2020K-11	20	20	125	20	25			
SDQCR/L-2525M-11	25	25	150	25	32			

SVJB/C

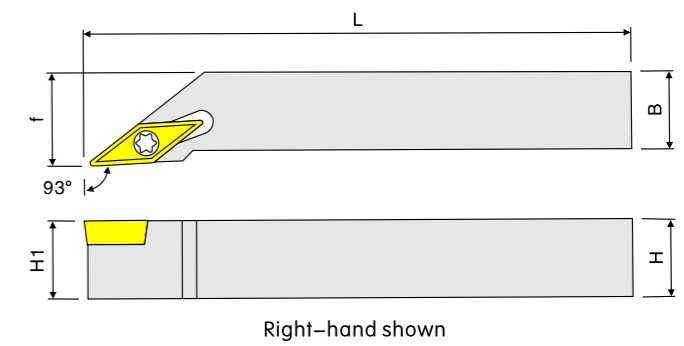
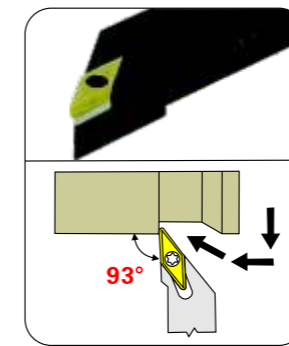

Item code	Dimensions,mm					Insert	Shim	Screw	Wrench	Screw	Wrench
	H	B	L	H1	f						
SVJBR/L-1010H-11	10	10	100	10	12	VB..1103..	--	--	--	MS2506B	TF9
SVJBR/L-1212K-11	12	12	125	12	16						
SVJBR/L-1616K-11	16	16	125	16	20						
SVJBR/L-2020K-11	20	20	125	20	25						
SVJBR/L-2525M-11	25	25	150	25	32	VB..1604..	VSS322	MDS5035	PL35	MS3512B	TF15
SVJBR/L-1616K-16	16	16	125	16	20						
SVJBR/L-2020K-16	20	20	125	20	25						
SVJBR/L-2525M-16	25	25	150	25	32						
SVJCR/L-1010H-11	10	10	100	10	12	VC..1103..	--	--	--	MS2506B	TF9
SVJCR/L-1212K-11	12	12	125	12	16						
SVJCR/L-1616K-11	16	16	125	16	20						
SVJCR/L-2020K-11	20	20	125	20	25						
SVJCR/L-2525M-11	25	25	150	25	32	VC..1604..	VSS322	MDS5035	PL35	MS3512B	TF15
SVJCR/L-1616K-16	16	16	120	16	20						
SVJCR/L-2020K-16	20	20	125	20	25						
SVJCR/L-2525M-16	25	25	150	25	32						

U 鑽系列
高速度鑽
可換鑽頭
鑽刀系列
鏜刀系列
刀柄系列
銑刀系列
頂尖系列
車刀系列
合金系列
非標定做

U 鑽系列
高速度鑽
可換鑽頭
鑽刀系列
鏜刀系列
刀柄系列
銑刀系列
頂尖系列
車刀系列
合金系列
非標定做

External grooving tool holder
外徑切槽刀

YOUN/O

External grooving tool holder
外徑切槽刀

YOUN/O

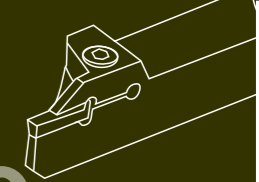

DGH

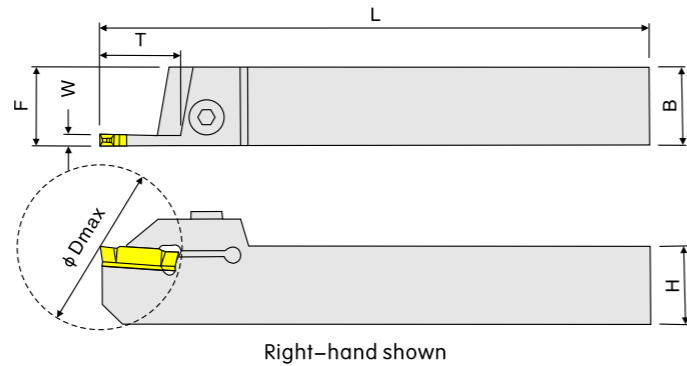
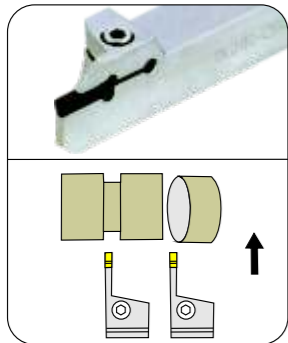

Item code	Dimensions,mm					Width W(mm)	Insert	Screw	Wrench
	H	B	L	F	T				
DGHR/L-1616K-2-20L	16	16	125	16.3	20	2.0	DGM20CE	HTM525	PL40
DGHR/L-2020K-2-20L	20	20	125	20.3					
DGHR/L-1616K-3-16L	16	16	125	16.3	16	3.0	DGM30CT		
DGHR/L-2020K-3-16L	20	20	125	20.3					
DGHR/L-2525M-3-16L	25	25	150	25.3	20	3.0	DGM30CT		
DGHR/L-1616K-3-20L	16	16	125	16.3					
DGHR/L-2020K-3-20L	20	20	125	20.3	25	3.0	DGM30CE		
DGHR/L-2525M-3-20L	25	25	150	25.3					
DGHR/L-1616K-3-25L	16	16	125	16.3	25	3.0	DGM30CE		
DGHR/L-2020K-3-25L	20	20	125	20.3					
DGHR/L-2525M-3-25L	25	25	150	25.3	20	4.0	DGM40CT		
DGHR-3232P-3-25L	32	32	170	32.3					
DGHR/L-1616K-4-20L	16	16	125	16.3	25	4.0	DGG40CE		
DGHR/L-2020K-4-20L	20	20	125	20.3					
DGHR/L-2525M-4-20L	25	25	150	25.3	25	4.0	DGG40CE		
DGHR/L-1616K-4-25L	16	16	125	16.3					
DGHR/L-2020K-4-25L	20	20	125	20.3	25	5.0	DGM50CT		
DGHR/L-2525M-4-25L	25	25	150	25.3					
DGHR-3232P-4-25L	32	32	170	32.3	25	5.0	DGM50CT		
DGHR/L-1616K-5-25L	16	10	125	16.3					
DGHR/L-2020K-5-25L	20	20	125	20.3	25	5.0	DGM50CT		
DGHR/L-2525M-5-25L	25	25	150	25.3					

GYM

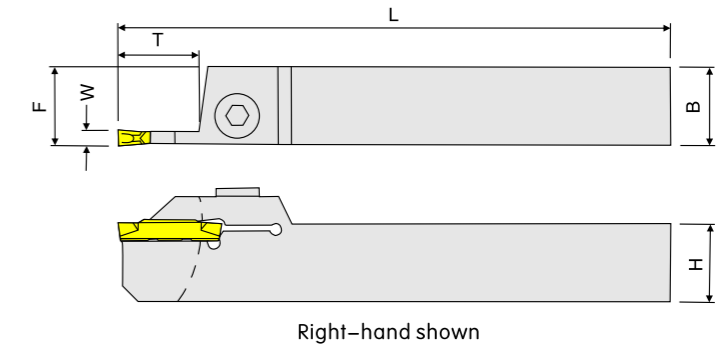
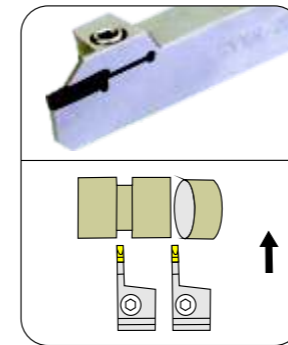

Item code	Dimensions,mm					Width W(mm)	Insert	Screw	Wrench
	H	B	L	F	T				
GYMR-2020K-3-20L	20	20	125	20.3	20	3.0	GY2M03..F.	HTM625	PL50
GYMR-2525M-3-20L	25	25	150	25.3					
GYMR-2020K-4-20L	20	20	125	20.3	20	4.0	GY2M04..G.		
GYMR-2525M-4-20L	25	25	150	25.3					
GYMR-2020K-5-20L	20	20	125	20.4	20	5.0	GY2M05..H.		
GYMR-2525M-5-20L	25	25	150	25.4					

KTKH

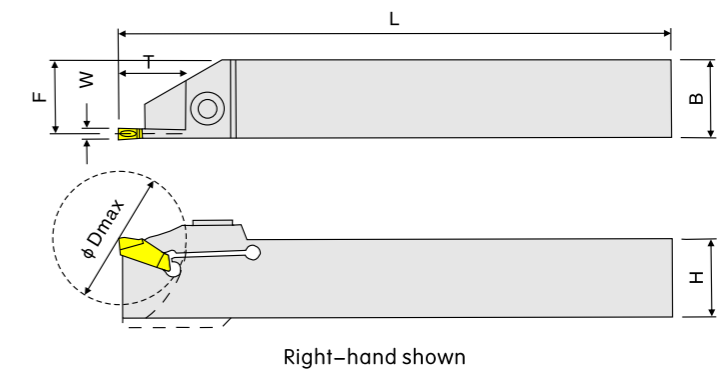
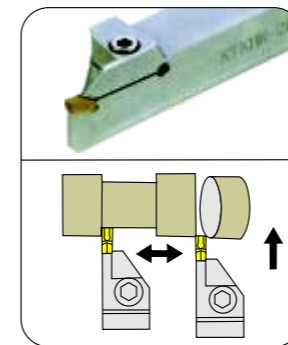

Item code	Dimensions,mm					Width W(mm)	Insert	Screw	Wrench
	H	B	L	F	T				
KTKHR-1212M-2-13L	12	12	150	11.1	13	2.2 2.4	TKN2 TKN2.4	HTM520	PL40
KTKHR-1616K-2-13L	16	16	125	15.1					
KTKHR-2020K-2-13L	20	20	125	19.1					
KTKHR-2525M-2-13L	25	25	150	24.1	20	3.1	TKN3	HTM520	PL40
KTKHR-1616K-2-20L	16	16	125	15.1					
KTKHR-2020K-2-20L	20	20	125	19.1	16	3.1	TKN3	HTM520	PL40
KTKHR-2525M-2-20L	25	25	150	24.1					
KTKHR-2020K-3-16L	20	20	125	18.8	16	3.1	TKN3	HTM520	PL40
KTKHR-2525M-3-16L	25	25	150	23.8					
KTKHR-1616K-3-22L	16	16	125	14.8	22	3.1	TKN3	HTM520	PL40
KTKHR-2020K-3-22L	20	20	125	18.8					
KTKHR-2525M-3-22L	25	25	150	23.8	27	3.1	TKN3	HTM520	PL40
KTKHR-2020K-3-27L	20	20	125	18.8					
KTKHR-2525M-3-27L	25	25	150	23.8					

U 鑽系列
high speed drills
Indexable inserts

鏜刀系列
Boring Head

刀柄系列
Chuck

銑刀系列
Milling System

頂尖系列
Centre

車刀系列
Turning Tools

合金系列
Carbide insert

非標定做
Customized Products

U 鑽系列
high speed drills
Indexable inserts

鏜刀系列
Boring Head

刀柄系列
Chuck

銑刀系列
Milling System

頂尖系列
Centre

車刀系列
Turning Tools

合金系列
Carbide insert

非標定做
Customized Products

External grooving tool holder
外徑切槽刀

YOUN/O

External grooving tool holder
外徑切槽刀

YOUN/O

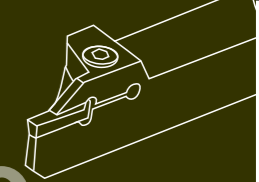

KGM

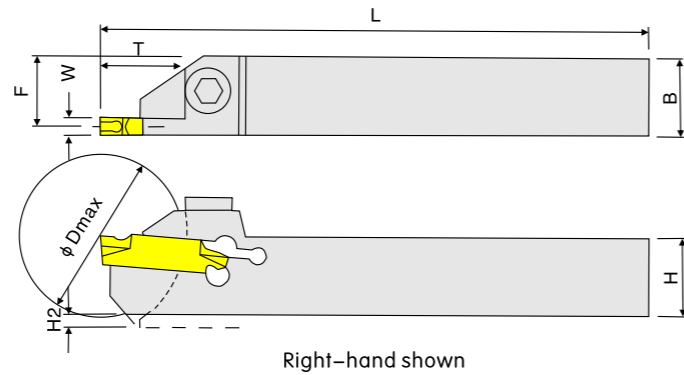
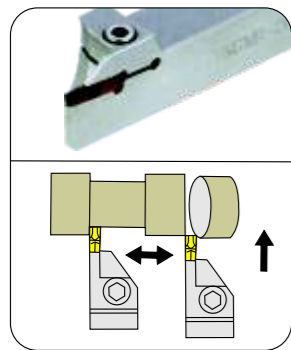

Item code	Dimensions,mm					Width W(mm)		Insert	Screw	Wrench
	H	B	L	F	T	min	max			
KGMR/L-1212K-1.5-L10	12	12	125	11.4	10	1.5	2.0	GMM1520... GMM2020...	HTM416	PL30
KGMR/L-2020K-1.5-L10	16	16	125	15.4					HTM520	PL40
KGMR/L-2020K-1.5-L10	20	20	125	19.4					HTM525	PL40
KGMR/L-2525M-1.5-L10	25	25	150	24.4						
KGMR/L-1212K-2T-L10	12	12	125	11.1	10	2.0	3.0	GMM2020... GMM2520... GMM3020...	HTM416	PL30
KGMR/L-1616K-2T-L10	16	16	125	15.1					HTM520	PL40
KGMR/L-2020K-2T-L10	20	20	125	19.1					HTM525	PL40
KGMR/L-2525M-2T-L10	25	25	150	24.1						
KGMR/L-1212K-2T-L13	12	12	125	11.1	13	2.0	3.0	GMM2020... GMM2520... GMM3020...	HTM520	PL40
KGMR/L-1616K-2T-L13	16	16	125	15.1						
KGMR/L-2020K-2T-L13	20	20	125	19.1						
KGMR/L-2525M-2T-L13	25	25	150	24.1						
KGMR/L-1212K-2T-L17	12	12	125	11.1	17	3.0	4.0	GMM3020... GMM4020...	HTM525	PL40
KGMR/L-1616K-2T-L17	16	16	125	15.1						
KGMR/L-2020K-2T-L17	20	20	125	19.1						
KGMR/L-2525M-2T-L17	25	25	150	24.1						
KGMR/L-1616K-3T-L16	16	16	125	14.8	16	3.0	4.0	GMM3020... GMM4020...	HTM520	PL40
KGMR/L-2020K-3T-L16	20	20	125	18.8						
KGMR/L-2525M-3T-L16	25	25	150	23.8						
KGMR/L-1616K-3T-L20	16	16	125	14.8						
KGMR/L-2020K-3T-L20	20	20	125	18.8	20	4.0	5.0	GMM4020... GMM5020...	HTM525	PL40
KGMR/L-2525M-3T-L20	25	25	150	23.8						
KGMR-3232P-3T-L20	30	32	170	30.8						
KGMR-2020K-4T-L20	20	20	125	18.3						
KGMR/L-2525M-4T-L20	25	25	150	23.3	20	5.0	6.0	GMM5020... GMM6020...	HTM525	PL40
KGMR/L-3232P-4T-L20	32	32	170	30.3						
KGMR/L-2525M-5T-L20	25	25	150	22.8						
KGMR-3232P-5T-L20	32	32	170	29.8						

DGF

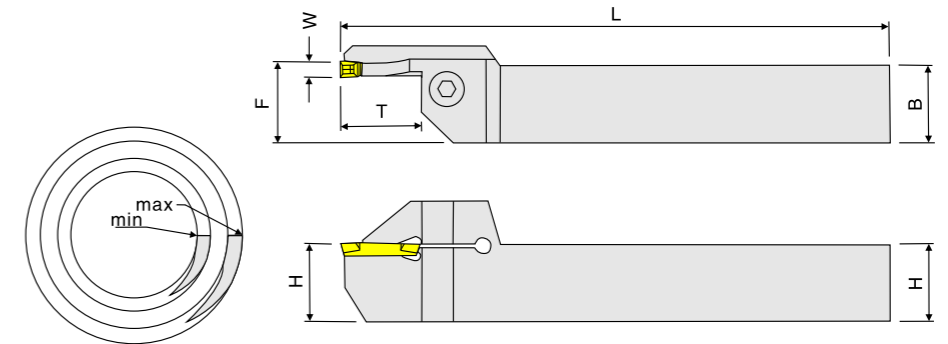
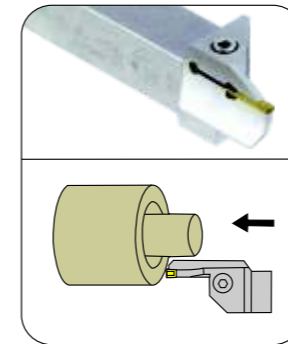

Item code	Dimensions,mm						Hole Diameter ϕD		Insert	Screw	Wrench
	H	B	L	F	W	T	min	max			
DGFR-20-22-3T15	20	20	125	21	3	15	22	34	DGM30CTF	HTM525	PL40
DGFR-20-34-3T15							34	45			
DGFR-20-45-3T20							45	70			
DGFR-20-70-3T20							70	100			
DGFR-20-100-3T20	20	20	125	21	3	20	100	140	DGM30CTF	HTM525	PL40
SGFR-20-140-3T20							140	200			
DGFR-20-200-3T20							200	800			
DGFR-25-22-3T15							22	34			
DGFR-25-34-3T15	25	25	150	26	3	15	34	45	DGM30CTF	HTM525	PL40
DGFR-25-45-3T15							45	70			
DGFR-25-45-3T20							45	70			
DGFR-25-70-3T20							70	100			
DGFR-25-100-3T20	25	25	150	26	3	20	100	140	DGM30CTF	HTM525	PL40
DGFR-25-140-3T20							140	200			
DGFR-25-200-3T20							200	800			
DGFR-20-22-4T15							22	34			
DGFR-20-34-4T20	20	20	125	21	4	15	34	45	DGM40CTF	HTM525	PL40
DGFR-20-45-4T20							45	70			
DGFR-20-70-4T20							70	100			
DGFR-20-100-4T20							100	140			
DGFR-20-140-4T20	20	20	125	21	4	20	140	200	DGM40CTF	HTM525	PL40
DGFR-20-200-4T20							200	800			
DGFR-20-70-4T25							70	100			
DGFR-20-100-4T25							100	140			
DGFR-20-140-4T25	20	20	125	21	4	25	140	200	DGN40CTF	HTM525	PL40
DGFR-20-200-4T25							200	800			
DGFR-25-22-4T15							22	34			
DGFR-25-34-4T20							34	45			
DGFR-25-45-4T20	25	25	150	26	4	20	45	70	DGM40CTF	HTM525	PL40
DGFR-25-70-4T20							70	100			
DGFR-25-100-4T20							100	140			
DGFR-25-140-4T20							140	200			
DGFR-25-200-4T20	25	25	150	26	4	25	200	800	DGM40CTF	HTM525	PL40
DGFR-25-70-4T25							70	100			
DGFR-25-100-4T25							100	140			
DGFR-25-140-4T25							140	200			
DGFR-25-200-4T25	25	25	150	26	4	25	200	800	DGM40CTF	HTM525	PL40
DGFR-25-70-4T25							70	100			
DGFR-25-100-4T25							100	140			
DGFR-25-140-4T25							140	200			

U 鑽系列
high speed drills
Indexable inserts

鏜刀系列
Boring Head

刀柄系列
Chuck

銑刀系列
Milling System

頂尖系列
Centre

車刀系列
Turning Tools

合金系列
Carbide insert

非標定做
Customized Products

U 鑽系列
high speed drills
Indexable inserts

鏜刀系列
Boring Head

刀柄系列
Chuck

銑刀系列
Milling System

頂尖系列
Centre

車刀系列
Turning Tools

合金系列
Carbide insert

非標定做
Customized Products

Internal grooving tool holder
內徑切槽刀

YOUN/O

Internal grooving tool holder
內徑切槽刀

YOUN/O

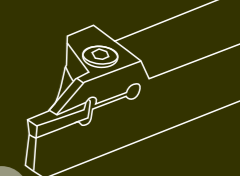

DGIR

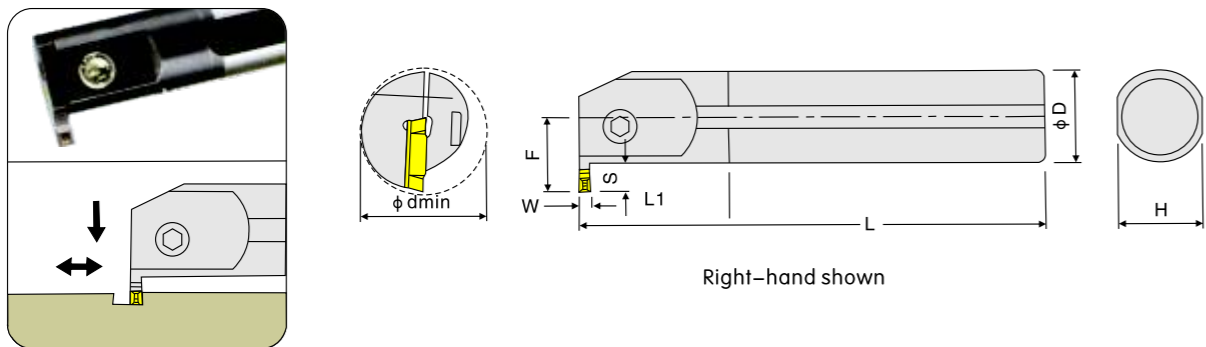

Item code	Dimensions,mm							Insert	Screw	Wrench
	D	L	L1	F	dmin	S	W			
DGIR-0020Q-3M-6.5L	20	180	40	16.5	31	6.5	3	DGM30CT	HTM520	PL40
DGIR-0025R-3M-7.5L	25	200	40	20	37	7.5				
DGIR-0032S-3M-9.0L	32	250	48	25	46	9.0				
DGIR-0020Q-4M-6.5L	20	180	40	16.5	31	6.5	4	DGM40CT	HTM520	PL40
DGIR-0025R-4M-7.5L	20	200	40	20	37	7.5				
DGIR-0032S-4M-9.0L	25	250	48	25	46	9.0				
DGIR-0032S-5-17.5L	32	250	48	33.5	55	17.5	5	DGM50CT	HTM520	PL40
DGIR-0040S-5-20L	40	250	48	40	65	20				

FSL51

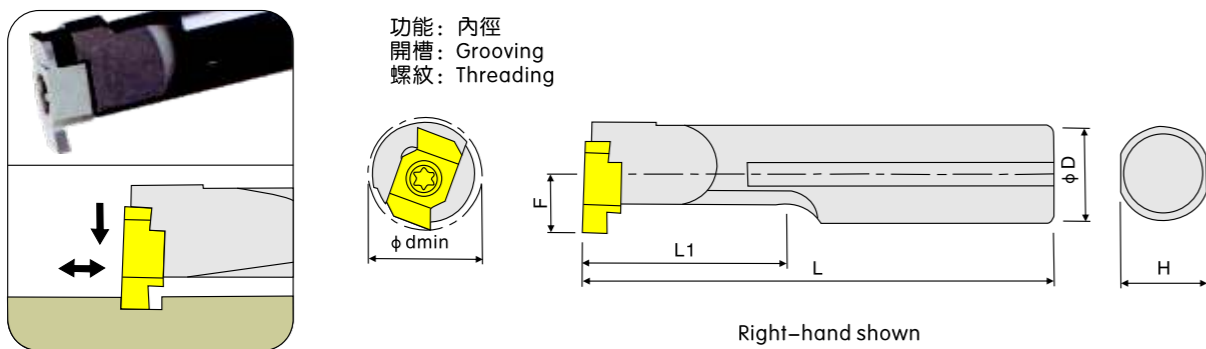

Item code	Dimensions,mm						Insert			Screw	Wrench
	D	L	L1	F	dmin	槽加工	螺紋加工	鏜孔加工			
FSL5108R	8	125	25	4.8	10	MLG10..L	MLT1001L	MLP1004L	MS2506A	TF9	
FSL5110R	10	125	25	5.8	12	MLG14..L	MLT1401L	MLP1404L	MS3008A	TF9	
FSL5112R	12	150	36	6.8	14						
FSL5114R	14	150	36	7.8	16						
FSL5116R	16	180	50	9.7	20	MLG20..L	MLT2001L	MLP2004L	MS4011A	TF15	
FSL5120R	20	200	50	11.7	24						

GIVR

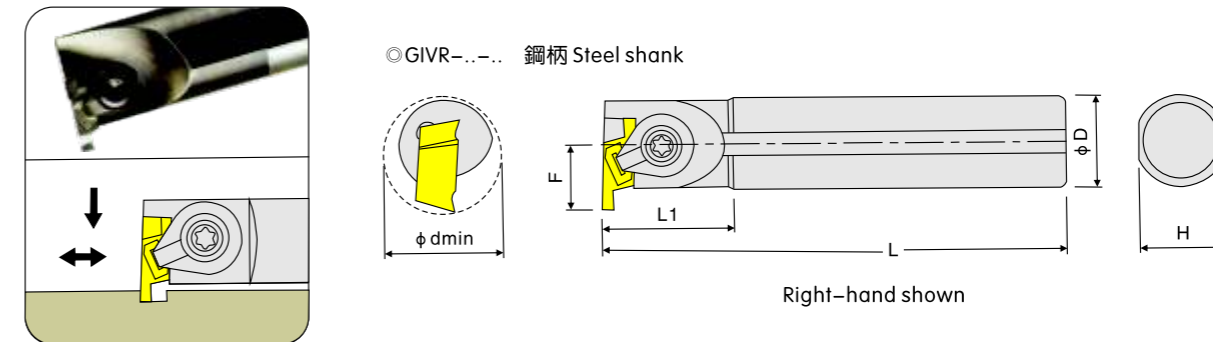

Item code	Dimensions,mm						Insert	Screw	Wrench
	D	L	L1	F	dmin				
GIVR-1108K-1SS	8	125	20	7	11	GVR ₀₀₀ SS	GVR100SS-300SS	CPS4V	TF10
GIVR-1310K-1S	10	125	25	8	13	GVR ₀₀₀ S	GVR100S-340S	CPS5F	TF15
GIVR-1512M-1A	12	150	30	9	15	GVR ₀₀₀ A	GVR100A-340A		
GIVR-2016Q-1A	16	180	35	11	20	GVR ₀₀₀ B	GVR145B-400B	CPS5V	TF15
GIVR-2520R-1B	20	200	40	14	25				
GIVR-3225R-1C	25	200	40	19.5	32				
GIVR-4032S-1C	32	250	48	23	40	GVR ₀₀₀ C	GVR280C-500C	CPS6V	TF30
GIVR-4032S-2C	32	250	48	23	40	GVR ₀₀₀ SS	GVR100SS-300SS	CPS4V	TF10
GIVR-A1108K-1SS	8	125	20	7	11				
GIVR-A1310K-1S	10	125	25	8	13	GVR ₀₀₀ S	GVR100S-340S	CPS5F	TF15
GIVR-A1512M-1A	12	150	30	9	15	GVR ₀₀₀ A	GVR100A-340A		
GIVR-A2016Q-1A	16	180	35	11	20	GVR ₀₀₀ B	GVR145B-400B	CPS5V	TF15
GIVR-A2520R-1B	20	200	40	14	25				
GIVR-A3225R-1C	25	200	40	19.5	32				
GIVR-A4032S-1C	32	250	48	23	40	GVR ₀₀₀ C	GVR280C-500C	CPS6V	PL30
GIVR-A4032S-2C	32	250	48	23	40				

GIVR

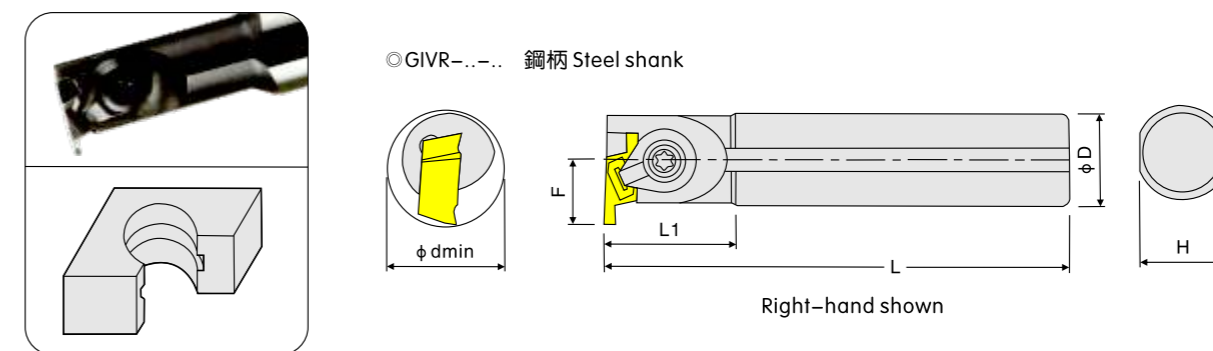

Item code	Dimensions,mm						Insert	Screw	Wrench
	D	L	L1	F	dmin				
GIVR-1116L-1SS	16	140	20	7	11	GVR ₀₀₀ SS	GVR100SS-300SS	CPS4V	TF10
GIVR-1316L-1S	16	140	25	8	13	GVR ₀₀₀ S	GVR100SS-340S	CPS5F	TF15
GIVR-1516L-1A	16	140	30	9	15	GVR ₀₀₀ A	GVR100A-340A	CPS5F	TF15
GIVR-A1116L-1SS	16	140	20	7	11	GVR ₀₀₀ SS	GVR100SS-300SS	CPS4V	TF10
GIVR-A1316L-1S	16	140	25	8	13	GVR ₀₀₀ S	GVR100S-340S	CPS5F	TF15
GIVR-A1516L-1A	16	140	30	9	15	GVR ₀₀₀ A	GVR100A-340A	CPS5F	TF15

U 鑽系列
high speed drills
Indexable inserts

鏜刀系列
Boring Head

刀柄系列
Chuck

銑刀系列
Milling System

頂尖系列
Centre

車刀系列
Turning Tools

合金系列
Carbide insert

非標定做
Customized Products

U 鑽系列
high speed drills
Indexable inserts

鏜刀系列
Boring Head

刀柄系列
Chuck

銑刀系列
Milling System

頂尖系列
Centre

車刀系列
Turning Tools

合金系列
Carbide insert

非標定做
Customized Products

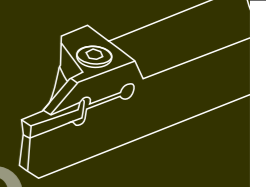

SNR/L

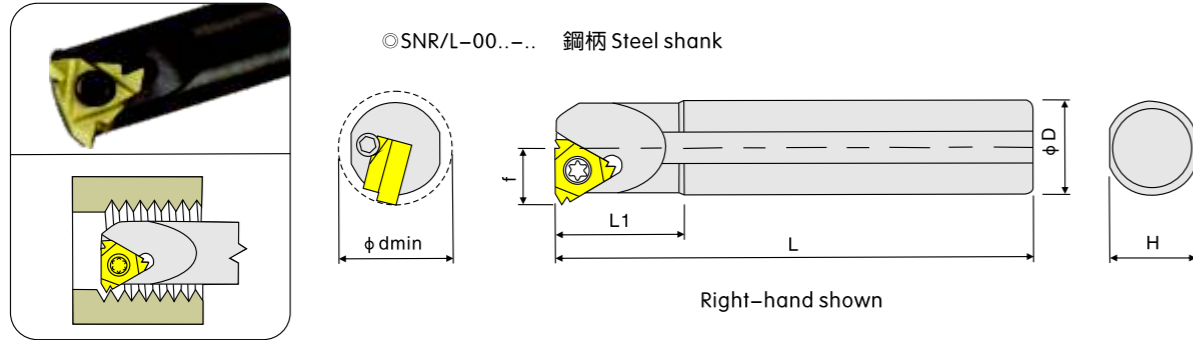

Item code	Dimensions,mm					Insert	Screw	Wrench	Shim	Screw	Wrench
	D	L	L1	f	dim						
SNR/L-0010K-11-S10	10	125	25	6.5	13	11NR/L..	MS2507G	TF8	--	--	--
SNR/L-0012M-11-S12	12	150	32	8.0	16						
SNR/L-0016Q-16	16	180	36	10	19	16NR/L..	MS3509A	TF15	GXN/E16	HTM309	PL25
SNR/L-0020R-16	20	200	40	12	24						
SNR/L-0025R-16	25	200	45	14.5	29						
SNR/L-0032S-16	32	250	45	18.5	36						
SNR/L-0025S-22	25	250	45	16.5	32	22NR/L..	MS4516A	TF20	--	--	--
SNR/L-0032S-22	32	250	45	20	40		MS2206A	TF20			

SNR/L

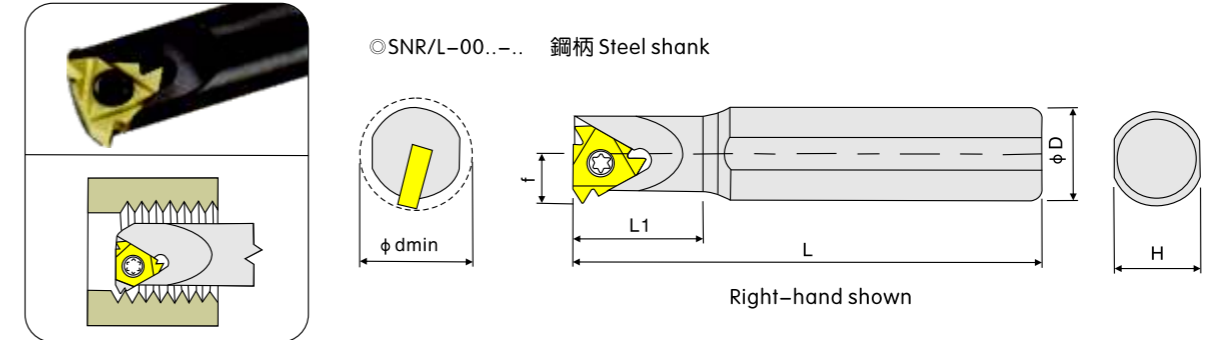

Item code	Dimensions,mm					Insert	Screw	Wrench	Shim	Screw	Wrench
	D	L	L1	f	dim						
SNR/L-0010K-11	16	125	25	6.5	13	11R/L..	MS2507G	TF8	--	--	--
SNR/L-0013M-16	16	150	32	8.5	17	16R/L..	MS3509A	TF15			
SNR-0016Q-16-S20	20	150	36	10	19						

SER/L

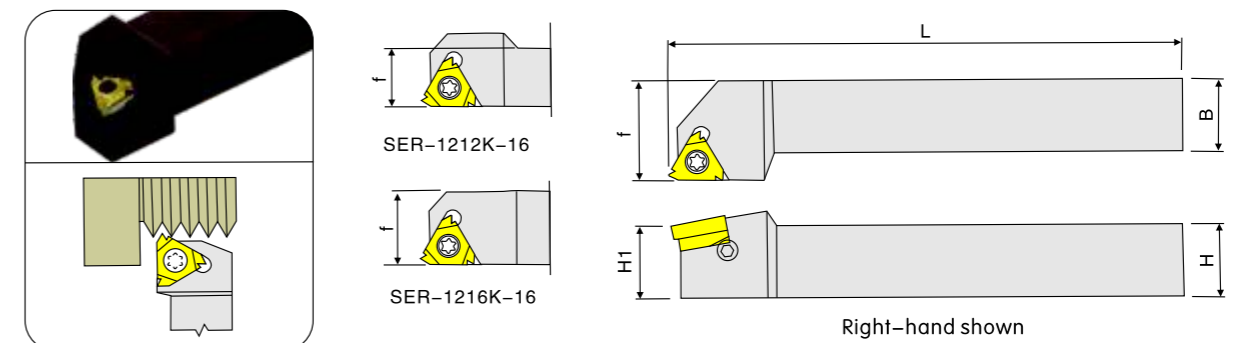

Item code	Dimensions,mm					Insert	Screw	Wrench	Shim	Screw	Wrench
	H	B	L	H1	f						
SER/L-1616K-16	16	16	125	16	20	16ER/L..	MS3512A	TF15	GXN/E16	HTM309	PL25
SER/L-2020K-16	20	20	125	20	25						
SER/L-2525M-16	25	25	150	25	32						

U 鑽系列 high speed drills
Indexable inserts
鏜刀系列 Boring Head
刀柄系列 Chuck
銑刀系列 Milling System
頂尖系列 Centre
車刀系列 Turning Tools
合金系列 Carbide insert
非標定做 Customized Products

U 鑽系列 high speed drills
Indexable inserts
鏜刀系列 Boring Head
刀柄系列 Chuck
銑刀系列 Milling System
頂尖系列 Centre
車刀系列 Turning Tools
合金系列 Carbide insert
非標定做 Customized Products



CN□□ (負角型)

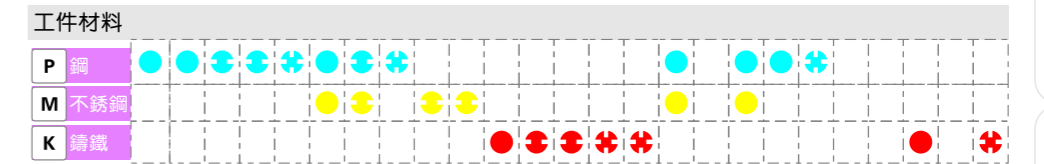
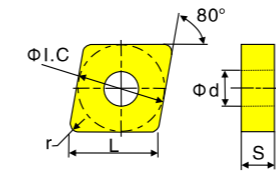

刀片外形 Charp	型號 Specification	塗層硬質合金 Carbidecoatwg							金屬陶瓷				硬質合金 Carbide															
		TBC1015	TBC1025	TBC2015	TBC2025	TBC3015	TBM2015	TBM3015	TBM5025	TBD1015	TBD1025	TBD2025	TBD3025	TBG1025	TBG2025	TBX1035	TBX2035	TBX3035	T10	TP10	P01	P03	K01	K25	M25	M3501		
粗加工 For roughing	CNMG090304-TR		★	★	○			★	○		★	○			★													
	CNMG090308-TR		★	★	○			★	○		★	○			★													
	CNMG120404-TR		★	★	○			★	○		★	○			★													
	CNMG120408-TR		★	★	○			★	○		★	○			★													
	CNMG120412-TR		★	★	○			★	○		★	○			★													
	CNMG120416-TR		★	★	○			★	○		★	○			★													
	CNMG160608-TR		★	★	○			★	○		★	○			★													
	CNMG160612-TR		★	★	○			★	○		★	○			★													
	CNMG160616-TR		★	★	○			★	○		★	○			★													
	CNMG190608-TR		★	★	○			★	○		★	○			★													
	CNMG190612-TR		★	★	○			★	○		★	○			★													
CNMG190616-TR		★	★	○			★	○		★	○			★														
通用槽 All round	CNMG090304-TM		★	★	○			★	○		★	○			★													
	CNMG090308-TM		★	★	○			★	○		★	○			★													
	CNMG120404-TM		★	★	○			★	○		★	○			★													
	CNMG120408-TM		★	★	○			★	○		★	○			★													
	CNMG120412-TM		★	★	○			★	○		★	○			★													
	CNMG120416-TM		★	★	○			★	○		★	○			★													
	CNMG160608-TM		★	★	○			★	○		★	○			★													
	CNMG160612-TM		★	★	○			★	○		★	○			★													
	CNMG160616-TM		★	★	○			★	○		★	○			★													
	CNMG190608-TM		★	★	○			★	○		★	○			★													
	CNMG190612-TM		★	★	○			★	○		★	○			★													
CNMG190616-TM		★	★	○			★	○		★	○			★														

★主推牌號 ○通用牌號

U 鑽系列
High speed drills
Indexable inserts

鏜刀系列
Boring Head

刀柄系列
Chuck

銑刀系列
Milling System

頂尖系列
Centre

車刀系列
Turning Tools

合金系列
Carbide insert

非標定做
Customized Products



DN□□ (負角型)

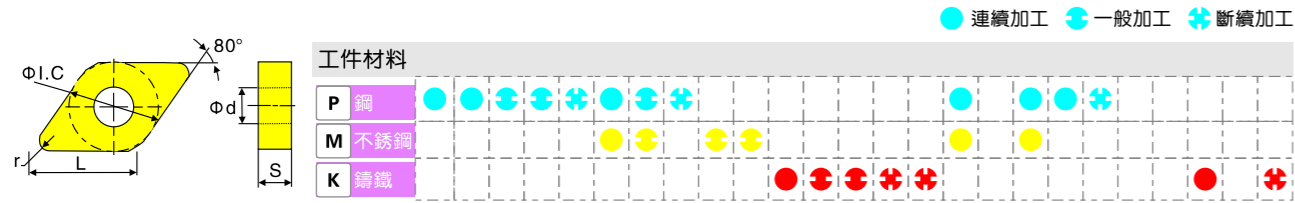

刀片外形 Charp	型號 Specification	塗層硬質合金 Carbidecoatwg										金屬陶瓷		硬質合金 Carbide												
		TBC1015	TBC1025	TBC2015	TBC2025	TBC3015	TBM2015	TBM3015	TBM5025	TBD1015	TBD1025	TBD2025	TBD3025	TBG1025	TBG2025	TBX1035	TBX2035	TBX3035	TI0	TP10	P01	P03	K01	K25	M25	M3501
精加工 For finishing	DNMG110404-LM	★	○				★	○			★	○					★	★	★							
	DNMG110408-LM	★	○				★	○			★	○					★	★	★							
	DNMG110412-LM			★	○		★	○			★	○					★	★	★							
	DNMG150404-LM	★	○				★	○			★	○					★	★	★							
	DNMG150408-LM	★	○				★	○			★	○					★	★	★							
	DNMG150412-LM			★	○		★	○			★	○					★	★	★							
	DNMG150604-LM	★	○				★	○			★	○					★	★	★							
	DNMG150608-LM	★	○				★	○			★	○					★	★	★							
	DNMG150612-LM			★	○		★	○			★	○					★	★	★							
粗加工 For roughing	DNMG110404-TR	★	○				★	○			★	○				★	★	★								
	DNMG110408-TR	★	○				★	○			★	○				★	★	★								
	DNMG110412-TR			★	○		★	○			★	○				★	★	★								
	DNMG150404-TR	★	○				★	○			★	○				★	★	★								
	DNMG150408-TR	★	○				★	○			★	○				★	★	★								
	DNMG150412-TR			★	○		★	○			★	○				★	★	★								
	DNMG150604-TR	★	○				★	○			★	○				★	★	★								
	DNMG150608-TR	★	○				★	○			★	○				★	★	★								
	DNMG150612-TR			★	○		★	○			★	○				★	★	★								
通用槽 All round	DNMG110404-TM			★	○		★	○			★	○				★	★	★								
	DNMG110408-TM			★	○		★	○			★	○				★	★	★								
	DNMG110412-TM			★	○		★	○			★	○				★	★	★								
	DNMG150404-TM			★	○		★	○			★	○				★	★	★								
	DNMG150408-TM			★	○		★	○			★	○				★	★	★								
	DNMG150412-TM			★	○		★	○			★	○				★	★	★								
	DNMG150604-TM			★	○		★	○			★	○				★	★	★								
	DNMG150608-TM			★	○		★	○			★	○				★	★	★								
	DNMG150612-TM			★	○		★	○			★	○				★	★	★								

★主牌號 ○通用牌號

SN□□ (負角型)

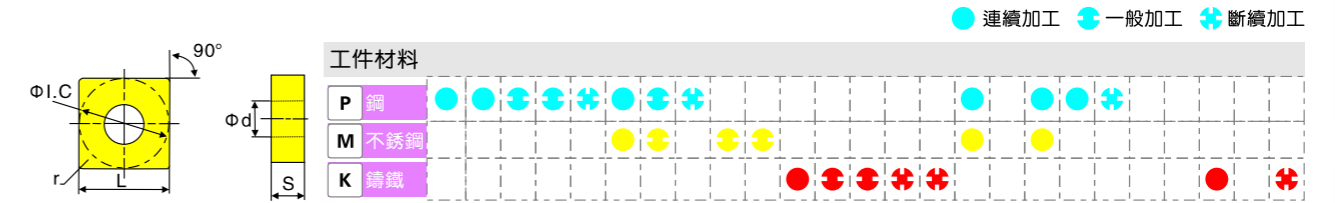

刀片外形 Charp	型號 Specification	塗層硬質合金 Carbidecoatwg										金屬陶瓷		硬質合金 Carbide													
		TBC1015	TBC1025	TBC2015	TBC2025	TBC3015	TBM2015	TBM3015	TBM5025	TBD1015	TBD1025	TBD2025	TBD3025	TBG1025	TBG2025	TBX1035	TBX2035	TBX3035	TI0	TP10	P01	P03	K01	K25	M25	M3501	
精加工 半精加工 For finishing For semi-finishing	SNMG090304-SL	★	○				★	○			★	○				★	★	★									
	SNMG090308-SL	★	○				★	○			★	○				★	★	★									
	SNMG090312-SL	★	○				★	○			★	○				★	★	★									
	SNMG120404-SL	★	○				★	○			★	○				★	★	★									
	SNMG120408-SL	★	○				★	○			★	○				★	★	★									
	SNMG120412-SL	★	○				★	○			★	○				★	★	★									
	SNMG150608-SL	★	○				★	○			★	○				★	★	★									
	SNMG150612-SL	★	○				★	○			★	○				★	★	★									
	SNMG090304-DZ	★	○				★	○			★	○				★	★	★									
精加工 半精加工 For finishing For semi-finishing	SNMG090308-DZ	★	○				★	○			★	○				★	★	★									
	SNMG090312-DZ	★	○				★	○			★	○				★	★	★									
	SNMG120404-DZ	★	○				★	○			★	○				★	★	★									
	SNMG120408-DZ	★	○				★	○			★	○				★	★	★									
	SNMG120412-DZ	★	○				★	○			★	○				★	★	★									
	SNMG150608-DZ	★	○				★	○			★	○				★	★	★									
	SNMG150612-DZ	★	○				★	○			★	○				★	★	★									
	SNMG090304-TR		★	★	○		★	○			★	○				★	★	★									
	粗加工 For roughing	SNMG090308-TR		★	★	○		★	○			★	○			★	★	★									
SNMG090312-TR			★	★	○		★	○			★	○			★	★	★										
SNMG120404-TR			★	★	○		★	○			★	○			★	★	★										
SNMG120408-TR			★	★	○		★	○			★	○			★	★	★										
SNMG120412-TR			★	★	○		★	○			★	○			★	★	★										
SNMG150608-TR			★	★	○		★	○			★	○			★	★	★										
SNMG150612-TR			★	★	○		★	○			★	○			★	★	★										

★主牌號 ○通用牌號

U 鑽系列
Boring 刀系列
Chuck 刀柄系列
Milling 銑刀系列
Centre 頂尖系列
Turning 車刀系列
Carbide 合金系列
Customized 非標定做

U 鑽系列
Boring 刀系列
Chuck 刀柄系列
Milling 銑刀系列
Centre 頂尖系列
Turning 車刀系列
Carbide 合金系列
Customized 非標定做



TN□□ (負角型)

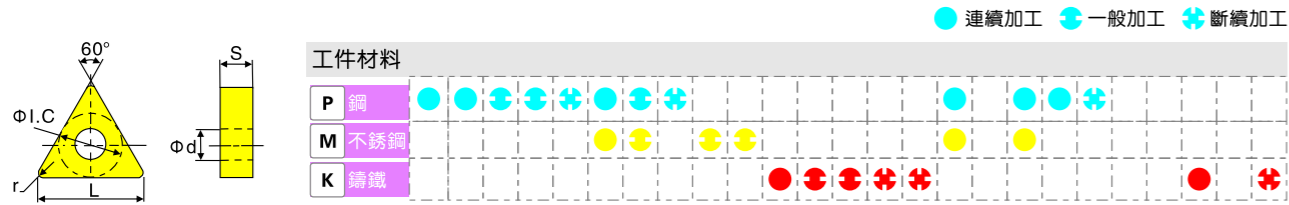

刀片外形 Charp	型號 Specification	塗層硬質合金 Carbidecoatwg										金屬陶瓷			硬質合金 Carbide												
		TBC1015	TBC1025	TBC2015	TBC2025	TBC3015	TBM2015	TBM3015	TBM5025	TBD1015	TBD1025	TBD2025	TBD3025	TBG1025	TBG2025	TBX1035	TBX2035	TBX3035	TI0	TP10	P01	P03	K01	K25	M25	M3501	
精加工 半精加工 For finishing For semi-finishing	TNMG110304-PR			★	★	○		★	○			★	○				★										
	TNMG110308-PR			★	★	○		★	○			★	○				★										
	TNMG160404-PR			★	★	○		★	○			★	○				★										
	TNMG160408-PR			★	★	○		★	○			★	○				★										
	TNMG160412-PR			★	★	○		★	○			★	○				★										
	TNMG220408-PR			★	★	○		★	○			★	○				★										
	TNMG220412-PR			★	★	○		★	○			★	○				★										
通用槽 All round	TNMG110304-TM			★	★	○		★	○			★	○				★										
	TNMG110308-TM			★	★	○		★	○			★	○				★										
	TNMG160404-TM			★	★	○		★	○			★	○				★										
	TNMG160408-TM			★	★	○		★	○			★	○				★										
	TNMG160412-TM			★	★	○		★	○			★	○				★										
	TNMG220408-TM			★	★	○		★	○			★	○				★										
	TNMG220412-TM			★	★	○		★	○			★	○				★										
通用槽 All round	TNMG110304-TV			★	★	○		★	○			★	○				★										
	TNMG110308-TV			★	★	○		★	○			★	○				★										
	TNMG160404-TV			★	★	○		★	○			★	○				★										
	TNMG160408-TV			★	★	○		★	○			★	○				★										
	TNMG160412-TV			★	★	○		★	○			★	○				★										
	TNMG220408-TV			★	★	○		★	○			★	○				★										
	TNMG220412-TV			★	★	○		★	○			★	○				★										

★ 主推牌號 ○ 通用牌號

WN□□ (負角型)

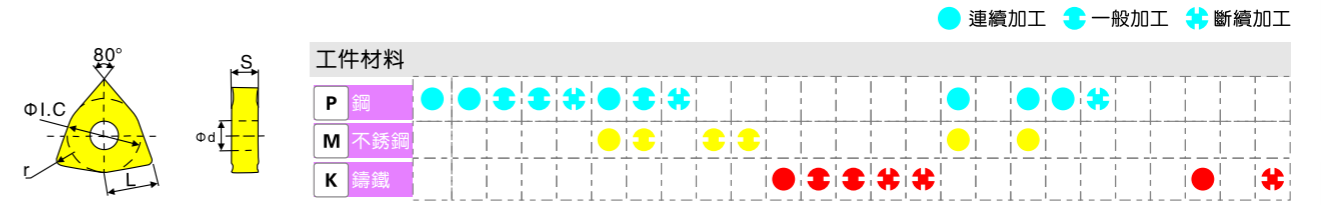

刀片外形 Charp	型號 Specification	塗層硬質合金 Carbidecoatwg										金屬陶瓷			硬質合金 Carbide												
		TBC1015	TBC1025	TBC2015	TBC2025	TBC3015	TBM2015	TBM3015	TBM5025	TBD1015	TBD1025	TBD2025	TBD3025	TBG1025	TBG2025	TBX1035	TBX2035	TBX3035	TI0	TP10	P01	P03	K01	K25	M25	M3501	
精加工 半精加工 For finishing For semi-finishing	WNMG06T304-SL		★	○						★	○			★	○						★	★	★				
	WNMG06T308-SL		★	○						★	○			★	○							★	★	★			
	WNMG06T312-SL		★	○						★	○			★	○							★	★	★			
	WNMG060404-SL		★	○						★	○			★	○							★	★	★			
	WNMG060408-SL		★	○						★	○			★	○							★	★	★			
	WNMG060412-SL		★	○						★	○			★	○							★	★	★			
	WNMG080404-SL		★	○						★	○			★	○							★	★	★			
精加工 半精加工 For finishing For semi-finishing	WNMG080408-SL		★	○					★	○			★	○							★	★	★				
	WNMG080412-SL			★	★	○			★	○			★	○	○						★						
	WNMG06T304-DZ		★	○						★	○			★	○							★	★	★			
	WNMG06T308-DZ		★	○						★	○			★	○							★	★	★			
	WNMG06T312-DZ			★	★	○				★	○			★	○	○						★					
	WNMG060404-DZ		★	○						★	○			★	○							★	★	★			
	WNMG060408-DZ		★	○						★	○			★	○							★	★	★			
粗加工 For roughing	WNMG060412-DZ			★	★	○			★	○			★	○	○						★						
	WNMG080404-DZ		★	○					★	○			★	○							★	★	★				
	WNMG080408-DZ		★	○					★	○			★	○							★	★	★				
	WNMG080412-DZ			★	★	○			★	○			★	○	○						★						
	WNMG100608-DZ		★	○						★	○			★	○							★	★	★			
	WNMG100612-DZ			★	★	○			★	○			★	○	○						★						
	WNMG060408-TR		★	○						★	○			★	○							★	★	★			
粗加工 For roughing	WNMG060412-TR			★	★	○			★	○			★	○	○						★						
	WNMG080404-TR		★	○					★	○			★	○							★	★	★				
	WNMG080408-TR		★	○					★	○			★	○							★	★	★				
	WNMG080412-TR			★	★	○			★	○			★	○	○						★						
	WNMG100608-TR		★	○						★	○			★	○							★	★	★			
	WNMG100612-TR			★	★	○			★	○			★	○	○						★						
	WNMG100612-TR			★	★	○			★	○			★	○	○						★						

★ 主推牌號 ○ 通用牌號

U 鑽系列
Boring Head
Chuck
Milling System
Centre
Turning Tools
Carbide insert
Customized Products

U 鑽系列
Boring Head
Chuck
Milling System
Centre
Turning Tools
Carbide insert
Customized Products



CC□□ (正角型)

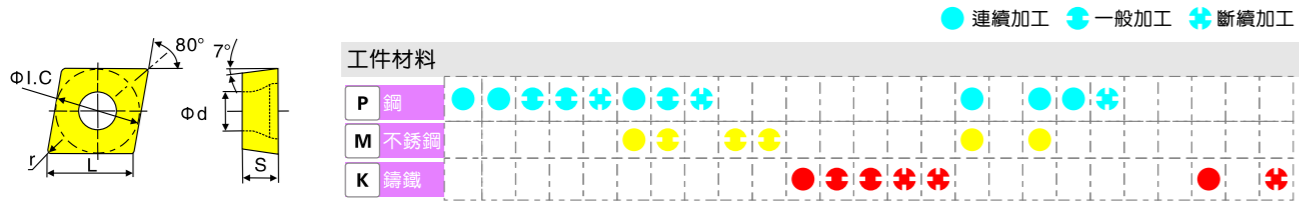

刀片外形 Charp	型號 Specification	塗層硬質合金 Carbidecoatwg											金屬 陶瓷		硬質合金 Carbide													
		TBC1015	TBC1025	TBC2015	TBC2025	TBC3015	TBM2015	TBM3015	TBM5025	TBD1015	TBD1025	TBD2025	TBD3025	TBG1025	TBG2025	TBX1035	TBX2035	TBX3035	TI0	TP10	P01	P03	K01	K25	M25	M3501		
精加工 半精加工 For finishing For semi-finishing	CCMT060202-TF	★	○			★	○			★	○			○		★		★	★									
	CCMT060204-TF	★	○			★	○			★	○			○		★		★	★									
	CCMT060208-TF	★	○			★	○			★	○			○		★		★	★									
	CCMT09T302-TF	★	○			★	○			★	○			○		★		★	★									
	CCMT09T304-TF	★	○			★	○			★	○			○		★		★	★									
	CCMT120404-TF	★	○			★	○			★	○			○		★		★	★									
	CCMT120408-TF	★	○			★	○			★	○			○		★		★	★									
CCMT120412-TF		★	★	○		★	○			★	○	○			★													
粗加工 For roughing	CCMT060208-TR	★	○			★	○			★	○			○		★		★	★									
	CCMT09T304-TR	★	○			★	○			★	○			○		★		★	★									
	CCMT09T308-TR	★	○			★	○			★	○			○		★		★	★									
	CCMT120404-TR	★	○			★	○			★	○			○		★		★	★									
	CCMT120408-TR	★	○			★	○			★	○			○		★		★	★									
	CCMT120412-TR		★	★	○		★	○			★	○	○			★												
	CCMT160508-TR	★	○			★	○			★	○			○		★		★	★									
CCMT160512-TR		★	★	○		★	○			★	○	○			★													
粗加工 For roughing	CCMT060208-ZR	★	○			★	○			★	○			○		★		★	★									
	CCMT09T304-ZR	★	○			★	○			★	○			○		★		★	★									
	CCMT09T308-ZR	★	○			★	○			★	○			○		★		★	★									
	CCMT120404-ZR	★	○			★	○			★	○			○		★		★	★									
	CCMT120408-ZR		★	★	○		★	○			★	○	○			★												
	CCMT120412-ZR		★	★	○		★	○			★	○	○			★												
	CCMT160508-ZR		★	★	○		★	○			★	○	○			★												
CCMT160512-ZR		★	★	○		★	○			★	○	○			★													

★主推牌號 ○通用牌號

DC□□ (正角型)

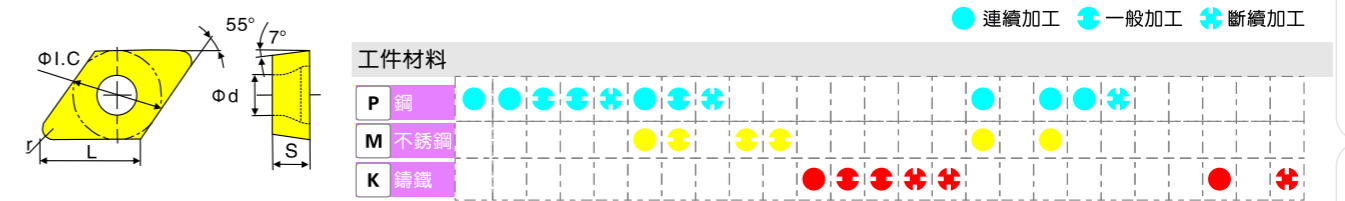

刀片外形 Charp	型號 Specification	塗層硬質合金 Carbidecoatwg											金屬 陶瓷		硬質合金 Carbide												
		TBC1015	TBC1025	TBC2015	TBC2025	TBC3015	TBM2015	TBM3015	TBM5025	TBD1015	TBD1025	TBD2025	TBD3025	TBG1025	TBG2025	TBX1035	TBX2035	TBX3035	TI0	TP10	P01	P03	K01	K25	M25	M3501	
精加工 半精加工 For finishing For semi-finishing	DCMT070202-TF	★	○			★	○			★	○			○		★		★	★								
	DCMT070204-TF	★	○			★	○			★	○			○		★		★	★								
	DCMT070208-TF	★	○			★	○			★	○			○		★		★	★								
	DCMT11T302-TF	★	○			★	○			★	○			○		★		★	★								
	DCMT11T304-TF	★	○			★	○			★	○			○		★		★	★								
	DCMT11T308-TF	★	○			★	○			★	○			○		★		★	★								
粗加工 For roughing	DCMT070202-TR	★	○			★	○			★	○			○		★		★	★								
	DCMT070204-TR	★	○			★	○			★	○			○		★		★	★								
	DCMT070208-TR		★	★	○		★	○			★	○	○			★											
	DCMT11T302-TR	★	○			★	○			★	○			○		★		★	★								
	DCMT11T304-TR	★	○			★	○			★	○			○		★		★	★								
	DCMT11T308-TR		★	★	○		★	○			★	○	○			★											
通用槽 All round	DCMT070202-TM	★	○			★	○			★	○			○		★		★	★								
	DCMT070204-TM	★	○			★	○			★	○			○		★		★	★								
	DCMT070208-TM		★	★	○		★	○			★	○	○			★											
	DCMT11T302-TM	★	○			★	○			★	○			○		★		★	★								
	DCMT11T304-TM	★	○			★	○			★	○			○		★		★	★								
	DCMT11T308-TM		★	★	○		★	○			★	○	○			★											
無槽 without chipbreaker	DCGW070202	★	○			★	○			★	○			○		★		★	★								
	DCGW070204	★	○			★	○			★	○			○		★		★	★								
	DCGW070208		★	★	○		★	○			★	○	○			★											
	DCGW11T302	★	○			★	○			★	○			○		★		★	★								
	DCGW11T304	★	○			★	○			★	○			○		★		★	★								
	DCGW11T308		★	★	○		★	○			★	○	○			★											

★主推牌號 ○通用牌號

U 鑽系列
Boring Head
Chuck
Milling System
Centre
Turning Tools
Carbide insert
Customized Products

U 鑽系列
Boring Head
Chuck
Milling System
Centre
Turning Tools
Carbide insert
Customized Products

CARBIDE

普通車削刀片/硬質合金及金屬陶瓷刀片



CARBIDE

普通車削刀片/硬質合金及金屬陶瓷刀片

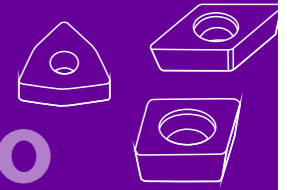

SC□□ (正角型)

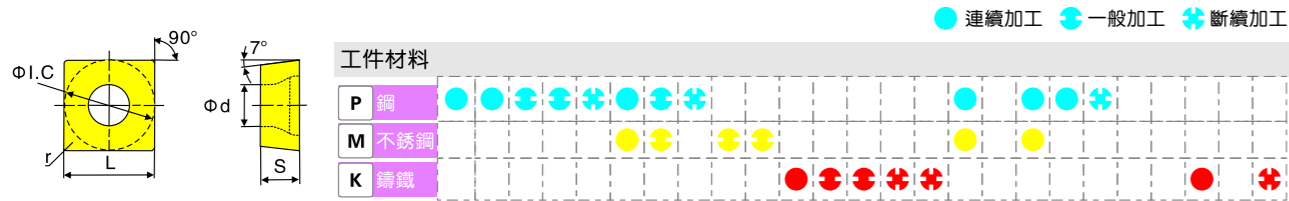

刀片外形 Charp	型號 Specification	塗層硬質合金 Carbidecoatwg										金屬陶瓷		硬質合金 Carbide															
		TBC1015	TBC1025	TBC2015	TBC2025	TBC3015	TBM2015	TBM3015	TBM5025	TBD1015	TBD1025	TBD2025	TBD3025	TBG1025	TBG2025	TBX1035	TBX2035	TBX3035	T10	TP10	P01	P03	K01	K25	M25	M3501			
精加工 半精加工 For finishing For semi-finishing	SCMT09T304-TF	★	○				★	○		★	○						★	★											
	SCMT09T308-TF	★	○				★	○		★	○						★	★											
	SCMT09T312-TF		★	★	○		★	○			★	○					★												
	SCMT120404-TF	★	○				★	○		★	○						★	★											
	SCMT120408-TF	★	○				★	○		★	○						★	★											
通用槽 All round	SCMT120412-TF		★	★	○		★	○		★	○					★													
	SCMT09T304-M	★	○				★	○		★	○					★	★												
	SCMT09T308-M	★	○				★	○		★	○					★	★												
	SCMT09T312-M		★	★	○		★	○			★	○					★												
	SCMT120404-M	★	○				★	○		★	○					★	★												
通用槽 All round	SCMT120408-M	★	○				★	○		★	○					★	★												
	SCMT120412-M		★	★	○		★	○		★	○					★													
	SCMT09T304-TM	★	○				★	○		★	○					★	★												
	SCMT09T308-TM	★	○				★	○		★	○					★	★												
	SCMT09T312-TM		★	★	○		★	○			★	○					★												
無槽 without chipbreaker	SCMT120404-TM	★	○				★	○		★	○					★	★												
	SCMT120408-TM	★	○				★	○		★	○					★	★												
	SCMT120412-TM		★	★	○		★	○		★	○					★													
	SCGW060204		★	★	○		★	○		★	○					★													
	SCGW060208		★	★	○		★	○		★	○					★													

★ 主推牌號 ○ 通用牌號

WC□□ (正角型)

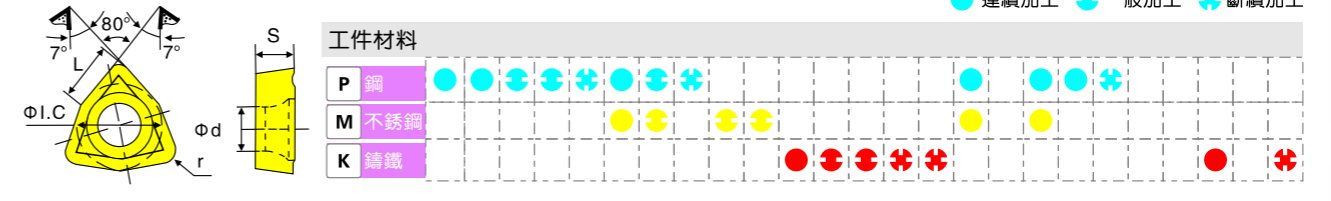

刀片外形 Charp	型號 Specification	塗層硬質合金 Carbidecoatwg										金屬陶瓷		硬質合金 Carbide													
		TBC1015	TBC1025	TBC2015	TBC2025	TBC3015	TBM2015	TBM3015	TBM5025	TBD1015	TBD1025	TBD2025	TBD3025	TBG1025	TBG2025	TBX1035	TBX2035	TBX3035	T10	TP10	P01	P03	K01	K25	M25	M3501	
精加工 半精加工 For finishing For semi-finishing	WCMX030208R-53	★	○				★	○			★	○					★										
	WCMX040208R-53	★	○				★	○			★	○					★										
	WCMX050308R-53	★	○				★	○			★	○					★										
	WCMX06T308R-53	★	○				★	○			★	○					★										
	WCMX080412R-53	★	○				★	○			★	○					★										

★ 主推牌號 ○ 通用牌號

For Al machining 鋁加工用刀片

VCGT系列

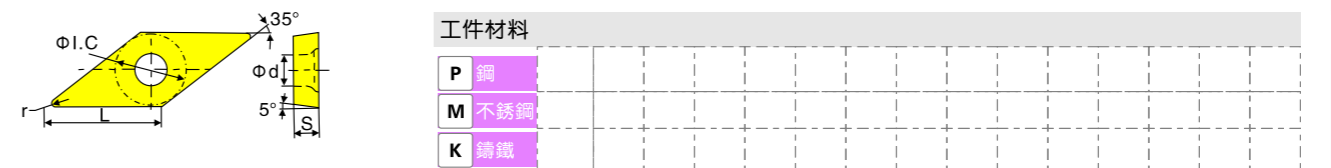

刀片外形 Charp	型號 Specification	CVD塗層					PVD塗層				金屬陶瓷		硬質合金 Carbide			
		TBC5015	TBM3015	TBM5025	TBD2025	TBD3025	TBX1035	TBX2035	TBX3035	TBG1025	T10	TP10	P03	M01	K01	K25
半精加工 For semi-finishing	VCGT11T302															★
	VCGT11T304															★
	VCGT160404															★
	VCGT160404															★

★ 主推牌號 ○ 通用牌號

U 鑽系列
high speed drills
Indexable inserts

鏜刀系列
Boring Head

刀柄系列
Chuck

銑刀系列
Milling System

頂尖系列
Centre

車刀系列
Turning Tools

合金系列
Carbide insert

非標定做
Customized Products

U 鑽系列
high speed drills
Indexable inserts

鏜刀系列
Boring Head

刀柄系列
Chuck

銑刀系列
Milling System

頂尖系列
Centre

車刀系列
Turning Tools

合金系列
Carbide insert

非標定做
Customized Products

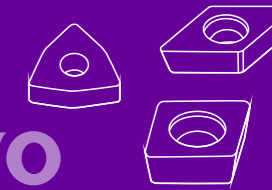

AP□□

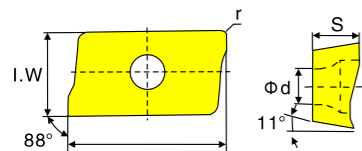

● 連續加工 ● 一般加工 ✚ 斷續加工

工件材料	
P	鋼
M	不銹鋼
K	鑄鐵

刀片外形 Charp	型號 Specification	CVD塗層					PVD塗層				金屬 陶瓷		硬質合金 Carbide			
		TBC5015	TBM3015	TBM5025	TBD2025	TBD3025	TBX1035	TBX2035	TBX3035	TBG1025	T10	TP10	P03	M01	K01	K25
	APKT11T304-PF	★	★	○	★	○	○	★	○	○						
	APKT11T308-PF	★	★	○	★	○	○	★	○							
	APKT11T312-PF	★	★	○	★	○	○	★	○							
	APKT11T316-PF	★	★	○	★	○	○	★	○							
	APKT160408-PF	★	★	○	★	○	○	★	○							
	APKT11T304-PM	★	★	○	★	○	○	★	○							
	APKT11T308-PM	★	★	○	★	○	○	★	○							
	APKT11T312-PM	★	★	○	★	○	○	★	○							
	APKT160408-PM	★	★	○	★	○	○	★	○							
	APKT11T304-PR	★	★	○	★	○	○	★	○							
	APKT11T308-PR	★	★	○	★	○	○	★	○							
	APKT11T312-PR	★	★	○	★	○	○	★	○							
	APKT160408-PR	★	★	○	★	○	○	★	○							
	APKT11T304-LH	★	★	○	★	○	○	★	○							
	APKT11T308-LH	★	★	○	★	○	○	★	○							
	APKT160408-LH	★	★	○	★	○	○	★	○							

★ 主推牌號 ○ 通用牌號

AP□□

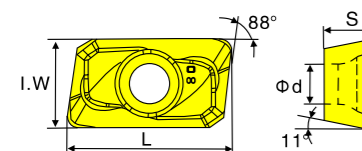

● 連續加工 ● 一般加工 ✚ 斷續加工

工件材料	
P	鋼
M	不銹鋼
K	鑄鐵

刀片外形 Charp	型號 Specification	CVD塗層					PVD塗層				金屬 陶瓷		硬質合金 Carbide			
		TBC5015	TBM3015	TBM5025	TBD2025	TBD3025	TBX1035	TBX2035	TBX3035	TBG1025	T10	TP10	P03	M01	K01	K25
	APMT1135-M2	★	★	○	★	○	○	★	○							
	APMT1604-M2	★	★	○	★	○	○	★	○							
	APMT1135-H2	★	★	○	★	○	○	★	○							
	APMT1604-H2	★	★	○	★	○	○	★	○							

★ 主推牌號 ○ 通用牌號

RC□□

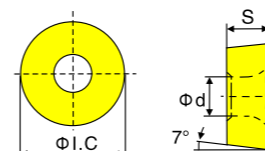

● 連續加工 ● 一般加工 ✚ 斷續加工

工件材料	
P	鋼
M	不銹鋼
K	鑄鐵

刀片外形 Charp	型號 Specification	CVD塗層					PVD塗層				金屬 陶瓷		硬質合金 Carbide			
		TBC5015	TBM3015	TBM5025	TBD2025	TBD3025	TBX1035	TBX2035	TBX3035	TBG1025	T10	TP10	P03	M01	K01	K25
	RCKT10T3MO-ST	★	★	○	★	○	○	★	○							
	RCKT1204MO-ST	★	★	○	★	○	○	★	○							
	RCKT2006MO-ST	★	★	○	★	○	○	★	○							
	RCMT10T3MO-TV	★	★	○	★	○	○	★	○							
	RCMT1204MO-TV	★	★	○	★	○	○	★	○							
	RCMT1606MO-TV	★	★	○	★	○	○	★	○							
	RCMX1204MO-TH	★	★	○	★	○	○	★	○							
	RCMX1606MO-TH	★	★	○	★	○	○	★	○							
	RCMX2006MO-TH	★	★	○	★	○	○	★	○							
	RCMT1204MO-TH	★	★	○	★	○	○	★	○							
	RCMT1606MO-TH	★	★	○	★	○	○	★	○							
	RCMT2006MO-TH	★	★	○	★	○	○	★	○							

★ 主推牌號 ○ 通用牌號

RP□□

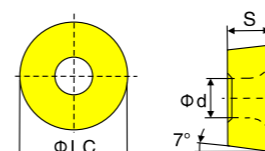

● 連續加工 ● 一般加工 ✚ 斷續加工

工件材料	
P	鋼
M	不銹鋼
K	鑄鐵

刀片外形 Charp	型號 Specification	CVD塗層					PVD塗層				金屬 陶瓷		硬質合金 Carbide			
		TBC5015	TBM3015	TBM5025	TBD2025	TBD3025	TBX1035	TBX2035	TBX3035	TBG1025	T10	TP10	P03	M01	K01	K25
	RPMT08T2MO-SL	★	★	○	★	○	○	★	○							
	RPMT10T3MO-SL	★	★	○	★	○	○	★	○							
	RPMT1204MO-SL	★	★	○	★	○	○	★	○							
	RPMT1606MO-SL	★	★	○	★	○	○	★	○							
	RPMT2006MO-SL	★	★	○	★	○	○	★	○							
	RPMW080200	★	★	○	★	○	○	★	○							
	RPMW100300	★	★	○	★	○	○	★	○							
	RPMW120400	★	★	○	★	○	○	★	○							
	RPMW160600	★	★	○	★	○	○	★	○							
	RPMW200600	★	★	○	★	○	○	★	○							

★ 主推牌號 ○ 通用牌號

U 鑽系列
high speed drills
Indexable inserts

鏜刀系列
Boring Head

刀柄系列
Chuck

銑刀系列
Milling System

頂尖系列
Centre

車刀系列
Turning Tools

合金系列
Carbide insert

非標定做
Customized Products

U 鑽系列
high speed drills
Indexable inserts

鏜刀系列
Boring Head

刀柄系列
Chuck

銑刀系列
Milling System

頂尖系列
Centre

車刀系列
Turning Tools

合金系列
Carbide insert

非標定做
Customized Products

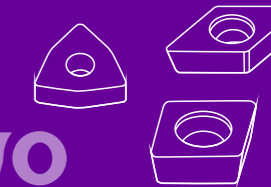

SP□□

● 連續加工 ● 一般加工 ● 斷續加工

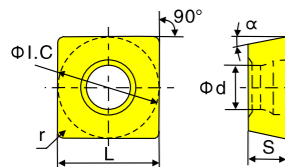

工件材料	
P	鋼
M	不銹鋼
K	鑄鐵

刀片外形 Charp	型號 Specification	CVD塗層				PVD塗層				金屬 陶瓷		硬質合金 Carbide			
		TBC5015	TBM3015	TBM5025	TBD2025	TBD3025	TBX1035	TBX2035	TBX3035	TBG1025	T10	TP10	P03	M01	K01
	SPMT060304	★	★	○	★	○	○	★	○	★		○	○	★	★
	SPMT120408	★	★	○	★	○	○	★	○	★		○	○	★	★
	SPMT120408-PM	★	★	○	★	○	○	★	○	★		○	○	★	★
	SPMT120408-KM	★	★	○	★	○	○	★	○	★		○	○	★	★
	SPMT1204EDR	★	★	○	★	○	○	★	○	★		○	○	★	★

★ 主推牌號 ○ 通用牌號

SP□W

● 連續加工 ● 一般加工 ● 斷續加工

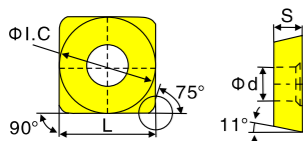

工件材料	
P	鋼
M	不銹鋼
K	鑄鐵

刀片外形 Charp	型號 Specification	CVD塗層				PVD塗層				金屬 陶瓷		硬質合金 Carbide			
		TBC5015	TBM3015	TBM5025	TBD2025	TBD3025	TBX1035	TBX2035	TBX3035	TBG1025	T10	TP10	P03	M01	K01
	SPKW1204EDFR	★	★	○	★	○	○	★	○	★		○	○	★	★
	SPKW1204EDSR	★	★	○	★	○	○	★	○	★		○	○	★	★

★ 主推牌號 ○ 通用牌號

通用公式

Vc: 切削速度 (m/min)
Dc: 銑刀公稱直徑 (mm)
n: 主軸轉速 (rev/min)
Zn: 刃數
Q: 金屬去除率 (cm³/min)

Vf: 工作台進給量 (進給速度) (mm/min)
Fz: 每齒進給量 (mm/Z)
π: 圓周率=3.14
Tc: 加工時間 (min)
: 每轉進給量 (mm/rev)

◎ 切削速度

$$Vc = \frac{\pi \times Dc \times n}{1000} \text{ (m/min)}$$

◎ 主軸轉速

$$n = \frac{1000Vc}{\pi \times Dc} \text{ (Rev/min)}$$

◎ 工作臺進給量 (進給速度)

$$Vf = fz \times n \times Zn \text{ (mm/min)}$$

◎ 每齒進給量

$$Fz = \frac{Vf}{n \times Zn} \text{ (mm/z)}$$

◎ 每轉進給量

$$Zn = \frac{Vf}{n} \text{ (mm/rev)}$$

◎ 加工時間

$$Tc = \frac{1000Vc}{\pi \times Dc} \text{ (min)}$$

◎ 金屬去除率

$$Q = \frac{ap \times ae \times Vf}{1000} \text{ (cm}^3\text{/min)}$$

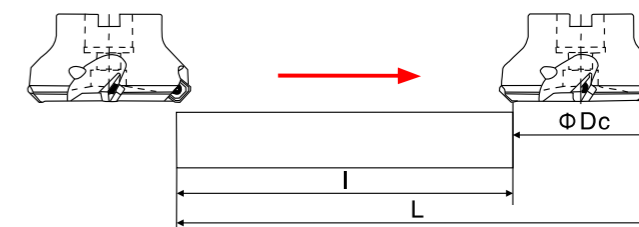
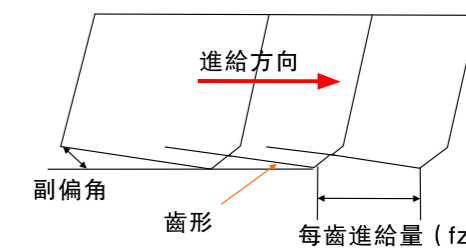
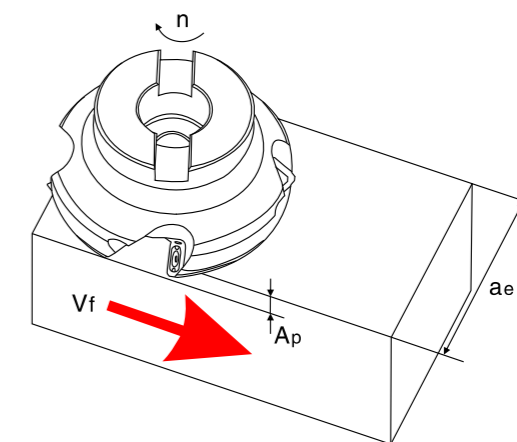

U 鑽系列
high speed drills
Indexable inserts

鏜刀系列
Boring Head

刀柄系列
Chuck

銑刀系列
Milling System

頂尖系列
Centre

車刀系列
Turning Tools

合金系列
Carbide insert

非標定做
Customized Products

U 鑽系列
high speed drills
Indexable inserts

鏜刀系列
Boring Head

刀柄系列
Chuck

銑刀系列
Milling System

頂尖系列
Centre

車刀系列
Turning Tools

合金系列
Carbide insert

非標定做
Customized Products



銑削刀具各部分的作用

平面銑刀主要角度標注

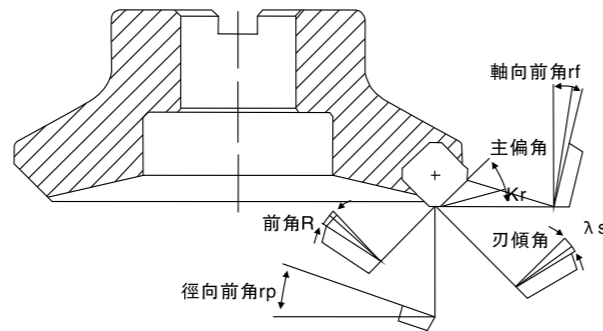

◎平面銑刀主要角度標注

名稱	作用	效果
軸向前角rf	決定排屑方向	角度為負：排屑性能好
徑向前角rp	決定切削輕快與否	角度為正：切削性能好
主偏角Kr	決定切削厚度	$Kr \uparrow$, 切削厚度 \uparrow ; $Kr \downarrow$; 切屑厚度 \downarrow ;
前角R	決定切削輕快與否	切削性能差切削刃强度高 (-) \leftarrow 0 \rightarrow (+) 切削性能好切削刃強度低
刃傾角 λs	決定排屑方向	排屑性能差切削刃强度高 (-) \leftarrow 0 \rightarrow (+) 排屑性能好切削刃強度低

◎不同前角的組合特徵

		雙正前角	雙負前角	一正一負前角
負型前角				
零度前角				
正型前角				
軸向前角rf		+	-	+
徑向前角rp		+	-	-
適合加工材料	P	✓		✓
	M	✓		✓
	K		✓	✓
	N	✓		✓
	S	✓		✓

不同主偏角的切削性能

主偏角	示意圖	說明
45		軸向分力最大。加工薄壁零件時，工件發生扭曲，導致加工工件的精度下降；加工鑄鐵時，有利於防止工件邊緣產生崩落。
75		主要的為徑向切削分力，是平面銑削最常用的一種主偏角。
90		理論上軸向分力為零，適合於薄板件的銑削。

修光刃刀片

由於刀體和刀片存在製造誤差，所以，刀具存在端刃的端面圓跳動和圓周刃的徑向圓跳動，端刃的端面圓跳動將導致已加工表面粗糙度Ra值升高，使表面質量達不到要求。

解決方法

安裝修光刃刀片

用法

在端向上修光刃必須比其它刃高0.03-0.10mm，才能起到修光作用。一般來說一個刀盤裝一片修光刃即可，當刀盤直徑比較大時或刀盤的每轉進給量大于修光刃長度時，可裝2-3片修光刃

面銑中切寬與刀具切削直徑的選擇

一般來說，切削寬度與刀具的切削直徑與切寬的關係為： $Dc = (1.2-1.5) ae$ 。
在實際加工中盡量避免刀具中心與工件中心相重合。

Dc : 刀具切削直徑
 ae : 切削寬度

U 鑽系列
high speed drills
Indexable inserts

鏜刀系列
Boring Head

刀柄系列
Chuck

銑刀系列
Milling System

頂尖系列
Centre

車刀系列
Turning Tools

合金系列
Carbide insert

非標定做
Customized Products

U 鑽系列
high speed drills
Indexable inserts

鏜刀系列
Boring Head

刀柄系列
Chuck

銑刀系列
Milling System

頂尖系列
Centre

車刀系列
Turning Tools

合金系列
Carbide insert

非標定做
Customized Products

Customized Products

非標定做



非標組合鏢刀-汽摩行業



非標組合鏢刀-汽摩行業



非標組合鏢刀-小刀夾



非標鏢刀-反鏢刀

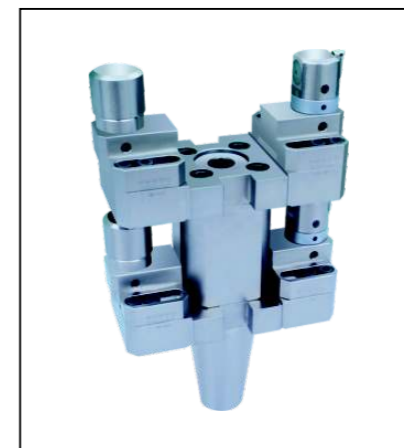

非標組合精鏢刀(橋式)



SK刀柄(CKB接口)

YOUNJO
TOOLS

